

CERTIFIED LAND CORNER RESTORATION

Index No. **F-2**

State of Wisconsin

County of Oneida } ss.

I Phillip T. Hansen, do hereby certify that on the 17th day of November, 19 75, I found evidence of the NW-1/16 corner of Section 7 Township 36 North, Range 11 East, Fourth Principal Meridian, as described hereon; and that from this evidence I established a new monument and accessories as described hereon to perpetuate the original location of this corner.

Resident witnesses:

Glen Barker

Jim Claflin

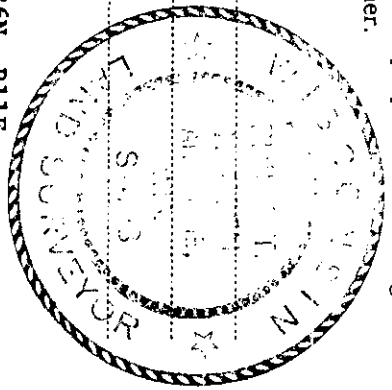

T36N, R11E

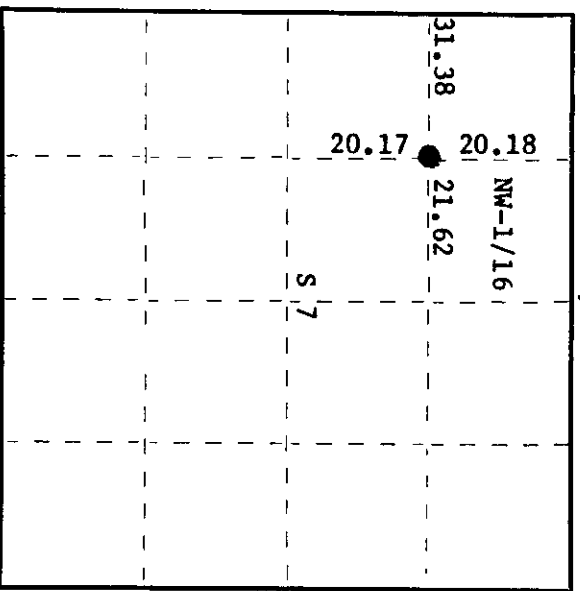

○ = Corner monument restored.

History of original corner establishment:

Corner established by H.C. Lawrence, Registered Surveyor, in 1950. He ran the E-W 1/4 line of NW 1/4. 1/4 from previously established NC-1/16, 53.00 chains S89°30'W to the N-1/16 corner on range line, intersected 120 lks. South. Also ran the N-S 1/4 line of NW 1/4 from the W-1/16, which he had set proportional between the N-1/4 corner and the NW corner, S30°30'W and at 40.35 chains intersected the random E-W 1/4 line at 61 lks. West of 20.97 West of C-1/4 corner. Set 5" white pine post at 30-1/2 lks. East of 20.18 chains South and marked bearing trees W. pine 16", S43°E, 71 lks. and W. pine 12", S80°E, 34-1/2 lks. This corner is 21.62 chains West of NC-1/4, 31.38 chains East of N-1/16 on range line, 20.18 chains South of W-1/16 and 20.17 chains North of WC-1/16.

Recovered Lawrence's 5" pine post, squared and scribed NW-1/16 S7, NW-1/16 S7 in poor condition.

Recovered OBT's - W. pine 12" (14") S80°E 34.5 lks. scribing grown over  
 W. pine 16" (18") S43°E 71 lks. scribed NW-1/16, bottom scribe grown over

Description of monument and accessories I established to perpetuate the original location of this corner.

Replace 5" white pine post with 1" O.D. iron pipe with 2" brass cap stamped - S498  
 Pipe projects 18" above ground. T36N, R11E  
 No additional accessories.  
 Pipe and BT's painted blue.

NW-1/16 S7  
 CPI-1975

Dated at Rhineclander, Wis. this 29th day of November, 1975.

Signature: Phillip T. Hansen Title: Registered Land Surveyor Registration No. S-498  
 (County Surveyor, Registered Land Surveyor, or other duly authorized official)  
 Office of Register of Deeds, County of Oneida  
 at 1:30 o'clock P. M. 4th day of November, 1975  
 I hereby certify that the within instrument was filed in this office for record on the 4th day of November, 1975.

By: Thomas M. Bishop Deputy  
 (Register of Deeds)