

CERTIFIED LAND CORNER RESTORATION

Index No. F-21

State of Wisconsin }
County of Oneida } ss.

I Philip T. Hansen, do hereby certify that on the 31st day of December, 1974, I found evidence of the N-1/16 corner of Sec. 11 and 12 Township 36 North, Range 11 East, Fourth Principal Meridian, as described hereon; and that from this evidence I established a new monument and accessories as described hereon to perpetuate the original location of this corner.

Resident witnesses:

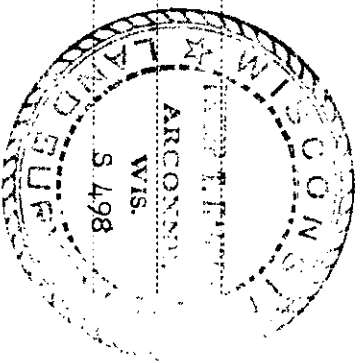

History of original corner establishment:
Corner established by H.C. Lawrence, Reg. Land Surveyor on his retracement survey of 1952. From B.F. Dorr's corner of Sec. 1-2-11-12, which he claimed was set from the original notes. Lawrence ran due South 35.67 chains to a point 3.80 chains due East to Dorr's 1/4 corner. S-1/16 Corner set on true line between section corner and 1/4 corner equidistant between them at 17.83 1/2 chains. Bearing of true line S60°05'E. No record of BT's established.

Description of corner evidence found:
Recovered H.C. Lawrence's 4" cedar post, squared and scribed S11 N-1/16; S12 N-1/16 in good condition.

Description of monument and accessories I established to perpetuate the original location of this corner.

Set new 1" x 5' galvanized iron pipe with brass cap stamped as follows -
New BT Black cherry 7" N22E 30 lks. scribed 1/16 BT T36N, R11E S498

S11-S12
N-1/16
CPI-1974

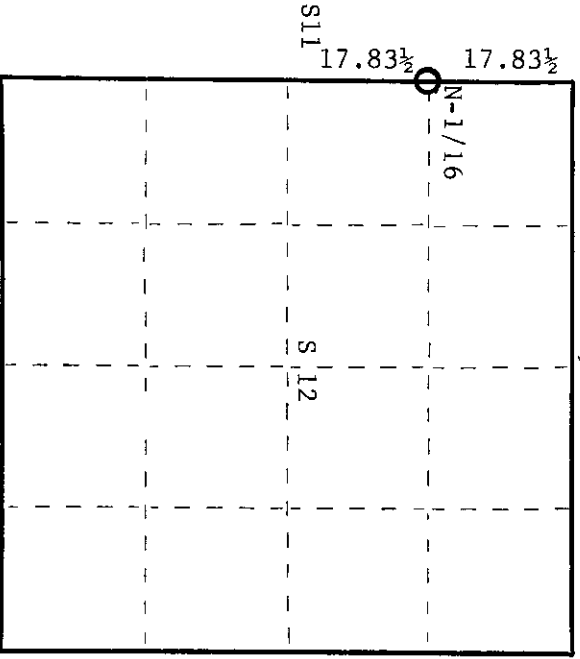

○ = Corner monument restored.

Dated at Rhinelander, Wis., this 16th day of June, 1975.

Signature: *Philip T. Hansen* Title: Registered Land Surveyor Registration No. S-498
(County Surveyor, Registered Land Surveyor, or other duly authorized official)

Office of Register of Deeds, County of Oneida
Instrument was filed in this office for record on the 1st day of October, 1975 at 3:00 o'clock P.M.

Dona Savage Tuck
(Register of Deeds)

By: _____ Deputy

00000000000000000000