

CERTIFIED LAND CORNER RESTORATION

Index No. M-13

State of Wisconsin }
County of Oneida } ss.

I, Phillip T. Hansen, do hereby certify that on the 5th day ~~of~~ established March, 1980, I ~~found~~ ~~recovered~~ the S 1/16 corner of Sections 15 and 16 Township 36, North, Range 11 East, Fourth Principal Meridian,

as described hereon; and that from this evidence I established a new monument and accessories as described hereon to perpetuate the original location of this corner.

Resident witnesses:

Glen Barker
Jim Clafflin
Herb Wagoner

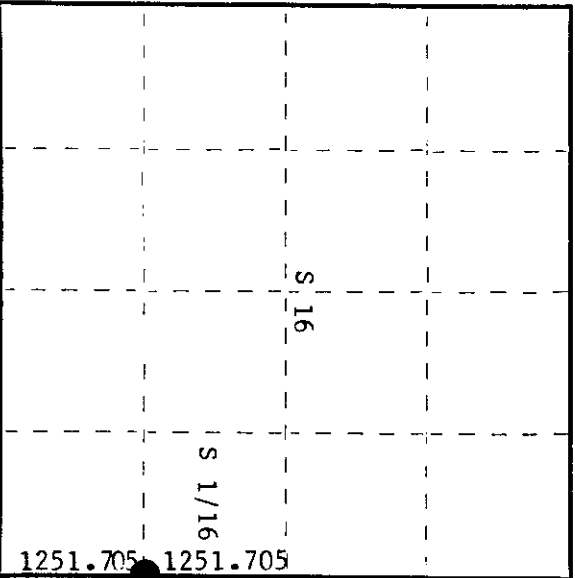
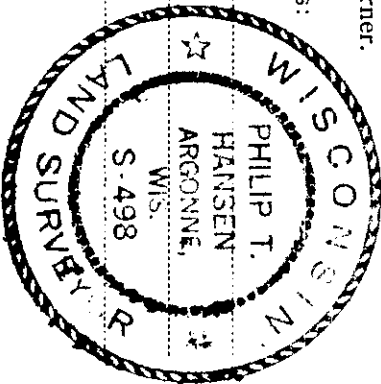

History of original corner establishment:
H.C. Lawrence, Registered Land Surveyor, ran line in 1952. Found no evidence of any corner and no mention of any corner set.

Description of corner evidence found:

No evidence of any corner recovered.
Corner established by traverse and computation. Ran traverse from previously recovered 1/4 corner to section corner 15, 16, 21 and 22. Computed bearing and distance found to be S 0° 32' E, 2503.510 feet. Set S 1/16 at 1251.705 feet intermediate.

Description of monument and accessories I established to perpetuate the original location of this corner.

Set a 1-1/2" iron pipe with 2" brass cap, projecting 24", stamped:
Marked NBT's -
W. Birch 6" S48°W 35.75 feet, scribed 1/16 BT.
Balsam 6" N38°W 29.95 feet, scribed 1/16 BT.

S498
T36N R11E
S 1/16 S11 + S15
GPI-1980

Dated at Rhineland Wis. this 19th day of May, 1980

Signature: Phillip T. Hansen Title: Registered Land Surveyor Registration No. S-498
(County Surveyor, Registered Land Surveyor, or other duly authorized official)

Office of Register of Deeds, County of Oneida
Instrument was filed in this office for record on the 5th day of June, 1980
at 1:30 o'clock P.M.

Donna Verage Kuehn
(Register of Deeds)

By: _____ Deputy

3611161000

CERTIFIED LAND CORNER RESTORATION

Index No. M-13

State of Wisconsin

County of Oneida } ss.

I, Phillip T. Hansen, do hereby certify that on the 5th day of March, 1980, I found ~~restored~~ established the S 1/16 corner of Sections 15 and 16 Township 36, North, Range 11 East, Fourth Principal Meridian, as described hereon; and that from this evidence I established a new monument and accessories as described hereon to perpetuate the original location of this corner.

Resident witnesses:
Glen Barker
Jim Claflin
Herb Wagoner

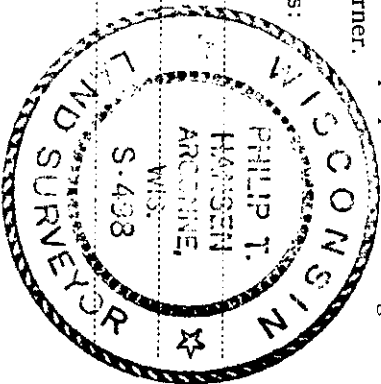

History of original corner establishment:
No records of any previous survey.

Description of corner evidence found:

No evidence of any corner recovered.

Corner established by traverse and computation. Computed distance between 1/4 corner, sections 15 and 16, and section corner 15, 16, 21 and 22 is 2502.410 feet at bearing S 0° 32' E.
Established S 1/16 corner at 1251.705 feet intermediate.

Description of monument and accessories I established to perpetuate the original location of this corner.

Set a 1-1/2" iron pipe with 2" brass cap, projecting 24" - stamped:

Marked NBT's -
W. Birch 6" S48°W 35.75 feet
Balsam 6" N38°W 29.95 feet
both scribed 1/16 BT.

S498
T36N R11E
S 1/16 16-15
CPI-1980

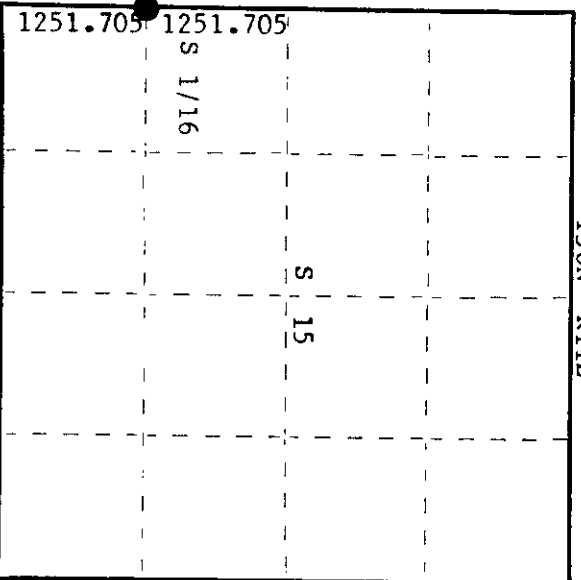

○ = Corner monument restored.

Dated at Rhineland, Wis., this 27th day of March, 1980.

Signature: Phillip T. Hansen Title: Registered Land Surveyor Registration No. S-498
(County Surveyor, Registered Land Surveyor, or other duly authorized official)

Office of Register of Deeds, County of Oneida, I hereby certify that the within instrument was filed in this office for record on the 16th day of May, 1980 at 11:10 o'clock A.M.

By: Donna Savage Fisher (Register of Deeds)

By: _____ Deputy