

CERTIFIED LAND CORNER RESTORATION

Index No. **P-9**

State of Wisconsin

County of Oneida } ss.

I Philip T. Hansen do hereby certify that on the 12th day of August, 1975, I found evidence of the Quarter corner of Sections 20 and 21 Township 36 North, Range 11 East, Fourth Principal Meridian, as described hereon; and that from this evidence I established a new monument and accessories as described hereon to perpetuate the original location of this corner.

Resident witnesses:

Glen Barker
Jim Claflin

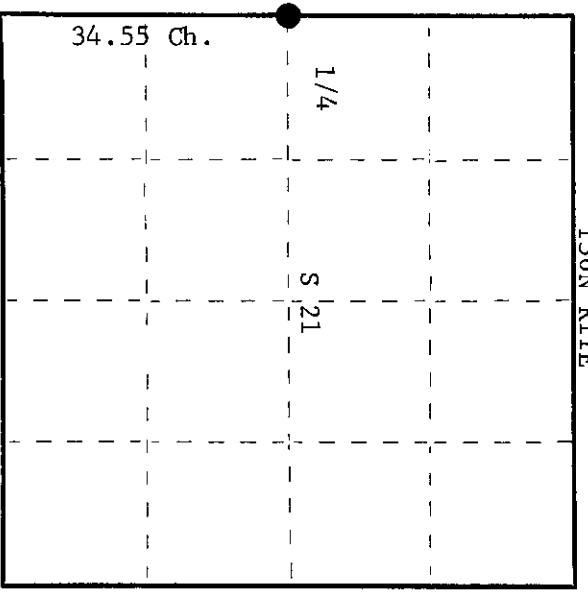
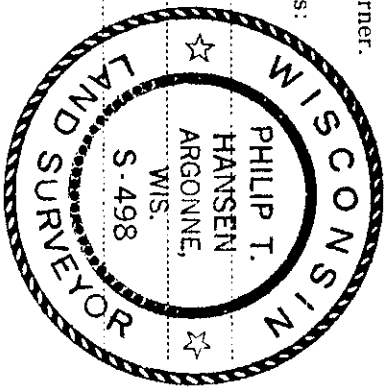

O = Corner monument restored.

History of original corner establishment:

Original corner established by Wm. E. Dougherty, Government Deputy Surveyor, in 1859 from which spruce 10" bears S82°E, 28 links and cedar 12" bears N52°W, 11 links. Corner re-established by Norman Loftus, St. Regis Paper Company, Registered Surveyor. Set 2" iron pipe with 3" square brass cap. No Br's available. Corner recovered by H.C. Lawrence, Registered Land Surveyor. Corner is 34.55 chains north of Section Corner S20, 21, 28, and 29.

Description of corner evidence found:

Recovered 2" iron pipe w/3" squared brass cap stamped -

Also an old cedar point buried in the muck beside the iron pipe.

1/4
S20 | S21
T36N R11E
R1PCO

Description of monument and accessories I established to perpetuate the original location of this corner.

As the corner stake was in good condition but appeared loose, two support stakes were driven in beside it to make it more stable. This corner sits in an open marsh with no trees available for Br. Two 1-1/2" OD iron pipes w/2" brass caps were set for witness marks. 1 - stamped W.C. S30 links, 2 - W.C. E40 links.

Dated at Rhinelander, Wis., this 5th day of September, 1975.

Signature: *Philip T. Hansen* Title: Registered Land Surveyor Registration No. S-498
(County Surveyor, Registered Land Surveyor, or other duly authorized official)

Office of Register of Deeds, County of Oneida
Instrument was filed in this office for record on the 14th day of October, 1975
at 2:00 o'clock P.M.

Signature: *Doris Savage Fisher*
(Register of Deeds)

By: Deputy

3611202000