

CERTIFIED LAND CORNER RESTORATION

Index No. **0-9**

State of Wisconsin

County of Oneida } ss.

I Phillip T. Hansen, do hereby certify that on the 19th day of January, 1979, I found evidence of the N 1/16 corner of Section 20 - 21 Township 36, North, Range 11 East, Fourth Principal Meridian, as described hereon; and that from this evidence I established a new monument and accessories as described hereon to perpetuate the original location of this corner.

Resident witnesses:

Jim Clafflin
Herb Wagoner

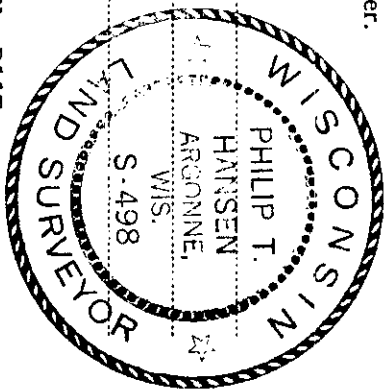

T36N R11E

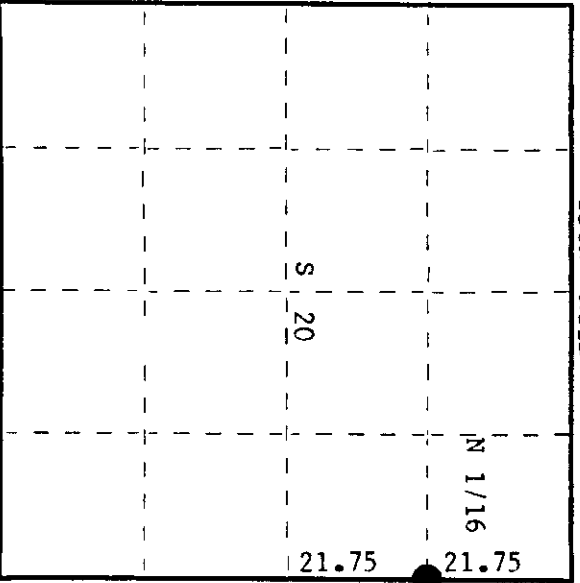

○ = Corner monument restored.

CERTIFIED LAND CORNER RESTORATION

History of original corner establishment:

Corner established by N. Loftus, Ripco Surveyor.
Ran random line north, bearing $356^{\circ} 39'$ from E $1/4$ corner, 43.51 chains to close out 83 links west of section corner.
Established N $1/16$ corner at 21.75 $\frac{1}{2}$ chains intermediate. Correct bearing N $2^{\circ} 54'$ W.
Marked NBT's -
W. Spruce 11" S70 $^{\circ}$ W 68 links
Balsam 6" N78 $^{\circ}$ E 19 $\frac{1}{2}$ links

Description of corner evidence found:

Recovered 3/4" iron pipe with 2" square brass cap in good condition. Monument sets on a large ledge rock and a large rock cairn supports the monument.
Recovered OBT's - Spruce 11" (14") S70 $^{\circ}$ W (S62 $^{\circ}$ W) 68.0 links (68.4 links).
Balsam 6" N78 $^{\circ}$ E 19.5 links (19.0), now dead, scribing partly visible.
Monument projects 3' above ground. Cap stamped:
N 1/16
S20 \perp S21
RIPCO

Description of monument and accessories I established to perpetuate the original location of this corner.
Monument left in place as recovered.
Marked NBT - Maple 5" N22 $^{\circ}$ W 6.1 links, scribed 1/16 BT.

Dated at Rhineland, Wis., this 31st day of January, 1979

Signature Phillip T. Hansen Title Registered Land Surveyor Registration No. S-498
(County Surveyor, Registered Land Surveyor, or other duly authorized official)

Office of Register of Deeds, County of Oneida
Instrument was filed in this office for record on the 14th day of February, 1979
at 1:30 o'clock P. M.

Doris Savage Kuehn
(Register of Deeds)

By: _____ Deputy

3611263000