

CERTIFIED LAND CORNER RESTORATION

Index No. **Q-18**

State of Wisconsin }
 County of Oneida } ss.

I Phillip T. Hansen, do hereby certify that on the 27th day of July, 1976, I found evidence of the SW 1/16 corner of Section 23 Township 36, North, Range 11, east, Fourth Principal Meridian, as described hereon; and that from this evidence I established a new monument and accessories as described hereon to perpetuate the original location of this corner.

Resident witnesses:
Elen Barker
Jim Clafflin
Herb Wagoner

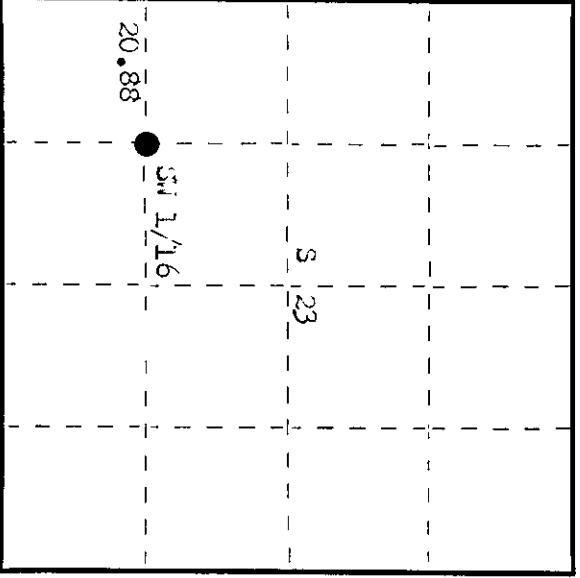
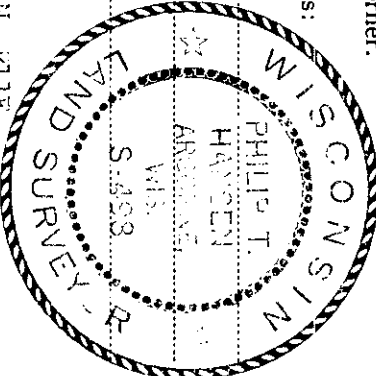

O = Corner monument restored.

History of original corner establishment:

Original corner established by B.F. Dorr, County Surveyor, in 1900. Set corner and marked BT - Hemlock 6" S 46° 17' 1/2 links.
 H.C. Lawrence, registered Land Surveyor, recovered stump of old BT. Set new post and marked WBT's - Hemlock 10" S 42° E 46 links, Hemlock 14" N 27° W 45 links.

Description of corner evidence found:

Recovered 5" hemlock post, squared and scribed SW 1/16 S23, SW 1/16 S23 in good condition.
 Recovered WBT - Hemlock 16" (14") S 42° E 46 links, top scribing grown over. Bottom scribed BT.
 Hemlock 14" N 27° W 45 links, scribed SW 1/16 BT.

Description of monument and accessories I established to perpetuate the original location of this corner.
 Replaced hemlock post with 1 1/2" iron pipe with brass cap stamped.
 Monument projects 44" above ground.
 No additional accessories established.
 Monument and BT's painted blue.

5498
 T36N R11E
 SW 1/16 S23
 CPT-1976

Dated at Rhinelander, Wis., this 23rd day of August, 1976.

Signature Phillip T. Hansen Title Registered Land Surveyor Registration No. 5498
 (County Surveyor, Registered Land Surveyor, or other duly authorized official)

Office of Register of Deeds, County of Oneida. I hereby certify that the within instrument was filed in this office for record on the 27th day of July, 1976 at 2:15 o'clock P. M.

Lois Berge Kuehler
 (Register of Deeds)

By _____ Deputy

3611231030