

CERTIFIED LAND CORNER RESTORATION

Index No. **S-25**

State of Wisconsin }
 County of Oneida } ss.

I Philip T. Hansen do hereby certify that on the 19th day of March, 1976, I found evidence of the N 1/16 corner of Section 25 and 30 Township 36 North, Range 11 and 12 East, Fourth Principal Meridian, as described hereon; and that from this evidence I established a new monument and accessories as described hereon to perpetuate the original location of this corner.

Resident witnesses:
 Glen Barker
 Jim Clafin
 Herb Hagoner

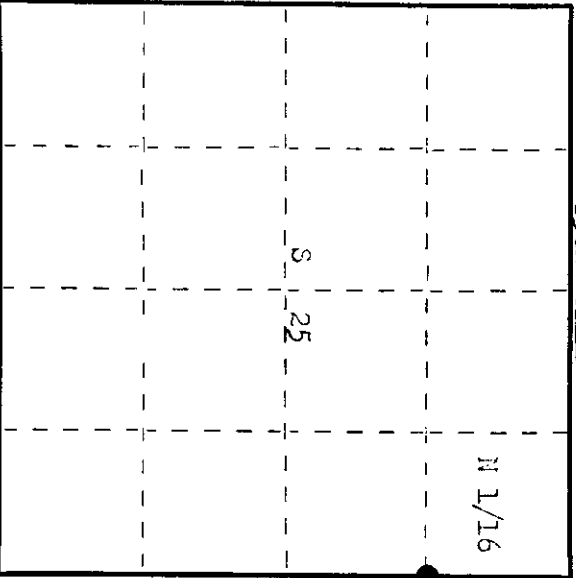
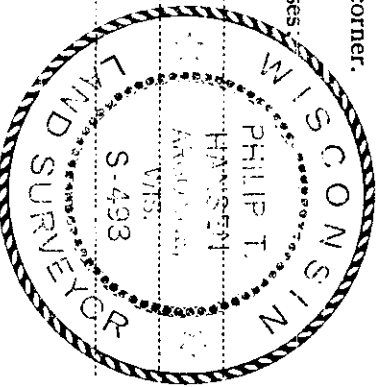

○ = Corner monument restored.

History of original corner establishment:
 Corner established by B. T. Dorr, County Surveyor, in 1899.

H. C. Lawrence, Registered Land Surveyor, recovered Dorr's old post and point in 1954. Set new post, 3" tamarack and marked NBTs, Black spruce 6" N 58° W 21½ lks, and Black Spruce 4" S 88° W 56½ lks.

Description of corner evidence found:

Recovered Lawrence's 3" tamarack post, squared and scribed S 25, N 1/16 & 30 in fair condition.
 Recovered OBT Black Spruce 6" N 58° W 21.5 lks (24 lks) scribed S 25 BT.

Description of monument and accessories I established to perpetuate the original location of this corner.

Replaced 3" tamarack post with 1" OD iron pipe with 2" brass cap, stamped.
 Pipe projects 18" above ground.
 NBT. Black spruce 6" S 61° W 32 lks, scribed 1/16 BT.
 Pipe and BTs painted blue.

S498
 T36N
 R 11 N 1/16
 S 25
 GPT-1976

Dated at Rhinelander, Wis., this 23rd day of March, 1976.

Signature: *Philip T. Hansen* Title: Registered Land Surveyor Registration No. S-498
 County Surveyor, Registered Land Surveyor, or other duly authorized official

Office of Register of Deeds, County of Oneida
 Instrument was filed in this office for record on the 5th day of April, 1976
 at 1:30 o'clock P.M.

Dorcas Tanager Kuehn
 (Register of Deeds)

By: Deputy

8002571192

CERTIFIED LAND CORNER RESTORATION

Index No. S-25

State of Wisconsin

County of Oneida } ss.

I, Philip T. Hansen, do hereby certify that on the 18th day of March, 1976, I found evidence of the N 1/16 corner of Sections 25 and 30 Township 37, North, Range 11 & 12 East, Fourth Principal Meridian, as described hereon; and that from this evidence I established a new monument and accessories as described hereon to perpetuate the original location of this corner.

Resident witnesses:
 Glen Barker
 Jim Clafflin
 Herb Wagoner

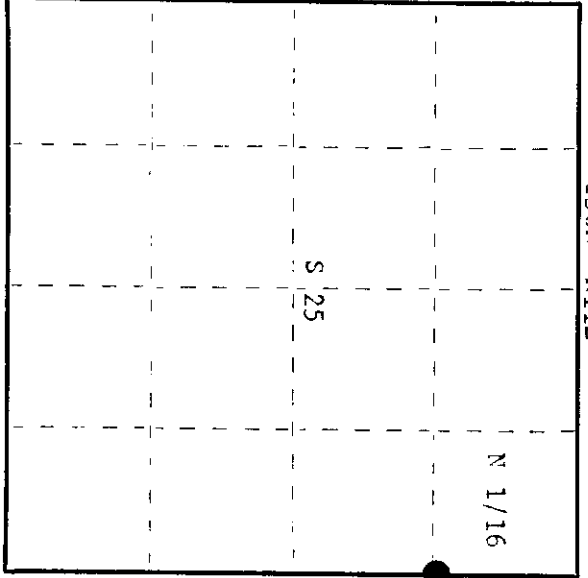
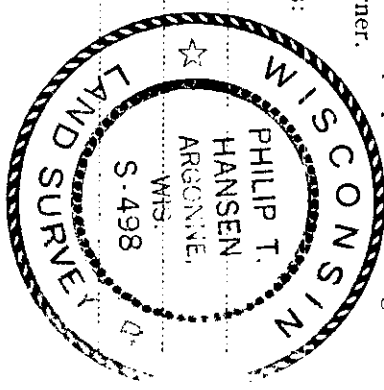

○ = Corner monument restored.

History of original corner establishment:

Corner established by R.F. Dorr, County Surveyor, in 1909.
 H.C. Lawrence, Registered Land Surveyor, recovered an old post and point.
 Set new post and marked NPT's -
 B.Spruce 6" N58°W 21-1/2 links
 B.Spruce 4" S88°E 56-1/2 links

Description of corner evidence found:

Recovered 3" cedar post, squared and scribed S25 T 1/16, S30 R 1/16 in fair condition.
 Recovered CRT - B.Spruce 6" N58°W 21.5 links (?? links) scribed S25 ET.

Description of monument and accessories I established to perpetuate the original location of this corner.

Replaced cedar post with 1" iron pipe with 2" brass cap, stamped:
 Monument projects 18" above ground.
 NPT - B.Spruce 6" S61°W 22 links, scribed 1/16 ET.

S498
 T36N
 R S25 S30 R
 11 12
 E CFI-1976 E

Dated at Rhineland, Wis., this 3rd day of December, 1976.

Signature: Philip T. Hansen Title Registered Land Surveyor Registration No. S-498
 (County Surveyor, Registered Land Surveyor, or other duly authorized official)
 Office of Register of Deeds, County of Oneida
 at 1:30 o'clock P.M. 17th day of December, 1976 hereby certify that the within instrument was filed in this office for record on the 17th day of December, 1976.

By: Doris Therese Kuehn (Register of Deeds)

By: _____ Deputy

00005123000