

CERTIFIED LAND CORNER RESTORATION

Index No. **2-14**

State of Wisconsin } ss.  
 County of Oneida }

I, Philip T. Hansen, do hereby certify that on the 7th day of July, 1975, I found evidence of the corner of Sections 34 and 3 Township 36 and 35 North, Range 11 East, Fourth Principal Meridian, as described hereon; and that from this evidence I established a new monument and accessories as described hereon to perpetuate the original location of this corner.

Resident witnesses.

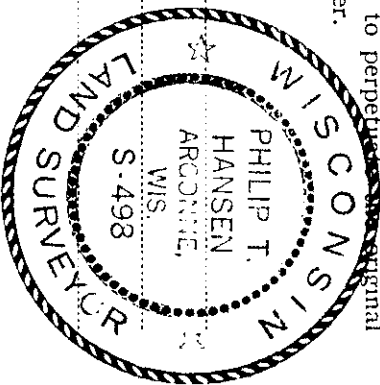

History of original corner establishment:  
 Corner established by H.C. Lawrence, Registered Land Surveyor, in 1954. From established 1/4 corner he ran a random line S85 1/2° W, a distance of 40.96 chains, to a point 4 links North of recovered section corner. Set 5" tamarack post 2 links South at right angles from 20.48 links intermediate. Mentioned oak and hemlock for BT's but gave no bearings or distance.

Description of corner evidence found:  
 Recovered 4" cedar post, squared and scribed W-1/16 S3, W-1/16 S34, in poor condition.  
 Recovered OBT hemlock 13", N43° E, 34.3 links, scribed S34 BT. As the area had been cut over, were not able to find other BT.

Description of monument and accessories I established to perpetuate the original location of this corner  
 Replaced wooden cedar post with 1 1/2" OD iron pipe with brass cap stamped -

NBT - Hemlock 8" S10° W 46.5 links scribed 1/16 BT

W-1/16 S134  
 S134  
 S13

T36N, R11E

S498  
 T36N, R11E

T35N, R11E

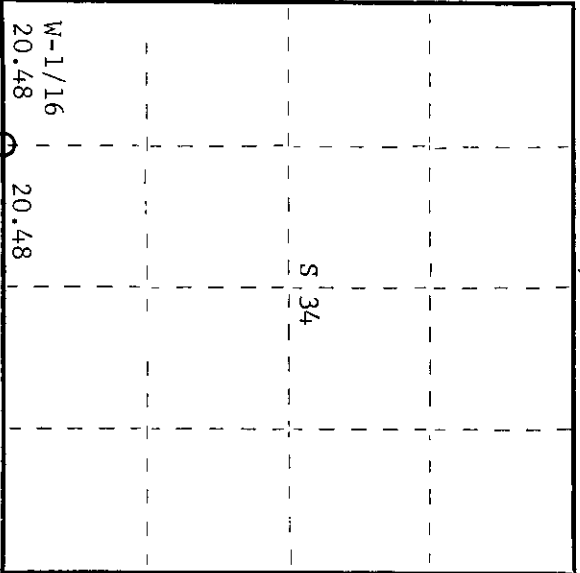

○ = Corner monument restored.

3611340030

Dated at Rhinelander, Wis. this 23rd day of July, 1975.

Signature *Philip T. Hansen* Title Registered Land Surveyor Registration No. S-498  
 (County Surveyor, Registered Land Surveyor, or other duly authorized official)

Office of Register of Deeds, County of Oneida  
 Instrument was filed in this office for record on the 1st day of October, 1975  
 at 3:00 o'clock P.M.

*David George Fisher*  
 (Register of Deeds)

By Deputy