

COUNTY OF VILAS
TOWN OF LAC DU FLAMBEAU
TOWN OF MINOCQUA

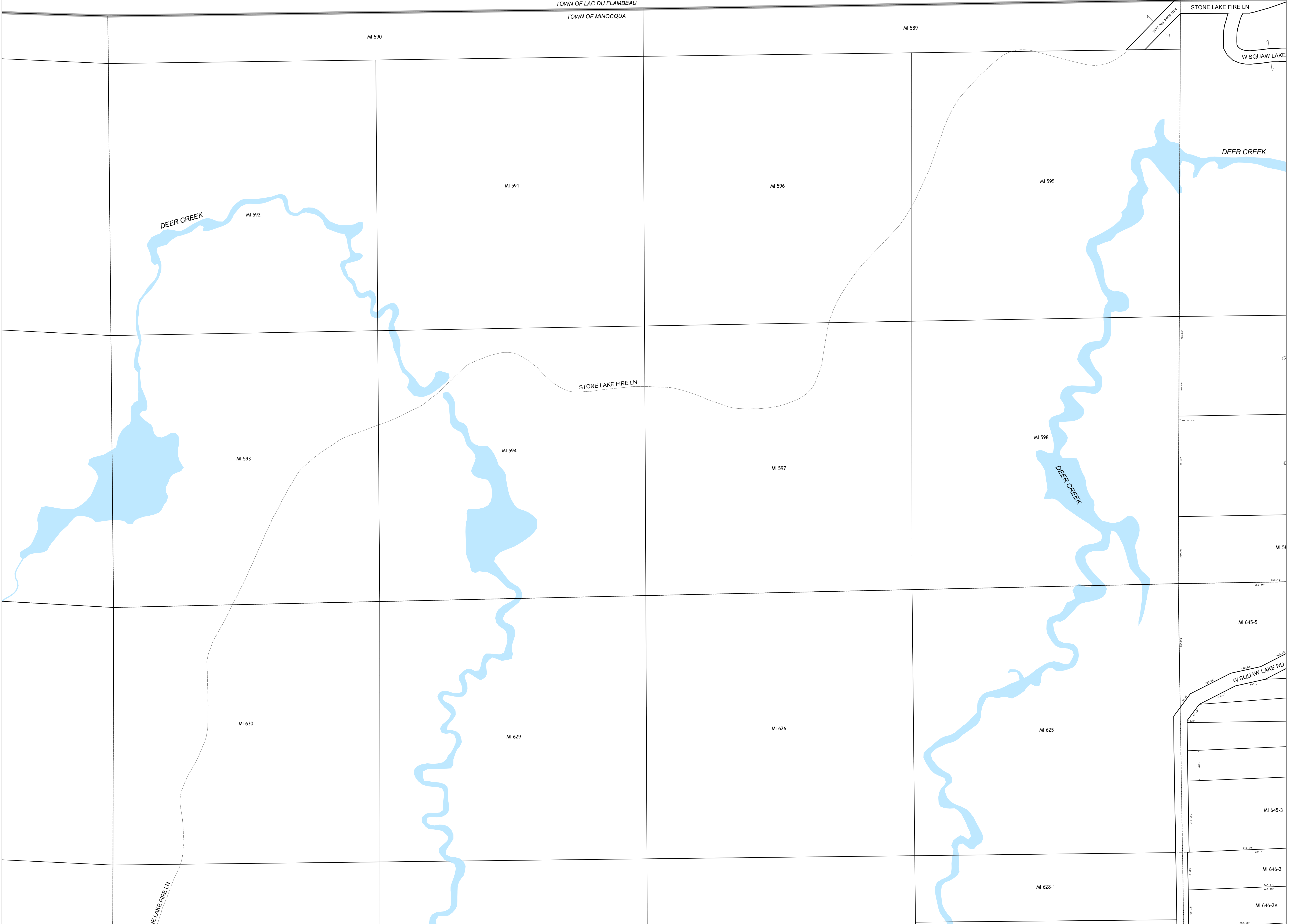

NOTICE

This map is not a survey map of the current parcels and should not be used for conveying real property or guaranteeing title to the properties shown. This map represents a sketch of the parcels listed on the Oneida County tax roll and is intended to aid in the tracking of such parcels. The parcels on this map were mapped from available public records at the time of their creation. These maps may not represent the current parcel location or dimensions of the parcel as it now exists on the ground. Right-of-Ways on this map may not be current and need further research. Gaps and overlaps shown on this map need further research. Refer to original source documents for parcel verification.

The map data hereon is represented "as is" without warranty of any kind, either expressed or implied, or statutory, including, but not limited to, the implied warranties or merchantability and fitness for a particular purpose. The user assumes the entire risk as to the quality and use of the map. No guarantee of accuracy, completeness is granted, nor is any responsibility for reliance thereon assumed. In no event shall Oneida County, its elected or appointed officials or employees be liable for direct, indirect, incidental, consequential or special damages of any kind, including, but not limited to, loss of anticipated profits or benefits arising out of use of or the reliance on the map. Oneida County does not accept liability for any damages or misrepresentation caused by inaccuracies in the data or as a result of the changes to the map data.

Date Created: 2/18/2020

MAPS BASED ON PREVIOUS YEAR TAX ROLL

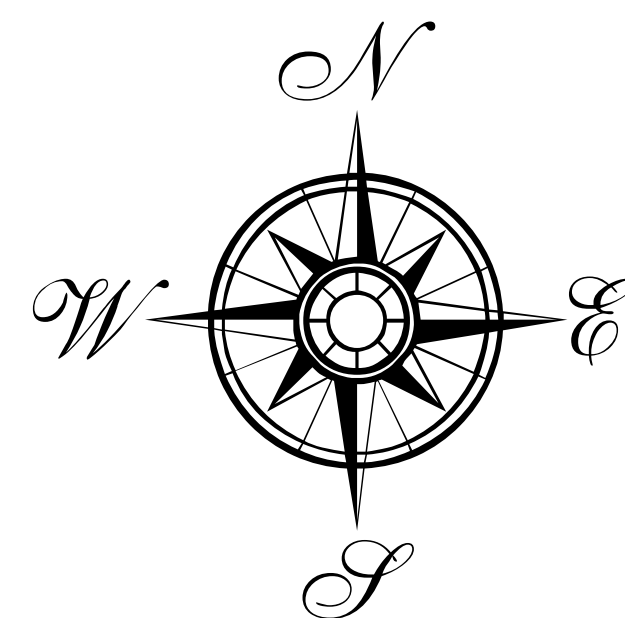

SECTION 05, T39N-R04E

Oneida County Land Information Office
"Where Nature Lingered Longer"
PO Box 400
Rhineland, Wisconsin 54501
Phone: (715) 369-6179
www.co.oneida.wi.us
OneView: <https://gis.oneida.wi.us/oneview>

PREV. YEAR TAX		PREV. YEAR TAX	
MI 590	MI 591	MI 592	MI 593
MI 594	MI 595	MI 596	MI 597
MI 598	MI 599	MI 600	MI 601
MI 602	MI 603	MI 604	MI 605
MI 606	MI 607	MI 608	MI 609
MI 610	MI 611	MI 612	MI 613
MI 614	MI 615	MI 616	MI 617
MI 618	MI 619	MI 620	MI 621
MI 622	MI 623	MI 624	MI 625
MI 626	MI 627	MI 628	MI 629
MI 630	MI 631	MI 632	MI 633
MI 634	MI 635	MI 636	MI 637
MI 638	MI 639	MI 640	MI 641
MI 642	MI 643	MI 644	MI 645
MI 646	MI 647	MI 648	MI 649
MI 650	MI 651	MI 652	MI 653
MI 654	MI 655	MI 656	MI 657
MI 660	MI 661	MI 662	MI 663
MI 664	MI 665	MI 666	MI 667
MI 670	MI 671	MI 672	MI 673
MI 674	MI 675	MI 676	MI 677
MI 680	MI 681	MI 682	MI 683
MI 684	MI 685	MI 686	MI 687
MI 690	MI 691	MI 692	MI 693
MI 694	MI 695	MI 696	MI 697
MI 700	MI 701	MI 702	MI 703
MI 704	MI 705	MI 706	MI 707
MI 710	MI 711	MI 712	MI 713
MI 714	MI 715	MI 716	MI 717
MI 720	MI 721	MI 722	MI 723
MI 724	MI 725	MI 726	MI 727
MI 730	MI 731	MI 732	MI 733
MI 734	MI 735	MI 736	MI 737
MI 740	MI 741	MI 742	MI 743
MI 744	MI 745	MI 746	MI 747
MI 750	MI 751	MI 752	MI 753
MI 754	MI 755	MI 756	MI 757
MI 760	MI 761	MI 762	MI 763
MI 764	MI 765	MI 766	MI 767
MI 770	MI 771	MI 772	MI 773
MI 774	MI 775	MI 776	MI 777
MI 780	MI 781	MI 782	MI 783
MI 784	MI 785	MI 786	MI 787
MI 790	MI 791	MI 792	MI 793
MI 794	MI 795	MI 796	MI 797
MI 800	MI 801	MI 802	MI 803
MI 804	MI 805	MI 806	MI 807
MI 810	MI 811	MI 812	MI 813
MI 814	MI 815	MI 816	MI 817
MI 820	MI 821	MI 822	MI 823
MI 824	MI 825	MI 826	MI 827
MI 830	MI 831	MI 832	MI 833
MI 834	MI 835	MI 836	MI 837
MI 840	MI 841	MI 842	MI 843
MI 844	MI 845	MI 846	MI 847
MI 850	MI 851	MI 852	MI 853
MI 854	MI 855	MI 856	MI 857
MI 860	MI 861	MI 862	MI 863
MI 864	MI 865	MI 866	MI 867
MI 870	MI 871	MI 872	MI 873
MI 874	MI 875	MI 876	MI 877
MI 880	MI 881	MI 882	MI 883
MI 884	MI 885	MI 886	MI 887
MI 890	MI 891	MI 892	MI 893
MI 894	MI 895	MI 896	MI 897
MI 900	MI 901	MI 902	MI 903
MI 904	MI 905	MI 906	MI 907
MI 910	MI 911	MI 912	MI 913
MI 914	MI 915	MI 916	MI 917
MI 920	MI 921	MI 922	MI 923
MI 924	MI 925	MI 926	MI 927
MI 930	MI 931	MI 932	MI 933
MI 934	MI 935	MI 936	MI 937
MI 940	MI 941	MI 942	MI 943
MI 944	MI 945	MI 946	MI 947
MI 950	MI 951	MI 952	MI 953
MI 954	MI 955	MI 956	MI 957
MI 960	MI 961	MI 962	MI 963
MI 964	MI 965	MI 966	MI 967
MI 970	MI 971	MI 972	MI 973
MI 974	MI 975	MI 976	MI 977
MI 980	MI 981	MI 982	MI 983
MI 984	MI 985	MI 986	MI 987
MI 990	MI 991	MI 992	MI 993
MI 994	MI 995	MI 996	MI 997

LEGEND

- | | |
|-----------------------|-------------------|
| BOUNDARY LINES | PLSS LINES |
| Top/Parcel | Aliquot |
| Description Line | Quarter |
| Water | Section |
| Civil Division | Ownership/Hook |
| Centerline Private RD | LeaderLine |
| Easement | Boat Launch |
- 200 0 200 400 600
Feet
1" = 200'