

COUNTY OF VILAS  
TOWN OF ST. GERMAIN  
TOWN OF WOODRUFF

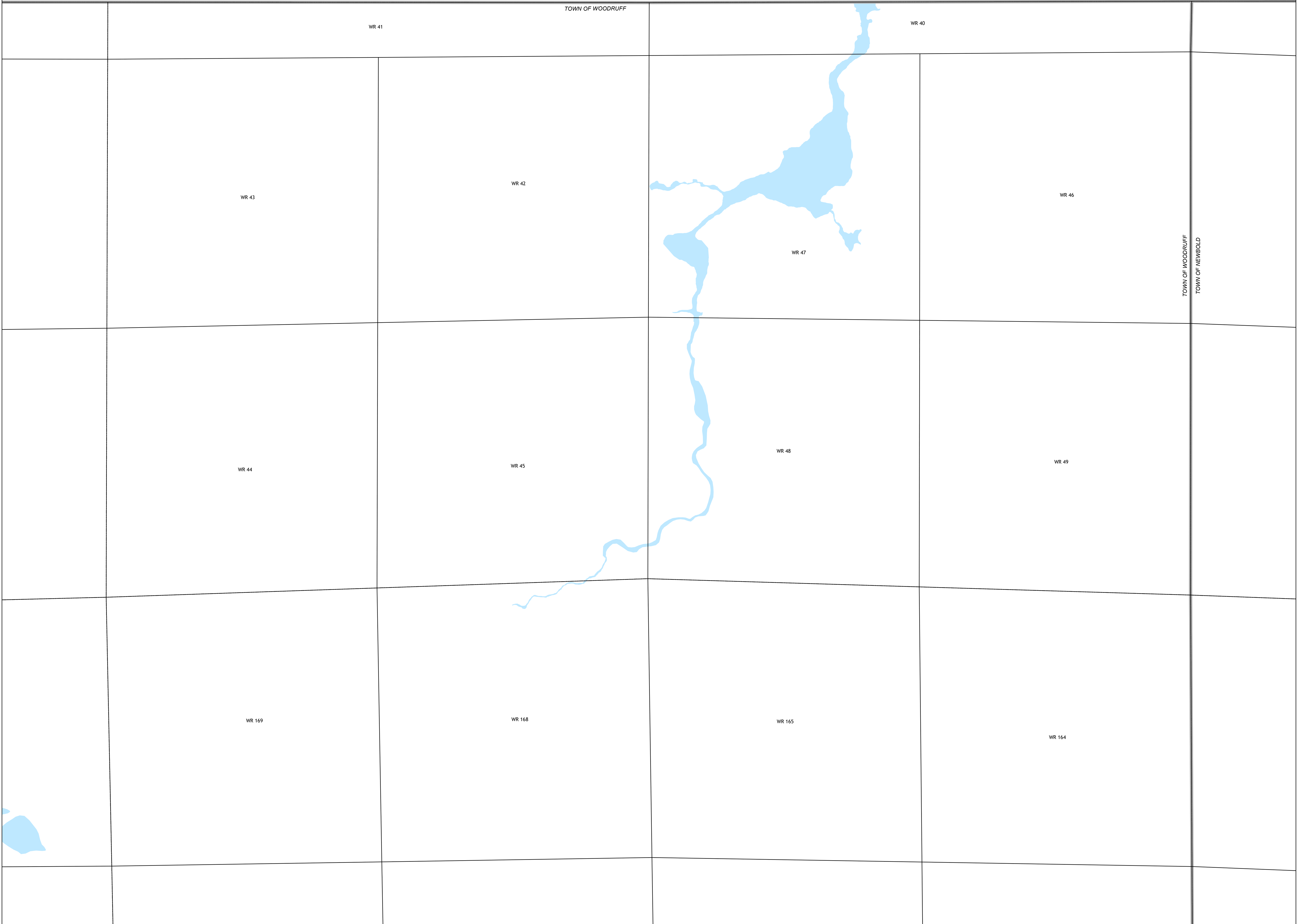

**NOTICE**

This map is not a survey map of the current parcels and should not be used for conveying real property or guaranteeing title to the properties shown. This map represents a sketch of the parcels listed on the Oneida County tax roll and is intended to aid in the tracking of such parcels. The parcels on this map were mapped from available public records at the time of their creation. These maps may not represent the current parcel location or dimensions of the parcel as it now exists on the ground. Right-of-Ways on this map may not be current and need further research. Gaps and overlaps shown on this map need further research. Refer to original source documents for parcel verification.

The map data hereon is represented "as is" without warranty of any kind, either expressed or implied, or statutory, including, but not limited to, the implied warranties or merchantability and fitness for a particular purpose. The user assumes the entire risk as to the quality and use of the map. No guarantee of accuracy, completeness is granted, nor is any responsibility for reliance thereon assumed. In no event shall Oneida County, its elected or appointed officials or employees be liable for direct, indirect, incidental, consequential or special damages of any kind, including, but not limited to, loss of anticipated profits or benefits arising out of use of or the reliance on the map. Oneida County does not accept liability for any damages or misrepresentation caused by inaccuracies in the data or as a result of the changes to the map data.

Date Created: 2/18/2020

MAPS BASED ON PREVIOUS YEAR TAX ROLL

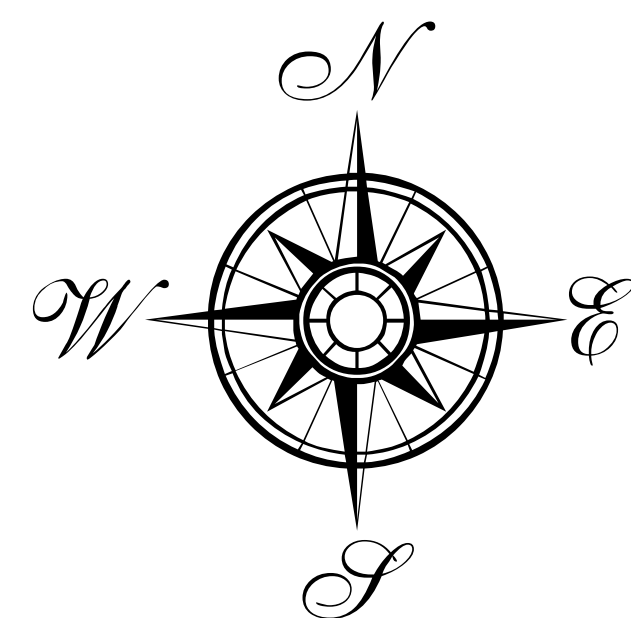

**SECTION 01, T39N-R07E**

Oneida County Land Information Office  
"Where Nature Lingered Longer"  
PO Box 400  
Rhineland, Wisconsin 54501  
Phone: (715) 369-6179  
www.co.oneida.wi.us  
OneView: <https://gis.oneida.wi.us/oneview>

PRAC. SW 1/4		PRAC. NE 1/4	
SW 1/4	NE 1/4	SW 1/4	NE 1/4
SW 1/4	NE 1/4	SW 1/4	NE 1/4
SW 1/4	NE 1/4	SW 1/4	NE 1/4

**LEGEND**

- |                           |                       |
|---------------------------|-----------------------|
| <b>BOUNDARY LINES</b>     | <b>PLS LINES</b>      |
| — Tax/Parcel              | --- Aliquot           |
| --- Description Line      | --- Quarter           |
| --- Water                 | --- Section           |
| --- Civil Division        | <b>OTHER FEATURES</b> |
| --- Centerline Private RD | --- Ownership/Hook    |
| --- Easement              | --- LeaderLine        |
|                           | --- Boat Launch       |

