

SECTION 10K,
FOUND IRON PIPE
AND WOOD POST

S84-20E
1409.35'

NORTH

SCALE 1"=100'

CLARKE
~~GORECKI~~
WESTERSKI

N17°23'11"E 355.41'
370.72'
0.834
ACRES
FOUND I.P.
146.9'

N1°45'E 475.0' (CORROD)

1403.72'
N84-19W

UNRECORDED QUIT
CLAIM DEED TO MRS.
ANN GORECKI, DATED
JAN. 1955

NE 1/4 SEC. 15, T37N, R5E

495.0'
EAST SEC. 140 LINE
817.85'

S-129

I hereby certify that this is a true and
correct copy of a plat of survey made
of part of the NW 1/4, NW 1/4, Section 13,
T37N, R5E, Oneida County,
Wisconsin, as the instrument of Mrs. Ann Gorecki,
Pl. Rec. 10/15/63, 1/15/68 and 10/29/68.

Leonard L. Lampert
Leonard L. Lampert

DATE DRAWN NOV 5, 1963
LEGEND
● IRON PIPE FOUND
○ IRON PIPE SET
▣ BUILDING

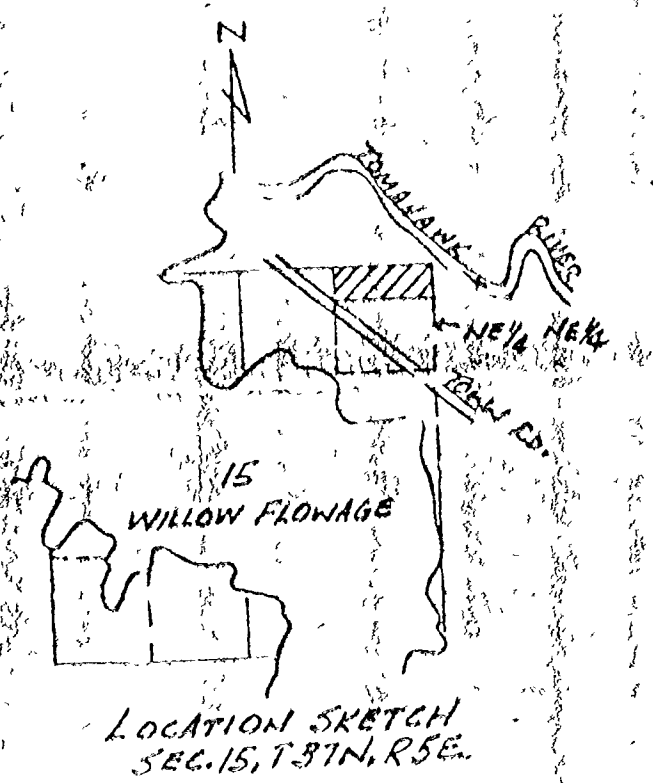

TO WILLOW FLOWAGE DAM

SET I.P.

SET I.P.

N1°45'E

TO WILLOW FLOWAGE DAM
ROAD
N52°17'W
BLACK TOP

