

A 1024

A 1024

Part of
LOT 3
 of
Vol. 2 CERTIFIED SURVEY MAPS, p. 444
 Being part of the
NE1/4 of the NW1/4
 and part of the
NW1/4 of the NE1/4
SECTION 11, T39N, R6E
 Town of Minocqua
 Oneida County, Wisconsin

Vol. 2 CSM, -2-

-3-

p. 444

Easement

Road

State Highway "70"

U.S. Highway "51"

100.00'
N77°57'00"W

30'

184.77'
84.77'

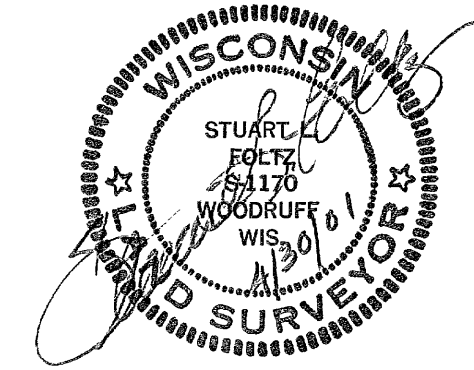

Bearings Solar, per plat

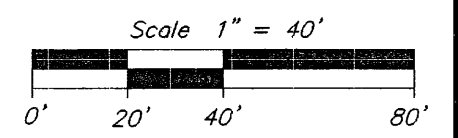

- = 2" iron pipe found
- ⊙ = 1-1/4" iron rod found
- ⊖ = 3/4" iron rebar found

I hereby certify to the present owner(s) and/or purchaser(s) of the property included in this survey, and to those who mortgage or guarantee title for the present owner(s) or purchaser(s) within one year from the date hereof, that this survey was performed in accordance with acceptable professional standards, that the survey data shown hereon is, to the best of my knowledge, information and belief, a true and accurate representation thereof, that any legal descriptions conforming to this survey have been provided on separate sheets, and that this survey was performed by order of Lee Guenther, TA Solberg Co., Inc

MAP # **A 1024**
 DATE FILED **MAY 18 2001**
 BY *JP*
 DESCRIPTION FILED
 ONEIDA CO. SURVEYOR'S OFFICE

Foltz and Associates, Inc

Surveyors	Engineers
8612 Highway 51 North	Minocqua Wisconsin 54548
(715) 356-9485	fax (715) 356-1841

A 1024

A 1024