

A1358

A1358

Katherine

Lake

DOC #557726  
(Oneida County Surveyor's File #A531)

G.L. 5  
G.L. 6

MAP # **A1358**  
DATE FILED... **APR 16 2004**  
BY.....  
DESCRIPTION FILED.....  
ONEIDA CO. SURVEYOR'S OFFICE

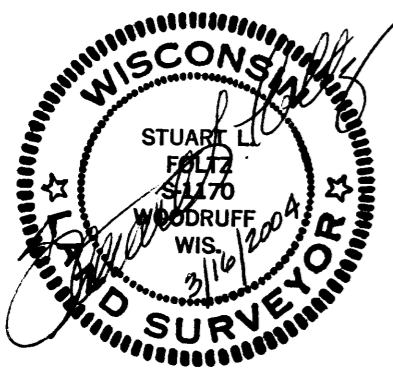

Revised 3/16/04; to show the "Manner" sign.

Bearings Assumed

**The South Line  
of  
DOCUMENT #557726  
Being part of  
GOV'T. LOT 6  
SECTION 11, T38N, R6E  
Town of Hazelhurst  
Oneida County, Wisconsin**

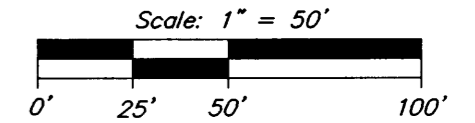

- = 1" iron pipe found
- = 1" iron pipe set
- ( ) = previously recorded

I hereby certify to the present owner(s) and/or purchaser(s) of the property included in this survey, and to those who mortgage or guarantee title for the present owner(s) or purchaser(s) within one year from the date hereof, that this survey was performed in accordance with acceptable professional standards; that the survey data shown hereon is, to the best of my knowledge, information and belief, a true and accurate representation thereof; that any legal descriptions conforming to this survey have been provided on separate sheets; and that this survey was performed by order of San Orr, Yawkey Lumber Company.

NOTE: Property line surveyed does not commence from a corner marked and established by the U.S. public land survey. A waiver from Ch. A-E 7.04, Wis. Adm. Code, has been executed between San Orr, Yawkey Lumber Company and Foltz and Associates, Inc.

**Foltz and Associates, Inc.**

Surveyors  
8612 Highway 51 North, Minocqua, Wisconsin 54548  
(715) 356-9485

Engineers  
54548  
fax (715) 356-1841

C. Winkler 11-11-386

A1358

A1358