

Mid

Lake

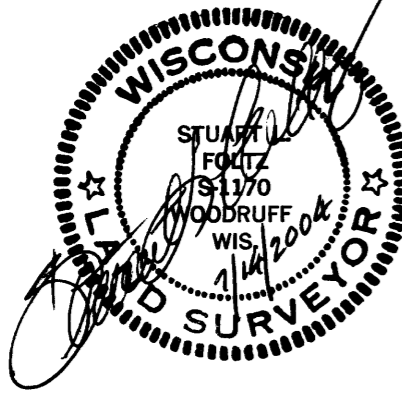

MAP # **A 1385**  
 DATE FILED **JUL 20 2004**  
 BY *Pud*  
 DESCRIPTION FILED  
 ONEIDA CO. SURVEYOR'S OFFICE

Part of  
**GOV'T. LOT 2**  
**SECTION 19, T39N, R7E**  
 Town of Woodruff  
 Oneida County, Wisconsin

I hereby certify to the present owner(s) and/or purchaser(s) of the property included in this survey, and to those who mortgage or guarantee title for the present owner(s) or purchaser(s) within one year from the date hereof, that this survey was performed in accordance with acceptable professional standards; that the survey data shown hereon is, to the best of my knowledge, information and belief, a true and accurate representation thereof; that any legal descriptions conforming to this survey have been provided on separate sheets; and that this survey was performed by order of Judy Grau.

NOTE: This survey is based on title information contained in Chicago Title Insurance Co. ALTA Commitment No. ON 33841, effective June 16, 2004, issued by Oneida Title & Abstract, Inc. of Rhinelander, WI.

**Foltz and Associates, Inc.**  
 Surveyors: 8612 Highway 51 North, Minocqua, Wisconsin 54548  
 (715) 356-9485  
 Engineers: 54548  
 fax (715) 356-1841

C. Winkler 8-19-397