

The  
West Line  
of  
Volume 894 Records, page 122  
Being part of the  
NW1/4 of the SE1/4  
SECTION 2, T38N, R7E  
Town of Lake Tomahawk  
Oneida County, Wisconsin

Vol. 894 Rec<sup>o</sup>

Improvements  
not shown

p. 122

Bearings  
Assumed

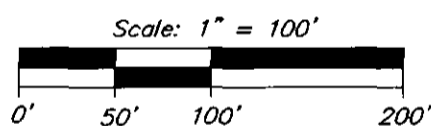

- = 1" iron pipe found
- = 1" iron pipe set over 10" spike found
- ( ) = previously recorded

The W. Line of the E1/2 of the NW-SE  
per 1998 survey by Thomas Oberberger.  
See Oneida County Surveyor's File #L1571.

(N1°02'50"W, 1296.42')  
N0°59'42"W  
1297.36'

NW-SE  
NE-SE

1292.15'  
S118°48'E  
(S118°48'E, 1292.64')

NW-SE  
SW-SE 1/16th line by others

(N89°01'30"W, 321.17')  
N88°56'10"W  
320.98'

Pine

(approx.)

Road

SE1/16 Corner  
1-1/4" iron pipe found

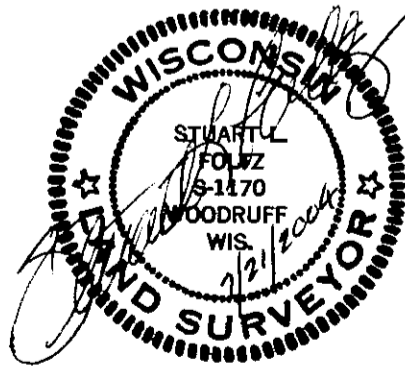

MAP # **A 1407**  
DATE FILED **SEP 23 2004**  
BY *MBK*  
DESCRIPTION FILED  
ONEIDA CO. SURVEYOR'S OFFICE

I hereby certify to the present owner(s) and/or purchaser(s) of the property included in this survey, and to those who mortgage or guarantee title for the present owner(s) or purchaser(s) within one year from the date hereof, that this survey was performed in accordance with acceptable professional standards; that the survey data shown hereon is, to the best of my knowledge, information and belief, a true and accurate representation thereof; that any legal descriptions conforming to this survey have been provided on separate sheets; and that this survey was performed by order of Chris Rexrode.

No new legal descriptions have been prepared.

Foltz and Associates, Inc.

Surveyors                      Engineers  
8612 Highway 51 North,      Minocqua, Wisconsin 54548  
(715) 356-9485                      fax (715) 356-1841