

A survey of a parcel of land being part of the SW 1/4 of the SE 1/4 of Section 17, T.36 N., R.9 E., Town of Pelican, Oneida County, Wisconsin.

N 1/4 COR. SEC. 17-36-9 x

This map and description drafted for the benefit of addition to existing parcel.



BEARINGS REFERENCED FROM ONEIDA COUNTY COORDINATES

OWNER OF PARCEL "C": RAYMOND & CAROL ZASTROW

BUYER OF PARCEL "C": JEREMY IRISH & LAURA IRISH

PARCEL "C":

A parcel of land being part of the SW 1/4 of the SE 1/4 of Section 17, T.36 N., R.9 E., Town of Pelican, Oneida County, Wisconsin and being more particularly described as follows:

Commencing at the S 1/4 corner of said Section 17; thence N.89°59'15"E., along the South line of said SE.1/4, 175.00 feet to a 3/4" rebar found, being the point of beginning; thence N.08°24'51"E., along the East line of said Document No. 598930, 291.11 feet; to a 3/4" Rebar found; thence N.00°54'53"E., continuing along the East line of said Document No. 598930, 150.00 feet; thence N.89°59'15"E., 86.00 feet; thence S.00°54'53"W., 438.00 feet to said S. line of the SE 1/4; thence S.89°59'15"W., along the South line of said SE. 1/4, 120.00 feet to the point of beginning.

Said parcel contains 0.99 acres, more or less.

PARCEL B: 228,826 SQ. FT. 5.34 ACRES

DOC. 598930

LEGEND

- 3/4" X 18" REBAR, SET
- 3/4" X 18" REBAR, FOUND
- △ PK NAIL, FOUND
- x CALCULATED POSITION FROM COUNTY COORDINATES

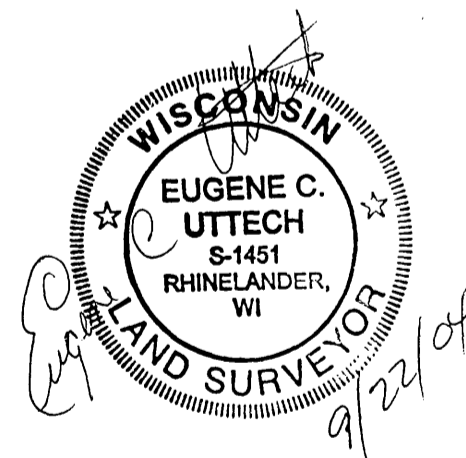

I, EUGENE C. UTTECH, REGISTERED LAND SURVEYOR OF THE STATE OF WISCONSIN DO HEREBY CERTIFY THIS IS TRUE AND CORRECT TO THE BEST OF MY KNOWLEDGE AND BELIEF.

MAP # A1421
 DATE FILED OCT 05 2004
 BY MCK
 DESCRIPTION FILED
 ONEIDA CO. SURVEYOR'S OFFICE

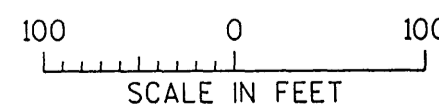

PLAT OF SURVEY

CLIENT
 JEREMY J. IRISH &
 LAURA M. IRISH

MSA
 TRANSPORTATION • MUNICIPAL
 DEVELOPMENT • SUBDIVISIONS
 1311 K. Street N. Rhineland, WI 54881
 715.340.2241 • 800.446.2624 Fax: 715.340.4116
 © 2004 MSA SURVEYING SERVICE

DRAWN BY SJO DATE 9-17-2004 SHEET 1 of 1
 CHECKED BY ECU SCALE 1"=100' FILE NO. 980574