

PART OF
 GOVERNMENT LOT 9 & 10
 SECTION 15, TOWNSHIP 39 NORTH, RANGE 6 EAST
 TOWN OF MINOCQUA
 ONEIDA COUNTY, WISCONSIN

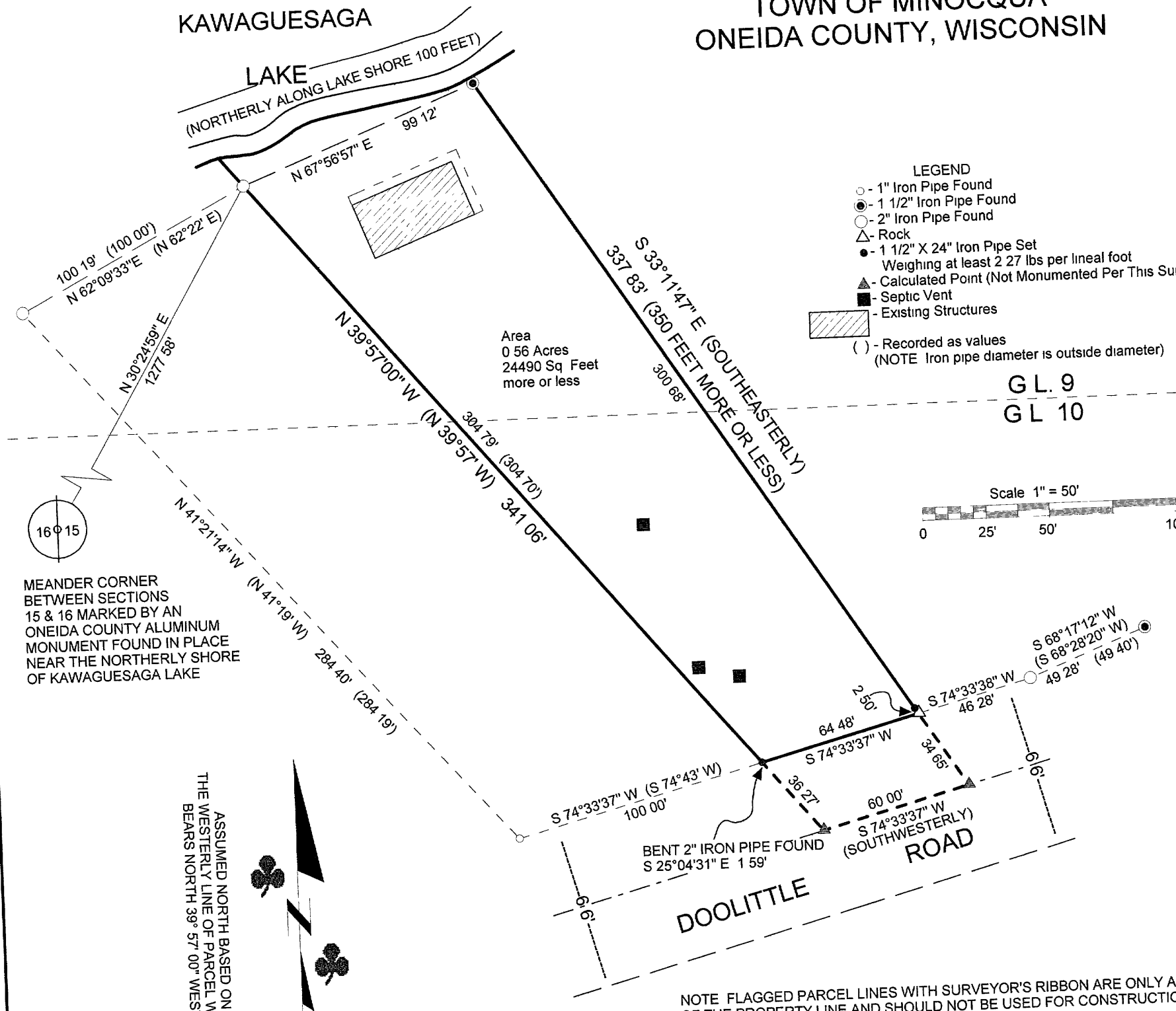

MEANDER CORNER BETWEEN SECTIONS 15 & 16 MARKED BY AN ONEIDA COUNTY ALUMINUM MONUMENT FOUND IN PLACE NEAR THE NORTHERLY SHORE OF KAWAGUESAGA LAKE

ASSUMED NORTH BASED ON THE WESTERLY LINE OF PARCEL WHICH BEARS NORTH 39° 57' 00\"/>

NOTE FLAGGED PARCEL LINES WITH SURVEYOR'S RIBBON ARE ONLY A REPRESENTATION OF THE PROPERTY LINE AND SHOULD NOT BE USED FOR CONSTRUCTION PURPOSES

NOTE WATER WAY BOUNDARIES MUST BE DETERMINED BY THE APPROPRIATE GOVERNING AUTHORITY ANY LAKE SHORE, CREEK EDGE, WETLAND, ETC LOCATED ON THIS SURVEY MAP ARE APPROXIMATE

DESCRIPTION

Part of Government Lots 8 & 9, Section 15, Township 39 North, Range 6 East, town of Minocqua, Oneida County, Wisconsin as shown on McMullen & Associates Inc survey dated the 29th Day of April, 2005, more particularly described as follows

Commencing at the Meander Corner between Section 15 and Section 16 Marked by an Oneida County Aluminum Monument near the Northerly shore of Kawaguesaga Lake, thence North 30° 24' 59\"/>

Thence meandering along said lake shore North 67° 56' 57\"/>

Said described tract containing 0.56 acres (24,490 square feet), more or less

Subject to any easements, restrictions, or rights of way of record or of use

Including all those lands lying between the above described meander line and the water's edge of Kawaguesaga Lake

SURVEYOR'S CERTIFICATE

I, Benton A McMullen, Wisconsin Registered Land Surveyor # S-2555, do hereby certify that I have surveyed and mapped the property shown hereon, and that I have complied with the applicable requirements of the Wisconsin Administrative Code Chapter A-E 7, and that this map represents a true and accurate survey of said property to the best of my knowledge and belief

This survey was performed under the order of Jim Murphy

This survey is made for the use of the present owners of the property, and also those who purchase, mortgage, or guarantee the title thereto within one year from date hereof



Registered Land Surveyor # S-2555

MAP # **A1505**
 DATE FILED **JUN 14 2005**
 BY
 DESCRIPTION
 ONEIDA CO SURVEYOR'S OFFICE

FIELD SURVEY WORK COMPLETED ON THE 4TH DAY OF MARCH, 2005

MCMULLEN & ASSOCIATES, INCORPORATED
 LAND SURVEYING AND SOIL TESTING
 9832 BOLGER LAKE ROAD
 MINOCQUA, WISCONSIN 54548
 TELEPHONE # (715) 356-3011 FAX # (715) 356-1501

DRAFTED BY Dwight A Miesbauer	DATE April 29, 2005
SCALE 1" = 50'	JOB #205025

A1505

A1505