

A 1506

MAP # **A 1506**
 DATE FILED **JUN 14 2005**
 BY *JP*
 DESCRIPTION **...**
 ONEIDA CO SURVEYOR'S OFFICE

**PART OF THE
 SOUTHWEST 1/4 OF THE SOUTHWEST 1/4
 SECTION 35, TOWNSHIP 39 NORTH, RANGE 6 EAST
 TOWN OF MINOCQUA
 ONEIDA COUNTY, WISCONSIN**

N 89°14'10" E (N 89°14'12" E) 523 92' (523 85')
 30 FOOT WIDE EASEMENT ROAD (N 89°14'12" E) 453 03' (453 03')

NOTE McMULLEN & ASSOCIATES, INC DIDN'T FLAG / MARK PARCEL LINES PER THIS SURVEY SURVEY PERFORMED TO LOCATE MARK PARCEL CORNERS ONLY

LEGEND
 ○ - 1" Iron Pipe Found
 ⊙ - 1 1/4" Iron Pipe Found
 () - Recorded as values
 (NOTE Iron pipe diameter is outside diameter)

ASSUMED NORTH, BASED ON THE SOUTHERLY SECTION LINE OF SECTION 35 WHICH BEARS NORTH 89° 17' 22" EAST

487 53' (487 50')
 N 3°25'05" W (N 3°25'01" W)
 962 67' (962 73')
 475 14' (475 23')

S 3°25'00" E (S 3°24'56" E) 963 04' (963 15')

NOTE EXISTING STRUCTURES NOT LOCATED PER THIS SURVEY

AREA
 10 00 ACRES
 435721 SQ FEET
 MORE OR LESS

DESCRIPTION

Part of the Southwest 1/4 of the Southwest 1/4, Section 35, Township 39 North, Range 6 East, town of Minocqua, Oneida County, Wisconsin more particularly described as follows

Commencing at the Southwest Section corner of said Section marked by a 1 1/4" iron pipe, thence along the Southerly line of said Section North 89° 17' 22" East (Assumed North, based on the Southerly Section line of Said Section), a distance of 568 38 feet to a 1" iron pipe, said point being the POINT OF BEGINNING

Thence leaving the said Section line North 3° 25' 05" West, a distance of 962 67 feet to a 1" iron pipe on the Southerly right-of-way of an easement 33 feet in width, thence North 89° 14' 33" East along said right-of-way, a distance of 453 03 feet to a 1" iron pipe, thence South 3° 25' 00" East, a distance of 963 04 feet to a 1" iron pipe on said Section line, thence South 89° 17' 22" West along said Section line, a distance of 453 02 feet to the POINT OF BEGINNING

Said described tract containing 10 00 acres (435721 square feet), more or less

Subject to any easements, restrictions, or rights of way of record or of use

SOUTHWEST SECTION CORNER OF SECTION 35 MARKED BY A 1 1/4" IRON PIPE

1" IRON PIPE 3 38' WESTERLY OF CORNER

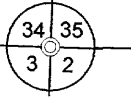

568 38' (568 40')
 N 89°17'22" E (N 89°17'22" E) 1021 40'
 453 02' (453.00')

FIELD SURVEY WORK COMPLETED ON THE 27TH DAY OF MAY, 2005

SURVEYOR'S CERTIFICATE

I, Benton A McMullen, Wisconsin Registered Land Surveyor # S-2555, do hereby certify that I have surveyed and mapped the property shown hereon, and that I have complied with the applicable requirements of the Wisconsin Administrative Code Chapter A-E 7, and that this map represents a true and accurate survey of said property to the best of my knowledge and belief

This survey was performed under the order of Theresa Winger

This survey is made for the use of the present owners of the property, and also those who purchase, mortgage, or guarantee the title thereto within one year from date hereof

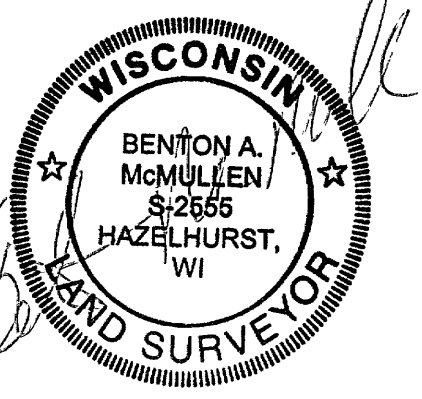
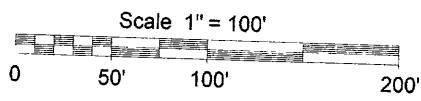

Registered Land Surveyor # S-2555

MCMULLEN & ASSOCIATES, INCORPORATED
 LAND SURVEYING AND SOIL TESTING
 9832 BOLGER LAKE ROAD
 MINOCQUA, WISCONSIN 54548
 TELEPHONE # (715) 356-3011 FAX # (715) 356-1501

DRAFTED BY Dwight A Miesbauer	DATE MAY 31, 2005
SCALE 1" = 100'	JOB #205054

A 1506

A 1506