

MAP # **A 1759**  
 DATE FILED **JUN 28 2006**  
 BY \_\_\_\_\_  
 DESCRIPTION FILED \_\_\_\_\_  
 ONEIDA CO. SURVEYOR'S OFFICE

**LOT 315**  
**OF THE PLAT OF TIMBER RIDGE II**  
**PART OF THE**  
**SOUTHEAST 1/4 OF THE SOUTHWEST 1/4**  
**SECTION 33,**  
**TOWNSHIP 39 NORTH, RANGE 6 EAST**  
**TOWN OF MINOCQUA**  
**ONEIDA COUNTY, WISCONSIN**

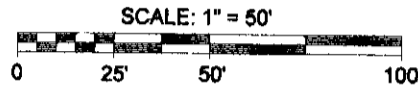

- LEGEND**
- - 1" Iron Pipe Found
  - - 1 1/4" Iron Pipe Found
  - - 1 1/4" Iron Rod Found
  - ( ) - Recorded as values
- (NOTE: Iron pipe diameter is outside diameter)

NOTE: SURVEY PERFORMED TO FLAG / MARK THE  
 EASTERLY LINE OF LOT 315 ONLY.

**SURVEYOR'S CERTIFICATE**

I, Benton A. McMullen, Wisconsin Registered Land Surveyor # S-2555, do hereby certify that I have surveyed and mapped the property shown hereon, and that I have complied with the applicable requirements of the Wisconsin Administrative Code Chapter A-E 7, and that this map represents a true and accurate survey of said property to the best of my knowledge and belief.

This survey was performed under the order of:  
 Mark & Karen Geier

This survey is made for the use of the present owners of the property, and also those who purchase, mortgage, or guarantee the title thereto within one year from date hereof.

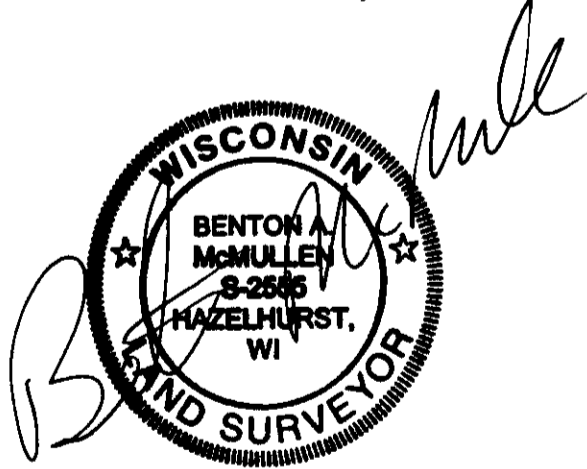

Registered Land Surveyor # S-2555  
 Benton A. McMullen

FIELD SURVEY WORK COMPLETED ON  
 THE 14TH DAY OF MARCH, 2006.

**MCMULLEN & ASSOCIATES,**  
**INCORPORATED.**  
 LAND SURVEYING AND SOIL TESTING  
 9832 BOLGER LAKE ROAD  
 MINOCQUA, WISCONSIN 54548  
 TELEPHONE # (715) 356-3011 FAX # (715) 356-1501

DRAFTED BY: Dwight A. Miesbauer	DATE: March 15th, 2006
SCALE: 1" = 50'	JOB # 206036

