

**SURVEY OF THE NORTH LINE OF GOV'T. LOT 1, SEC.13,  
T. 36 N., R. 9 E., TOWN OF PELICAN, ONEIDA COUNTY, WI.**

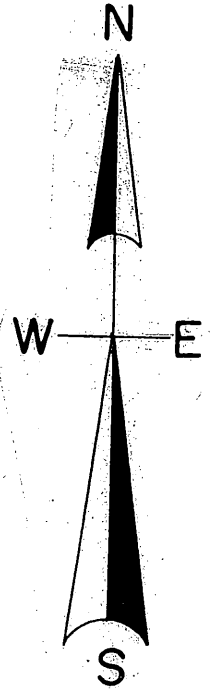

Survey was performed to show area  
Of encroachment of Lot 2 into the  
NW 1/4 of the NW 1/4.

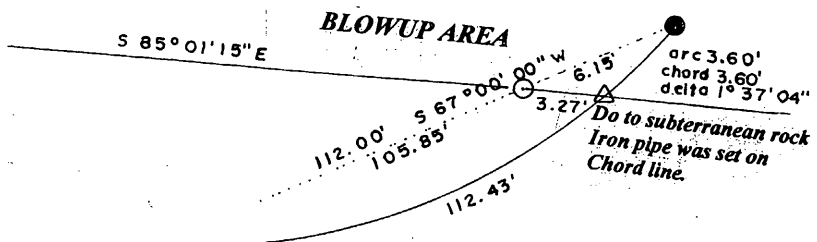

NW. COR. GOV'T. LOT 1

NE. COR. GOV'T. LOT 1

**LOT -2-**  
CSM. VOL. 3 PG. 902

PRIVATE ROAD  
OUTLOT 1

MAP # **A1907**  
DATE FILED **JUN 04 2007**  
BY *[Signature]*  
DESCRIPTION FILED  
ONEIDA CO. SURVEYOR'S OFFICE

SCALE

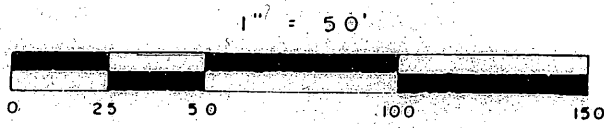

North is referenced to the north line  
Lot 2 CSM v.3 p. 902, being a bearing  
Of N 78° 29' 10" W.

**LEGEND**

- FOUND 3/4" IRON ROD
  - FOUND 1" IRON PIPE
  - SET 1" IRON PIPE
  - △ COMPUTED POSITION
- (BEARING & DISTANCE OF RECORD)

DATE May 9, 2007

SIGNED *[Signature]*

LOFTUS SURVEYING

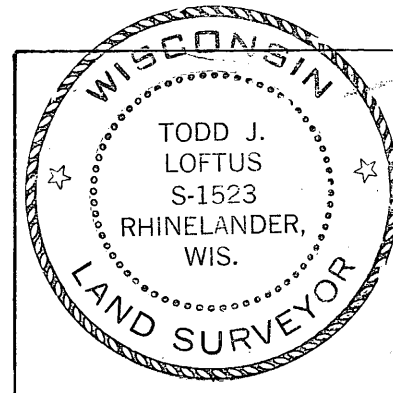

**SURVEY FOR KAREN MINASSI  
RHINELANDER, WI.**

**LOFTUS SURVEYING**  
860 BALSAM STREET  
RHINELANDER, WI. 54501  
TEL. FAX 715-369-1142  
HODAG28@HOTMAIL.COM

1526B5

I, Todd Loftus, Registered Land Surveyor, hereby certify that I have surveyed the property shown hereon. That this map represents an accurate survey of said property to the best of my knowledge & belief. That I have performed this survey by order of Karen Minassi and that I have complied with the applicable requirements of the Wisconsin Administrative Code A.E.7.

2061

2061A