

SPOT ELEVATIONS
LOCATED IN THE E 1/2 OF THE
SE 1/4 OF THE NW 1/4, SEC. 31,
T. 36 N., R. 9 E., TOWN OF PELICAN,
ONEIDA COUNTY, WI.

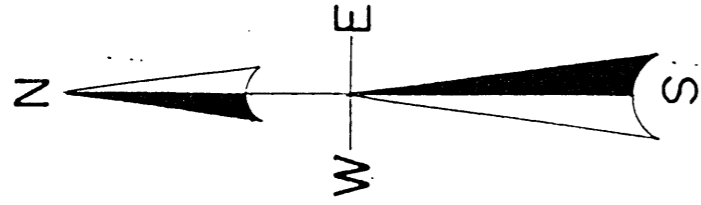

Note- road location
is approximate.

Note- road and lake were
calculated into acreage.

SCALE

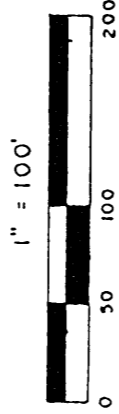

BENCH MARK
41 SAN 1964
SC6170
ELEV. 1600.02 FEET

FLOOD PLAIN ELEVATION
1560.4 FEET BASED ON
LOMA (DOCUMENT REMOVAL)
COMMUNITY# 550579
NUMBER 55085CO325B
CASE # 05-05-3015A

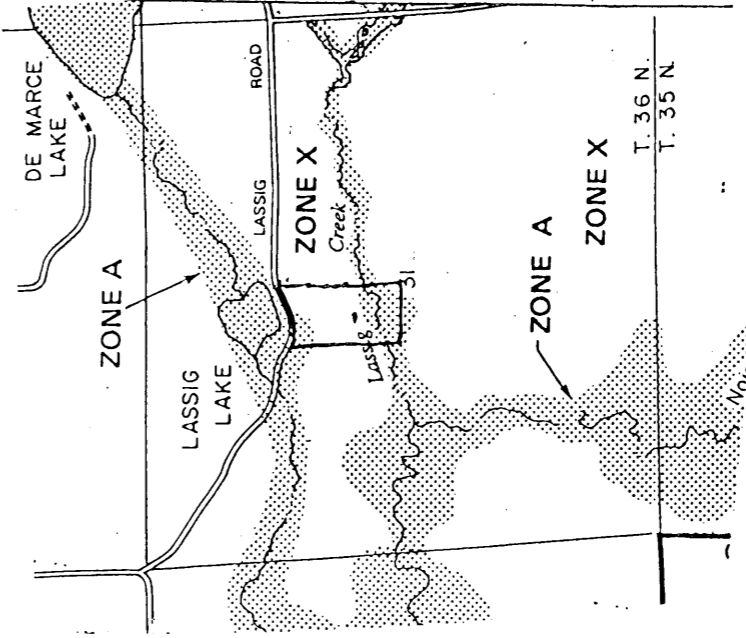

LEGEND

- FOUND IRON PIPE
- FOUND IRON SPIKE
- SLOPE —>

I, Todd Loftus, Registered Land Surveyor,
Hereby certify that the above shown elevations
are correct to the best of my knowledge
& belief.

MAP # A1955

DATE FILED OCT 12 2007

BY [Signature]

DESCRIPTION FILED

ONEIDA CO. SURVEYOR'S OFFICE

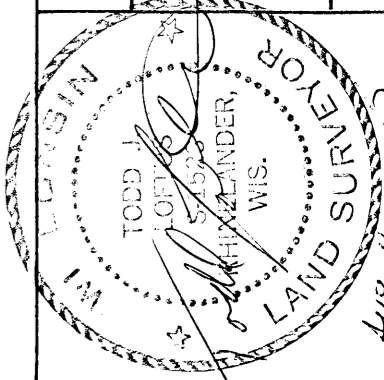

NOTE- map is not to be used as an
Accurate boundary survey for client.

ELEVATION SHOTS FOR
CARLOS CONADO
RHINELANDER, WI.

LOFTUS SURVEYING
860 BALSAM STREET
RHINELANDER, WI 54501
HODAG28@HOTMAIL.COM
TEL/FAX 715-369-1142

LASSIG LAKE
S 88° 30' 32" W 671.50'

C-N 1/16

LASSIG ROAD

66'

E 1/2 20.6 ACRES

FLAT

○ EL. 1570.63'

○ EL. 1569.48'

○ EL. 1569.91'

○ EL. 1570.73'

○ EL. 1569.73'

○ EL. 1569.72'

○ EL. 1569.75'

○ EL. 1570.08'

○ EL. 1569.71'

○ EL. 1565.53'

○ EL. 1567.72'

EL. 1563.71'

554.12'

approximate flood plain location

EL. 1557.87'

N 3° 04' 26" W 1341.11'

N 88° 25' 13" E 667.27'

C 1/4 COR.