

NORTH WIND PUDDING DRIVE

Northwest Sec. Cor.

(S 89° 24' E 1003.3') 1003.12'

(S 89° 24' E 180.0')

(S 89° 24' E 100.0')

(S 29° 06' E 20.0')

(S 89° 29' 34" E 75.31' (75.98'))

S 89° 26' 54" E 822.86'

S 89° 26' 54" E 180.26'

S 89° 29' 34" E 100.03'

S 28° 59' 00" E 19.86'

S 28° 59' 00" E 99.79'

(S 29° 06' E 100.0')

RETRACEMENT SURVEY OF DOC #660415
KNOWN AS LOT K
BEING PART OF GOV'T. LOT 4, SEC. 29
T. 38 N., R. 7 E., TOWN OF LAKE TOMAHAWK
ONEIDA COUNTY, WI.

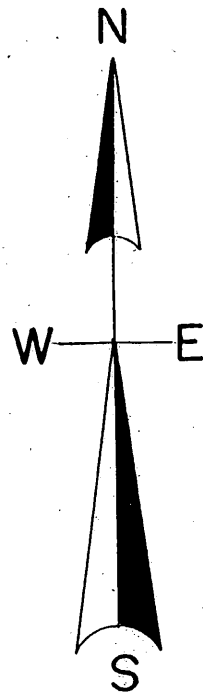

North is referenced to the north
Line section 29 being a recorded
Bearing of S 89° 24' E.

LOT J

LOT K

LOT L

WIND PUDDING LAKE

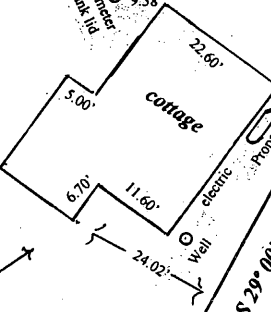
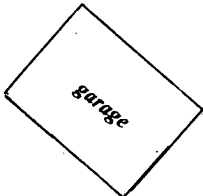

LEGEND

- ⊙ Found 2" Brass Capped iron pipe
- Found 1.25" iron pipe
- Found 1" iron pipe
- Found 3/4" iron pipe
- Set 1" iron pipe
- ▲ Set railroad spike over iron pull
- (00.0') Bearing & Distance of record

SCALE

1" = 30'

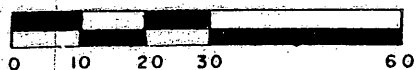

I, Todd Loftus, Registered Land Surveyor, hereby certify that I have surveyed the property shown hereon. That this map represents an accurate survey of said property to the best of my knowledge & belief. That I have performed this survey by order of Kathy Skusa and that I have complied with the applicable requirements of the Wisconsin Administrative Code A.E.7.

Description required for above parcel is on separate sheet.

DATE April 21, 2009

SIGNED [Signature]

LOFTUS SURVEYING

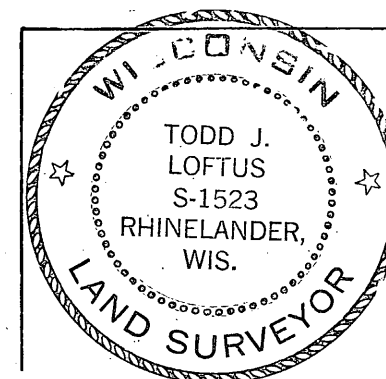

Survey for Kathy Skusa
Oconomowoc, WI.

LOFTUS SURVEYING
860 BALSAM STREET
RHINELANDER, WI. 54501
TEL/FAX 715-369-1142
HODAG28@HOTMAIL.COM

MAP #	A 2251
DATE FILED	5/7/09
BY	[Signature]
DESCRIPTION FILED	
ONEIDA CO. SURVEYOR'S OFFICE	