

MAP # A 2269  
 DATE FILED 6/24/09  
 BY [Signature]  
 DESCRIPTION FILED  
 ONEIDA CO. SURVEYOR'S OFFICE

Volume 767 Micro-Records, page 187  
 Being part of  
**GOV'T. LOT 6**  
**SECTION 18, T39N, R5E**  
 Town of Minocqua  
 Oneida County, Wisconsin

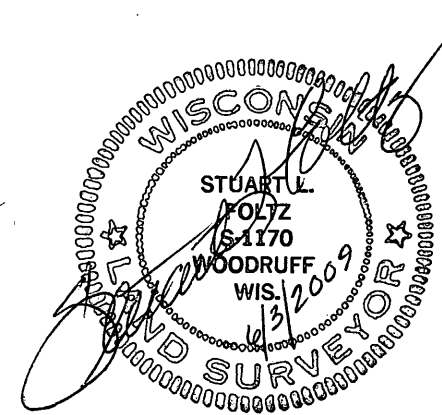

S. Bo-Di-Lac Road

C-S1/16 Corner  
 (per record)  
 1-1/2" iron pipe found  
 knocked out, set wood  
 lath at approx. location

G.L. 5  
 G.L. 6 (by others)  
 (S84°24'E)  
 (1388.5')

Meander Corner  
 (per record)  
 1-3/4" iron pipe found

Vol. 767 M/R,  
 (Improvements not shown)  
 p. 186

Bearings  
 per record

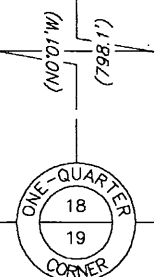

CSM

-1-

#3379

(882.1')

(190.00')

(89.1')

(70.0')  
 (539°43'W)

(80.0')  
 (534°10'W)

(S22°42'W, 236.6')  
 (196.6')

-3-

(80.0')

(139.8')  
 (N86°30'W)

(127.5')  
 (N73°34'W)

(539°54'W, 126.8')

Squirrel

Lake

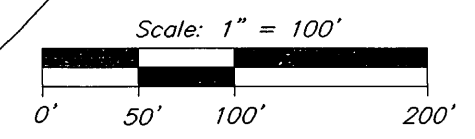

- = 2" iron pipe found
- ⊙ = 1-3/4" iron pipe found
- ⊖ = 1-1/2" iron pipe found
- ⊕ = 1-1/4" iron rod found
- ⊖ = 1" iron pipe found
- ( ) = previously recorded

This survey was made for Gary Kohl, hereafter referred to as Client. A written agreement has been made between Foltz and Associates, Inc. and Client to exclude this survey from the requirements of Wisconsin Administrative Code Chapter A-E 7. The requirements not being complied with are: 1) A field survey traversing and connecting monuments necessary for location of the parcel(s) owned by Client has not been made; 2) Monuments were not set to mark the corners of the parcel(s); 3) No legal description of the parcel(s) has been provided or shown on this map; 4) The exact lengths and bearings of the boundaries of the parcel(s) owned by Client have not been shown on this map; 5) The relationship to the surveyed parcel(s) of the monuments used for determining the location of the parcel(s) owned by Client have not been shown by bearing and distance on this map; and 6) The measurements made in performing this survey work do not conform to the minimum accuracy requirements of 1 part in 3000 for linear measurements, or 30 seconds per angle but not more than 120 seconds total angular closure for closed traverses. 7) This survey was completed with a cloth tape and compass and was for the purpose of locating existing lot corners. A closed traverse was not made and the minimum accuracy is 1 part in 100 and plus or minus 2 degrees.

This survey is correct to the best of my knowledge and belief.

NOTE: The location of S. Bo-Di-Lac Road shown is approximate only, based on aerial photography provided by the Oneida County Surveyor's Office.

**Foltz and Associates, Inc.**

Surveyors	Engineers
8612 Highway 51 North,	Minocqua, Wisconsin 54548
(715) 356-9485	fax (715) 356-1841

C. Winkler