

**Part of the Southeast 1/4 of the Northeast 1/4
 Section 31, Township 37 North, Range 7 East
 Town of Cassian
 Oneida County, Wisconsin**

Description

Part of Southeast 1/4 of the Northeast 1/4, Section 31, Township 37 North, Range 7 East, town of Cassian, Oneida County, Wisconsin shown on a survey map by Survey North, LLC of Wisconsin with a Job No. of 12R015 dated the 15th Day of October, 2012, being previously described in Document No. 702397 recorded at the Oneida County Register of Deeds Office and more particularly described as follows:

Commencing at the East 1/4 Corner of said Section marked by a Brass Capped Iron Pipe; thence North 0° 00' 00" West along the East line of said Section (Assumed North, based on said Section line), a distance of 200.05 feet to a 1" Iron Pipe, said point being the POINT OF BEGINNING.

Thence continuing along said Section line North 0° 00' 00" West, a distance of 246.55 feet to a 1.3" Iron Pipe on the Southerly line of the parcel described in Volume 445, Page 343 recorded at the Oneida County Register of Deeds Office; thence continuing along said Section line North 0° 00' 00" West, a distance of 67.24 feet to a 1.3" Iron Pipe on the Northerly line of the parcel described in Volume 445, Page 343 recorded at the Oneida County Register of Deeds Office; thence leaving said Northerly line and continuing along said Section line North 0° 00' 00" West, a distance of 36.38 feet to a 1" Iron Pipe; thence leaving said Section line North 90° 00' 00" West, a distance of 415.44 feet to a 1.3" Iron Pipe on the Northerly line of the parcel described in Volume 445, Page 343 recorded at the Oneida County Register of Deeds Office; thence continuing North 90° 00' 00" West, a distance of 185.88 feet to a Calculated Point on the Easterly right-of-way of Harshaw Road witnessed by a 1.3" Iron Pipe which bears North 8° 19' 14" East, 4.86 feet; thence South 8° 19' 14" West along said right-of-way, a distance of 28.20 feet to a 1.3" Iron Pipe on the Southerly line of the parcel described in Volume 445, Page 343 recorded at the Oneida County Register of Deeds Office; thence continuing South 8° 19' 14" West along said right-of-way, a distance of 30.62 feet to a Calculated Point; thence continuing along said right-of-way along the arc of a curve to the left a distance of 255.84 feet, a radius of 1500.00 feet, a delta angle of 9° 46' 20" and a long chord which bears South 3° 26' 04" West with a chord length of 255.53 feet to a Calculated Point; thence continuing along said right-of-way South 1° 27' 07" East, a distance of 36.91 feet to a 1.3" Iron Pipe; thence leaving said right-of-way North 90° 00' 00" East, a distance of 624.18 feet to the POINT OF BEGINNING.

EXCEPT that part described in Volume 445 of records, Page 343. That part of said Volume and Page being excepted from the parcel previously described in Document No. 702397 recorded at the Oneida County Register of Deeds Office being located in Part of Southeast 1/4 of the Northeast 1/4, Section 31, Township 37 North, Range 7 East, town of Cassian, Oneida County, Wisconsin shown on a survey map by Survey North, LLC of Wisconsin with a Job No. of 12R015 dated the 15th Day of October, 2012, and more particularly described as follows:

Commencing at the East 1/4 Corner of said Section marked by a Brass Capped Iron Pipe; thence North 0° 00' 00" West along the East line of said Section (Assumed North, based on said Section line), a distance of 446.60 feet to a 1.3" Iron Pipe; thence leaving said Section line North 78° 58' 43" West, a distance of 138.89 feet to a 0.5" Iron Pipe; thence South 85° 11' 15" West, a distance of 166.21 feet to a 0.5" Iron Pipe; thence North 78° 15' 07" West, a distance of 309.94 feet to a 1.3" Iron Pipe on the Easterly right-of-way of Harshaw Road; thence North 8° 19' 14" East along said right-of-way, a distance of 28.20 feet to a Calculated Point witnessed by a 1.3" Iron Pipe which bears North 8° 19' 14" East, 4.86 feet; thence leaving said right-of-way North 90° 00' 00" East, a distance of 185.88 feet to a 1.3" Iron Pipe; thence South 78° 15' 07" East, a distance of 120.03 feet to a 0.5" Iron Pipe; thence North 85° 11' 15" East, a distance of 165.79 feet to a 0.5" Iron Pipe; thence South 78° 58' 43" East, a distance of 135.21 feet to a 1.3" Iron Pipe on the East line of said Section; thence South 0° 00' 00" East along said Section line, a distance of 67.24 feet to the POINT OF BEGINNING.

Said described tract containing 4.13 acres (179938.7 square feet), more or less.

Subject to and Together with any easements, restrictions, or rights of way of record or of use.

A 2703
 FILED 11-20-12
 J.B.
 RECEPTION FILED
 CO. SURVEYOR'S OFFICE

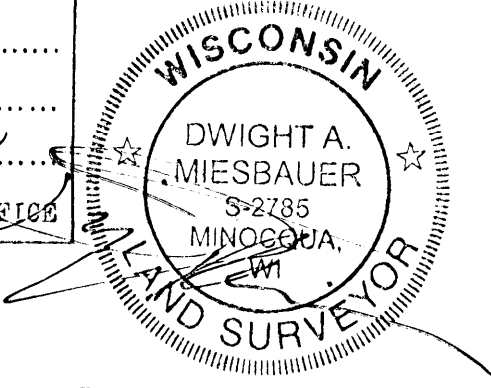

Registered Land Surveyor No. S - 2785
 Dwight A. Miesbauer Sr.



www.survey-north-llc.com
 (715)-439-3226

Job No. 12R015 Scale: N.A.

Dated the 15th Day of October, 2012