

Dog Lake

BEARING BASIS OF RECORD

BEARINGS ARE BASED ON THE RECORD EAST-WEST 1/4 LINE BEARING OF S 87°47'00"W.

NOTE: LEGAL DESCRIPTION IS PROVIDED ON A SEPARATE SHEET.

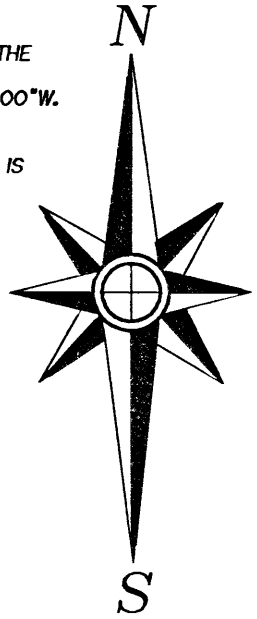

Volume 274, Page 590
Document No. 606017

977 Bundo Rd.
Document No. 715404

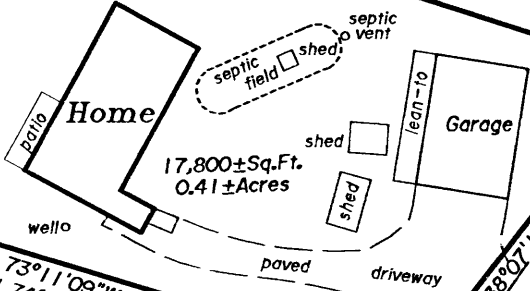

MAP # A2780
 DATE FILED 9-23-13
 BY JB
 DESCRIPTION FILED
 ONEIDA CO. SURVEYOR'S OFFICE

Being a Part of
Gov't. Lot 6, Section 15
T 38 N, R 11 E
Town of Three Lakes
Oneida County, Wisconsin

Scale: 1" = 50'



-Surveyor's Certificate-

"I HEREBY CERTIFY, THAT I HAVE SURVEYED AND MAPPED THE LANDS SHOWN HEREON AND THAT, TO THE BEST OF MY KNOWLEDGE AND BELIEF, THIS SURVEY AND MAP IS A TRUE AND CORRECT REPRESENTATION THEREOF, AND THAT I HAVE COMPLIED WITH THE APPLICABLE REQUIREMENTS OF CHAPTER A-E 7 OF THE WISCONSIN ADMINISTRATIVE CODE'S MINIMUM STANDARDS FOR PROPERTY SURVEYS."

DATED THIS 29th DAY OF JULY, 2013.

Michael E. Weber
MICHAEL E. WEBER, R.L.S. 2070

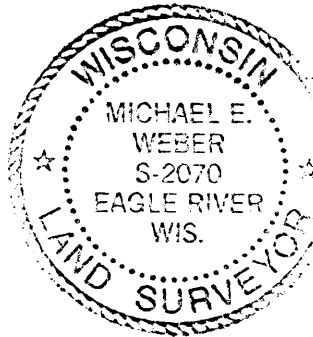

-Legend-

- G.L.O. CONCRETE MONUMENT WITH BRASS CAP FOUND IN PLACE
- ⊙ 2" IRON PIPE FOUND IN PLACE
- ⊕ 1-1/2" IRON PIPE FOUND IN PLACE
- 1" IRON PIPE FOUND IN PLACE
- △ COMPUTED ANGLE POINT
- () BEARING & DISTANCE OF RECORD

Survey For
Jeffrey & Nancy Baum
1262 Coyote Ct.
Hampshire, IL 60140

SCALE: 1" = 50' DATE: 7/29/2013 DWN. BY: TAB

Drawing No. **E3798** Eagle Landmark Surveying, inc.
5035 Hwy. 70 West, Eagle River, WI 54521
P&F (715)479-9610 eaglelandmark@frontier.com