

Lot 8 of Minola Beach Plat

Located in
Gov't. Lot 5, Section 32
T 39 N, R 11 E
Town of Three Lakes
Oneida County, Wisconsin

Scale: 1" = 30'
0' 10' 20' 40' 60'

Oneida County
Grid North

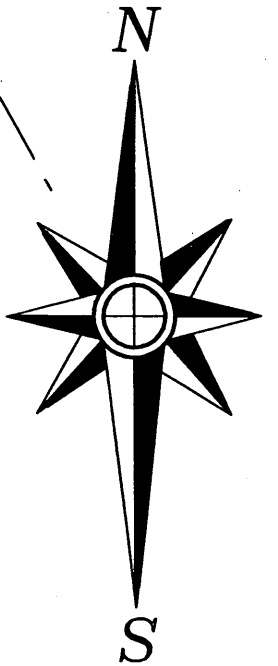

Island

Lake

-Lot 7-

-Lot 8-

7523 Hwy. X
Document No. 436727
31,220±Sq.Ft.
0.72±Acres

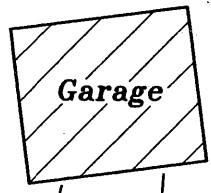
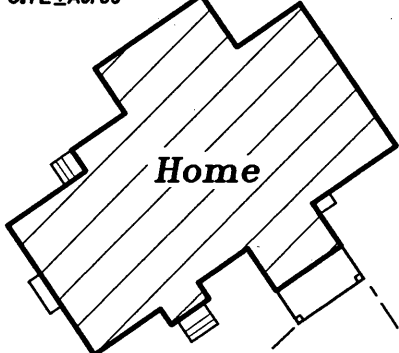

Home

Garage

septic lids

well

generator

driveway

actual roadway

-Lot 9-

-Legend-

- ONEIDA COUNTY ALUMINUM CAPPED MONUMENT FOUND IN PLACE
- 1" IRON PIPE FOUND IN PLACE
- () BEARING & DISTANCE OF RECORD

-Surveyor's Certificate-

"I HEREBY CERTIFY, THAT I HAVE SURVEYED AND MAPPED THE LANDS SHOWN HEREON AND THAT, TO THE BEST OF MY KNOWLEDGE AND BELIEF, THIS SURVEY AND MAP IS A TRUE AND CORRECT REPRESENTATION THEREOF, AND THAT I HAVE COMPLIED WITH THE APPLICABLE REQUIREMENTS OF CHAPTER A-E 7 OF THE WISCONSIN ADMINISTRATIVE CODE'S MINIMUM STANDARDS FOR PROPERTY SURVEYS."

DATED THIS 18th DAY OF SEPTEMBER, 2015.

Thomas A. Boettcher
THOMAS A. BOETTCHER, P.L.S. 1763

50' wide Platted Road

MAP # **A 3113**
 DATE FILED 1-26-16
 BY JB
 DESCRIPTION FILED
 ONEIDA CO. SURVEYOR'S OFFICE

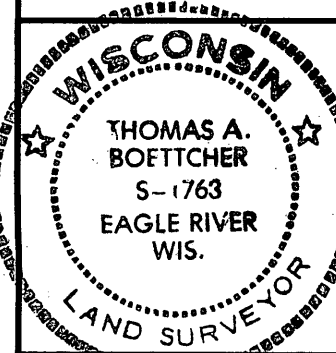

Survey For
Brian & Kristin Johnson
 N7430 Niagra Lane
 Fond du Lac, WI 54937

SCALE: 1" = 30' DATE: 9/18/2015 DWN. BY: TAB

Drawing No. **E3987** Eagle Landmark Surveying Inc.
 5035 Hwy. 70 West, Eagle River, WI 54521
 P&F (715)479-9610 eaglelandmark@frontier.com

Witness Meander Corner

Medicine Lake