

Part of
Government Lot 5
SECTION 1, TOWNSHIP 37 NORTH, RANGE 6 EAST
Town of Cassian
Oneida County, Wisconsin

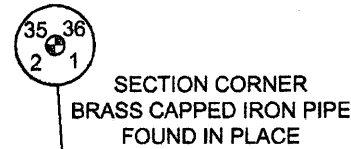

SURVEYOR'S CERTIFICATE (A-E7)
I, Benton A. McMullen, Wisconsin Professional Land Surveyor # S-2555, do hereby certify that I have surveyed and mapped the property shown hereon, and that I have complied with the applicable requirements of the Wisconsin Administrative Code Chapter A-E 7, and that this map represents a true and accurate survey of said property to the best of my knowledge and belief.

This survey was performed under the order of:
DEBORAH NEUVILLE



S 03°42'13\" E (S 03°40'00\" E)
1430.91' (1430.97')

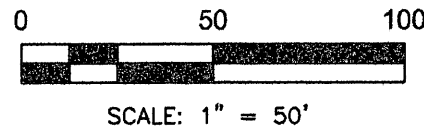

NORTH 1/16 CORNER FOUND IN PLACE

N 87°31'52\" E (N 87°31' E)
1122.35' (1122.11')
N 87°31'00\" E (N 87°31' E)
1398.08' (1397.9')

End of road
Per town road sign

MAPLE LANE

N 07°04'28\" E (S 07°16'03\" W)
82.07' (82.05')

N 87°48'50\" E (S 88°07'12\" W)
202.54' (199.71')

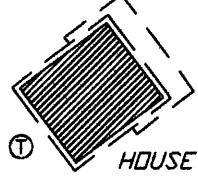
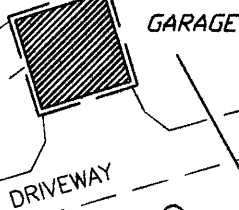

S 39°17'34\" E
(N 40°51'29\" W)
99.43' (100.36')

BEARSKIN LAKE

S 87°27'30\" W
275.73'
(N 87°30'00\" E)
(275.90')

O.H.W.M.



PROFESSIONAL LAND SURVEYOR # S-2555

FIELD SURVEY WORK COMPLETED ON THE 8TH DAY OF DECEMBER, 2015

- LEGEND**
- - 1.660\" Iron Pipe Found
 - ⊙ - 1.900\" Iron Pipe Found
 - - 3/4\" Iron Bar Set
 - ⊕ - Well
 - Ⓣ - Septic Tank
 - Ⓢ - Sewer Vent
 - ⊗ - Utility Pole
 - (...) - Recorded as values
 - ▨ - Existing Building

Found a bent 1.660\" Iron Pipe
Replaced with a 3/4\" Iron Bar

O.H.W.M.
(for reference only)
O.H.W.M. IS APPROXIMATE

ANY LAND BELOW THE ORDINARY HIGH WATER MARK OF A LAKE OR A NAVIGABLE STREAM IS SUBJECT TO THE PUBLIC TRUST IN NAVIGABLE WATERS THAT IS ESTABLISHED UNDER ARTICLE IX, SECTION 1 OF THE STATE CONSTITUTION.

NOTES

- 1) IRON PIPE DIAMETERS GIVEN ARE OUTSIDE DIAMETERS.
- 2) IT IS NOT THE INTENT OF THIS SURVEY MAP TO SHOW ALL EASEMENTS.

DESCRIPTION

Part of Government Lot 5, Section 1, Township 37 North, Range 6 East, Town of Cassian, Oneida County, Wisconsin as shown on a survey map by McMullen & Associates, Incorporated of Minocqua, Wisconsin dated the 4th day of January, 2016 with a job number of 216001 and previously described in document number 543345 as recorded in the Oneida County Register of Deeds office and more particularly described as follows:

Commencing at the northwest section corner of said section marked by a brass capped iron pipe; thence along the west line of said section South 03° 42' 13\" East for a distance of 1430.91 feet to the north 1/16 corner marked by a 1.660\" iron pipe; thence along the south line of said government lot North 87° 31' 52\" East for a distance of 1122.35 feet to a 3/4\" iron bar, said point being the POINT OF BEGINNING.

Thence leaving said south line North 07° 04' 28\" East for a distance of 82.07 feet to a 1.660\" iron pipe; thence North 87° 48' 50\" East for a distance of 202.54 feet to a 1.660\" iron pipe near the shore of Bearskin Lake; thence meandering along said lake shore South 39° 17' 34\" East for a distance of 99.43 feet to a 1.900\" iron pipe, said point being a meander corner on the south line of said government lot; thence along said south line South 87° 27' 30\" West for a distance of 275.73 feet to the POINT OF BEGINNING.

Said described tract containing 19,348 Square Feet or 0.44 Acres, more or less.

Subject to any easements, restrictions, or rights of way of record or of use.

Including all those lands lying between the above described meander line and the water's edge of Bearskin Lake.

MCMULLEN & ASSOCIATES, INCORPORATED
"Your true north surveyors and soil testers"
PO BOX 51, MINOCQUA, WISCONSIN 54548
TELEPHONE (715) 356-3011

NEUVILLE SURVEY
PART OF GOVERNMENT LOT 5
SECTION 1, TOWNSHIP 37 NORTH, RANGE 6 EAST
Town of Cassian
Oneida County, Wisconsin

DRAFTED BY: Benton A. McMullen DATE: January 4, 2016
SCALE: 1\" = 50' JOB NBR: 216001 SHEET 1 OF 1 SHEETS