

EAST LINE SURVEY LOT 17, WILDWOOD SHORES PLAT, LOCATED IN SECTION 23, T37N, R08E, TOWN OF NEWBOLD, ONEIDA COUNTY, WISCONSIN

SURVEY FOR CURT JOHNSON

BIXBY LAND SURVEYING INC.  
P.O. BOX 1532  
RHINELANDER, WI. 54501  
715-362-5263

WEB PAGE: bixbylandsurveying.com  
715-362-5263 (LAND)  
DWG # 714

BEARINGS REFERENCED TO THE EAST LINE LOT 17, WILDWOOD SHORES, ASSUMED TO BEAR N19°44'32"E.

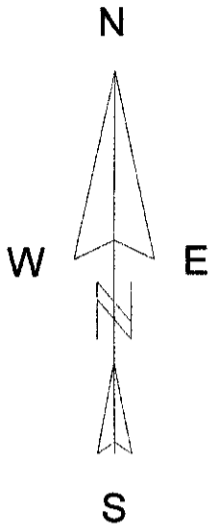

LEGEND

● EXISTING 1" IRON PIPE AT GRADE

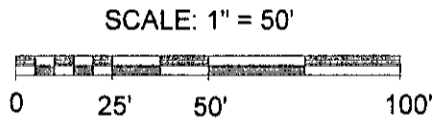

SCALE: 1" = 50'

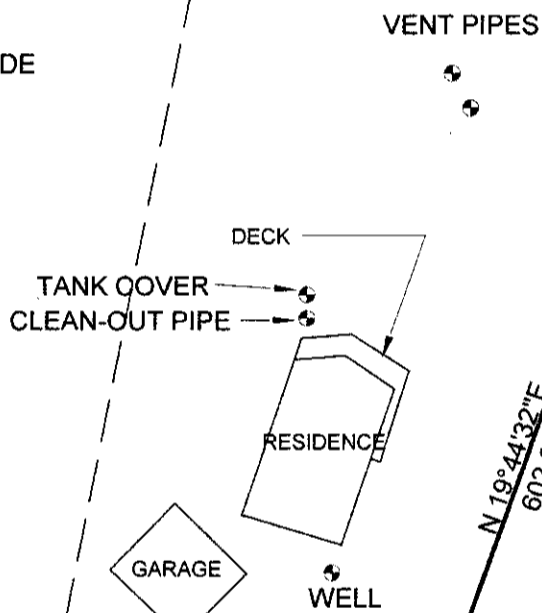

MAP # **A 3 1 7 2** ✓  
DATE FILED 7/19/16  
BY HB  
DESCRIPTION FILED  
ONEIDA CO. SURVEYOR'S OFFICE



I, KEVIN P. BIXBY, PROFESSIONAL LAND SURVEYOR, HEREBY CERTIFY TO MY CLIENT, THAT I HAVE SURVEYED THE ABOVE LINE AND THAT THE ABOVE SURVEY IS A TRUE AND CORRECT REPRESENTATION OF THE LINE SURVEYED TO THE BEST OF MY KNOWLEDGE AND BELIEF. THAT I HAVE COMPLIED WITH THE MINIMUM REQUIREMENTS OF AE-7 OF THE WISCONSIN ADMINISTRATIVE CODE.

*Kevin P. Bixby*  
KEVIN P. BIXBY

7/19/16  
DATE