

LANDS BEING PART OF GOVERNMENT LOT 5
SECTION 26, T.38N., R6E., TOWN OF HAZELHURST,
ONEIDA COUNTY, WISCONSIN.

THIS MAP AND DESCRIPTION DRAFTED FOR THE BENEFIT
OF EXCHANGE OF LAND BETWEEN ABUTTING OWNERS, TO
CLEAR TITLE TO ENCROACHMENTS

NOTE:
NEW DESCRIPTION PROVIDED ON SEPARATE SHEET

DOCUMENT
#524670



BEARINGS REFERENCE TO THE
ONEIDA COUNTY COORDINATE
SYSTEM WITH SOUTH LINE OF GOV.
LOT 5 TO BEAR N 88°24'08" E

NW CORNER
SEC. 26
2" O.C.M.
N 88°03'47" E
1330.74'
N 88°03'47" E
799.12' (M)
798.99 (R)
MEANDER
CORNER
2" O.C.M.
N. LINE OF THE
NW 1/4 -NW 1/4
SEC. 26

W. LINE OF
GOV. LOT 5
SEE PLAT OF SURVEY
MAP B6856
MAP B7447
FOR SUBDIVISION OF SECTION 26

N 42°29'41" E
34.74'

N 88°24'08" E 515.46'
S 00°15'36" W 1325.38'

LEGEND

- FOUND 2" IRON PIPE
- FOUND 1/2" IRON PIPE
- ◆ FOUND 1/2" IRON ROD
- FOUND 3/4" REBAR
- △ FOUND MAG NAIL
- ▲ COMPUTED POINT

(M) MEASURED
(R) RECORD INFORMATION



BOEHM DRIVE

N 68°50'55" W
8.63'

N 23°24'46" E 90.71'

S 68°50'55" E 200.81' 208.5 (R)

N 32°42'05" E
99.65' (M)
100' (R)

S 76°34'05" E
0.87'

SOUTH
BLUE
LAKE

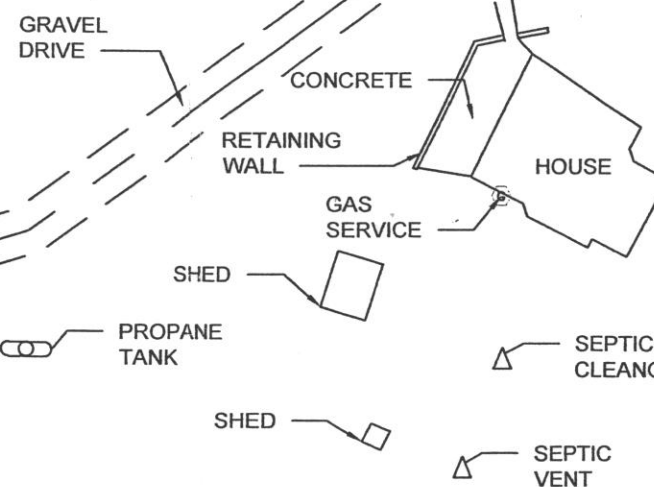

Curve Table				
Curve #	Arc Length	Radius	Chord Length	Chord Bearing
C1	109.40	827.12	109.32	N27° 12' 07"E
C2	2.14	827.12	2.14	N30° 55' 01"E
C3	107.26	827.12	107.19	N27° 07' 40"E

(M.) S. 82°12'46" E.
(R.) S 82°28'07" E 217' +/-

191.91 (R) 195.80 (M)
209.31' S 88°24'08" W 236' +/-

N 32°33'00" E
3.93'

PARCEL 'A'
4176 SQ. FT.

OWNER: MICHAEL &
MARY KRUEGER
DOC. NO. 367817

MAP # A 3217 ✓
DATE FILED 12/15/16
BY HB
DESCRIPTION FILED
ONEIDA CO. SURVEYOR'S OFFICE

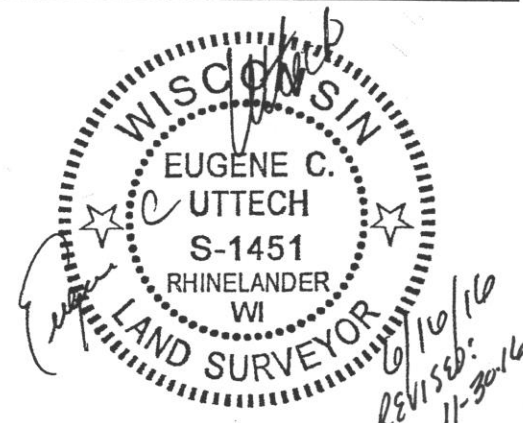

I EUGENE C. UTTECH, PROFESSIONAL LAND SURVEYOR OF THE STATE OF
WISCONSIN, HERBY CERTIFY THAT I HAVE SURVEYED, MAPPED AND
DESCRIBED THE LANDS SHOWN ON THIS PLAT OF SURVEY. THAT SAID PLAT
IS A TRUE AND CORRECT REPRESENTATION OF THE EXTERIOR BOUNDARIES
OF LANDS SURVEYED TO THE BEST OF MY KNOWLEDGE AND BELIEF.

PROJECT NO.	SCALE	AS SHOWN	NO.	DATE	REVISION	BY
17708000	4/12/16	KSM				
PROJECT DATE:	4/12/16	DRAWN BY:	KSM			
F.B.:		CHECKED BY:	ECU			

MIKE KRUEGER
9550 BOEHAM DRIVE
HAZELHURST, WI



ARCHITECTURE | ENGINEERING | ENVIRONMENTAL
FUNDING | PLANNING | SURVEYING
1835 North Stevens St Rhinelander, WI 54501
(715) 362-3244 (800) 844-7854 Fax: (715) 362-4116
Web Address: www.msa-ps.com
© MSA Professional Services, Inc.

FILE NO
17708000
SHEET
1 OF 2

DESCRIPTION OF A PARCEL FOR THE BENEFIT OF EXCHANGE OF LAND BETWEEN ABUTTING OWNERS, TO CLEAR TITLE TO ENCROACHMENTS

A parcel of land being part of Government Lot 5, Section 26, T.38 N., R6 E., Town of Hazelhurst, Oneida County, Wisconsin and being more particularly described as follows:

Commencing at the Northwest corner of said Section 26; thence N.88°03'47"E., a distance of 1330.74 feet to the Northwest corner of Government Lot 5, thence S.00°15'36"W., a distance of 1325.38 feet to the Southwest corner of Government Lot 5, thence N.88°24'08"E., along the South line of said Government Lot 5, a distance of 515.46 feet to mag nail found on the East right-of-way line of Boehm Drive and being the point of beginning of parcel to be described; thence N.30°59'27"E., along said right-of-way line, a distance of 39.86 feet; thence northeasterly, continuing along said right-of-way line, along the arc of a curve to the left, having a radius of 827.12 feet and measured along a chord bearing N.30° 55'01"E., a chord distance of 2.14 feet; thence S.82°12'40"E., a distance of 195.80 feet to a meander corner set near the westerly shoreline of South Blue Lake; thence continuing S. 82°12'40"E., a distance of 21 feet, more or less to the intersection of the ordinary high-water line of said South Blue Lake and the South line of said Government Lot 5; thence S.88°24'08"W., along said South line of Government Lot 5, a distance of 236 feet, more or less to the point of beginning.

Said parcel contains 4,176 square feet, more or less.

Project No. 17708000. (Krueger)
Sheet 2 of 2 Sheets

