

A 3274

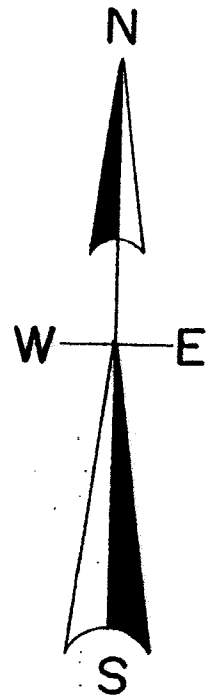

SITE SURVEY

OF LOT 10 OF THE PLAT OF EAGLES VIEW
AS LOCATED IN GOV'T. LOT 1, SEC.33, T. 38 N., R. 9 E.,
TOWN OF SUGAR AMP, ONEIDA COUNTY, WI.

MAP # **A 3274**
DATE 6/21/17
BY MJO
DESCRIBED ...
ONEIDA CO. SURVEYOR'S OFFICE

PINE LAKE ROAD

N 0° 06' 07" E 125.44'
(N 0° 06' 07" E 125.44')

(N 68° 21' 01" E 575.05')

-10-

ZONE -A- PANEL #55085C06605 C

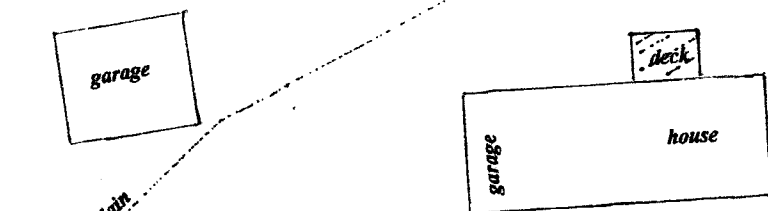

edge of floodplain

edge of floodplain

edge of floodplain

○ FOUND 3/4" IRON ROD
← DIRECTION OF FLOODPLAIN

The purpose of this survey is to show the location of the structures in relation to the floodplain that crosses the parcel of land.
The location of the floodplain was found using the FEMA flood map overlay on the Oneida County GIS. Mapping System and transferring it onto the above map.

(N 86° 47' 20" W 514.14')

(S 3° 20' 21" W 367.01')

LILY BASS ROAD

66'

66'

SCALE

1" = 50'

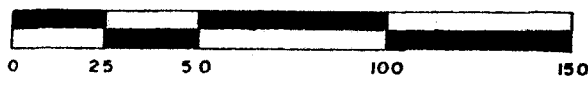

I, Todd J. Loftus, Professional Land Surveyor. Hereby certify that I have located the edge of the floodplain as shown hereon. That this map represents an accurate survey of the edge of the floodplain & structures to the best of my knowledge & belief. That I have performed this survey by the order of Jeremy Hein and that I have complied with the applicable requirements of the Wisconsin Administrative Code A.E. 7.

DATE June 21, 2017
SIGNED Todd J. Loftus

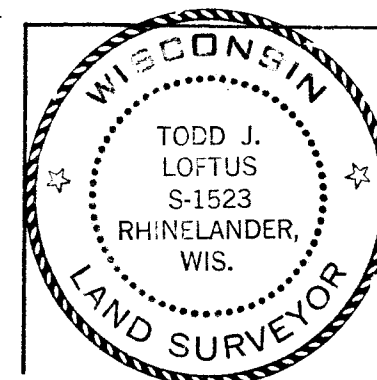

Survey for Jeremy J. Hein
4718 Lily Bass Rd.
Rhinelander, WI. 54501

LOFTUS SURVEYING
860 BALSAM STREET
RHINELANDER, WI. 54501
TEL FAX 715-369-1142
hodag28@hotmail.com

1962B A 3274

A3274