

LOT 5 OF BLOCK 4 OF CONRAD DIETZ REPLAT OF BLOCK 4 OF REMO'S FIRST ADDITION AND BLOCKS 5, 6, 7, 8 AND 9 OF THE LAKE VIEW ADDITION TO THE CITY OF RHINELANDER, ACCORDING TO THE RECORDED PLAT THEREOF LOCATED IN SEC. 1, T. 36 N., R. 8 E. ONEIDA COUNTY, WI.

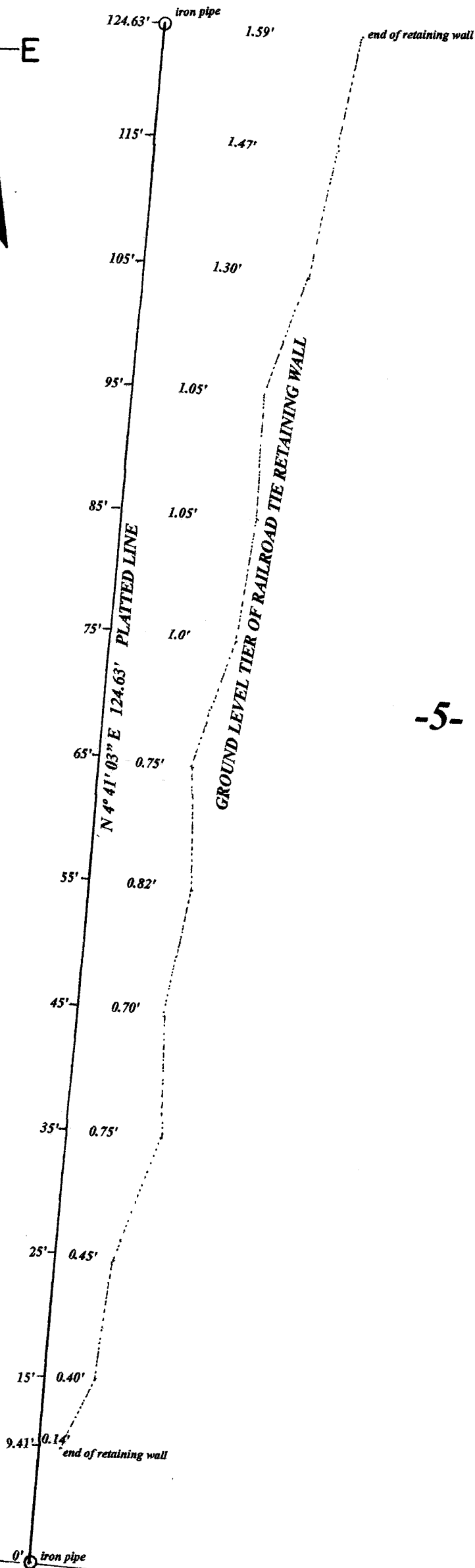
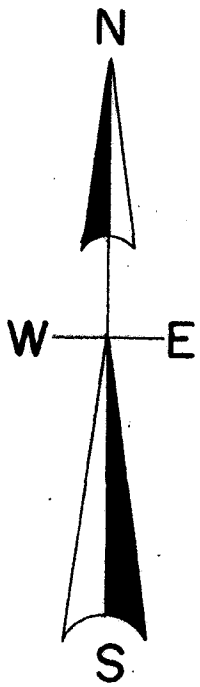

Note- retaining wall has several tiers that are held by numerous 2\"/>

Note- an existing 1 to 2 foot wide hedge is adjacent to the Westerly side of the retaining wall.

-4-

-5-

MAP # A 3304
DATE FILED 8/31/17
BY [Signature]
DESCRIPTION FILED
ONEIDA CO. SURVEYOR'S OFFICE

E - W SCALE
1" = 1'

N - S SCALE
1" = 10'

I, Todd Loftus, Professional Land Surveyor, hereby certify that I have surveyed the lines shown hereon. That this map represents an accurate survey of said lines to the best of my knowledge & belief. That I have performed this survey by order of Judy Richardson and that I have complied with the applicable requirements of the Wisconsin Administrative Code A.E.7.

ELIZABETH STREET

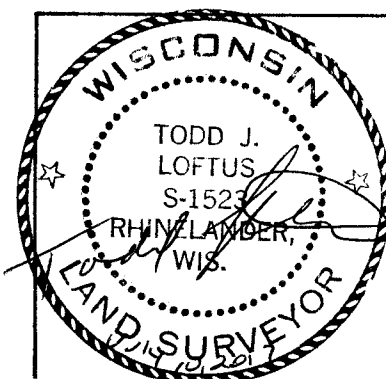

survey for Judy J. Richardson
1320 Elizabeth Street
Rhinelander, WI. 54501

LOFTUS SURVEYING
860 BALSAM STREET
RHINELANDER, WI. 54501
TEL/FAX 715-369-1142
hodag28@hotmail.com

1966B7