

QUARTER CORNER
ONEIDA COUNTY ALUMINUM MONUMENT
Found in Place

EASEMENT SURVEY

Part of
GOVERNMENT LOT 2
SECTION 10, TOWNSHIP 38 NORTH, RANGE 6 EAST
Town of Hazelhurst
Oneida County, Wisconsin

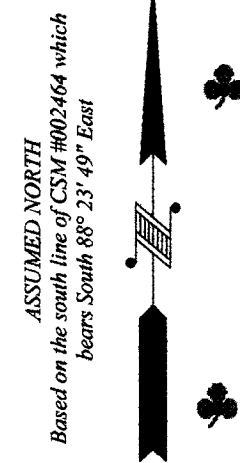
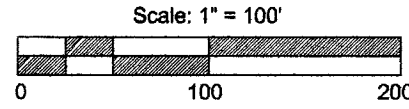

SURVEYOR'S CERTIFICATE

I, Benton A. McMullen, Wisconsin Professional Land Surveyor # S-2555, do hereby certify that I have surveyed and mapped the property shown hereon, and that I have complied with the applicable requirement of the Wisconsin Administrative Code Chapter A-E 7, and that this map represents a true and accurate survey of said property to the best of my knowledge and belief.

This survey was performed under the order of:
Kevin and Lisa Tadych

NOTES

- 1) THIS SURVEY WAS PERFORMED TO HELP IN THE CREATION OF A 20' WIDE ACCESS EASEMENT AS HEREON SHOWN.
- 2) IRON PIPE DIAMETERS GIVEN ARE OUTSIDE DIAMETERS.
- 3) IT IS NOT THE INTENT OF THIS SURVEY MAP TO SHOW ALL EASEMENTS.
- 4) PARCEL LINES WERE NOT MARKED PER THIS SURVEY.

LEGEND

- - 1.050" Iron Pipe Found
- - 1.900" Iron Pipe Found
- - 3/4" Iron Bar Found
- - Calculated Point (not monumented)
- (...) - Recorded as values

KEVIN & LISA TADYCH
DOC NBR 514298
LOT 1 OF CSM NBR 002464

S 88°23'49" E 1023.71' (N 88°23'49" W 1023.84')
928.63'

JOHN & JUNE THIESEN
DOC NBR 619093
PART OF GOV'T LOT 2

Easement
20' Wide

N 89°03'35" E
223.90'

N 86°37'26" E
115.47'

N 80°18'40" E
152.82'

N 74°24'42" E
75.20'

N 69°51'26" E
144.80'

N 83°29'40" E
90.34'

N 74°08'14" E
49.93'

N 17°18'57" E
73.53'

(S 17°18'20" W)
(73.61')

95.08' N 23°36'30" W

70.79'

S 20°08'05" E

78.67'

Cul-De-Sac
30' Radius

LAKE

KATHERINE

NAP # ✓ A 3328
DATE FILED 11/13/17
BY UMHO
DECISION ✓
ONEIDA CO. SURVEYOR'S OFFICE

CURVE	ARC LENGTH	RADIUS	DELTA ANGLE	CHORD BEARING	CHORD LENGTH
C1	15.08'	1758.24'	0°29'29"	N 32°59'24" W	15.08'
C2	252.02'	1758.24'	8°12'45"	N 28°38'17" W	251.80'
C3	267.10'	1758.24'	8°42'14"	N 28°53'01" W	266.84'

CENTERLINE DESCRIPTION FOR 20' WIDE EASEMENT

Part of Government Lot 2, Section 10, Township 38 North, Range 6 East, Town of Hazelhurst, Oneida County, Wisconsin as shown on a survey map by McMullen & Associates, Incorporated of Minocqua, Wisconsin dated the 2 day of September, 2017 with a job number of 217041 and more particularly described as follows:

Commencing at the north 1/4 corner of said section marked by an Oneida County Aluminum Monument; thence South 29°45'29" East (Assumed North based on the south line of Certified Survey Map number 002464 recorded at the Oneida County Register of Deeds office which bears South 88°23'49" East) for a distance of 2,480.04 feet to the easterly right-of-way of U.S. Highway "51" marked by a 1.050" iron pipe; thence along said right-of-way along the arc of a curve to the left with a long chord of South 28°38'17" East, 251.80 feet, a radius of 1758.24 feet, and a delta angle of 8°12'45" for a distance of 252.02 feet to a point, said point being the first POINT OF BEGINNING of this centerline description.

Thence leaving said right-of-way and along the centerline of said easement the following courses: North 86°37'26" East, 115.47 feet to a point; North 80°18'40" East, 152.82 feet to a point; North 89°03'35" East, 223.90 feet to a point; North 74°24'42" East, 75.20 feet to a point; North 69°51'26" East, 144.80 feet to a point; North 74°08'14" East, 49.93 feet to a point; North 83°29'40" East, 90.34 feet to a point (said point is the center of a cul-de-sac with a 30' radius); North 23°36'30" West, 70.79 feet to a point on the south line of said Certified Survey Map, the first POINT OF ENDING.

thence again from said cul-de-sac center point, said point being the second POINT OF BEGINNING of this centerline description, South 20°08'05" East for a distance of 78.67 feet to a point, the second POINT OF ENDING.

Subject to any easements, restrictions, or rights of way of record or of use.

The right-of-way lines of this 20' wide easement are intended to be extended to and terminate at the right-of-way line of U.S. Highway 51 and to be extended to and terminate at the south line of said Certified Survey Map.

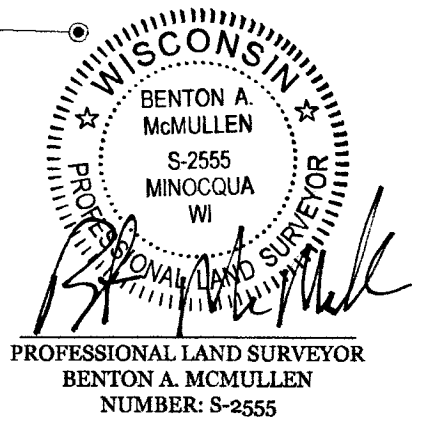

MCMULLEN & ASSOCIATES, INCORPORATED
"Your true north surveyors and soil testers"
PO BOX 51, MINOCQUA, WISCONSIN 54548
TELEPHONE (715) 356-3011

"TADYCH SURVEY"

DRAFTED BY: Benton A. McMullen	DATE: September 2, 2017
SCALE: 1" = 100'	JOB NBR: 217041
	SHEET 1 OF 1 SHEETS

September 6, 2017

CENTERLINE DESCRIPTION FOR 20' WIDE EASEMENT

Part of Government Lot 2, Section 10, Township 38 North, Range 6 East, Town of Hazelhurst, Oneida County, Wisconsin as shown on a survey map by McMullen & Associates, Incorporated of Minocqua, Wisconsin dated the 2 day of September, 2017 with a job number of 217041 and more particularly described as follows:

Commencing at the north 1/4 corner of said section marked by an Oneida County Aluminum Monument; thence South 29°45'29" East (Assumed North based on the south line of Certified Survey Map number 002464 recorded at the Oneida County Register of Deeds office which bears South 88°23'49" East) for a distance of 2,480.04 feet to the easterly right-of-way of U.S. Highway "51" marked by a 1.050" iron pipe; thence along said right-of-way along the arc of a curve to the left with a long chord of South 28°38'17" East, 251.80 feet, a radius of 1758.24 feet, and a delta angle of 8°12'45" for a distance of 252.02 feet to a point, said point being the first POINT OF BEGINNING of this centerline description.

Thence leaving said right-of-way and along the centerline of said easement the following courses: North 86°37'26" East, 115.47 feet to a point; North 80°18'40" East, 152.82 feet to a point; North 89°03'35" East, 223.90 feet to a point; North 74°24'42" East, 75.20 feet to a point; North 69°51'26" East, 144.80 feet to a point; North 74°08'14" East, 49.93 feet to a point; North 83°29'40" East, 90.34 feet to a point (said point is the center of a cul-de-sac with a 30' radius); North 23°36'30" West, 70.79 feet to a point on the south line of said Certified Survey Map, the first POINT OF ENDING.

Thence again from said cul-de-sac center point, said point being the second POINT OF BEGINNING of this centerline description, South 20°08'05" East for a distance of 78.67 feet to a point, the second POINT OF ENDING.

Subject to any easements, restrictions, or rights of way of record or of use.

The right-of-way lines of this 20' wide easement are intended to be extended to and terminate at the right-of-way line of U.S. Highway 51 and to be extended to and terminate at the south line of said Certified Survey Map.

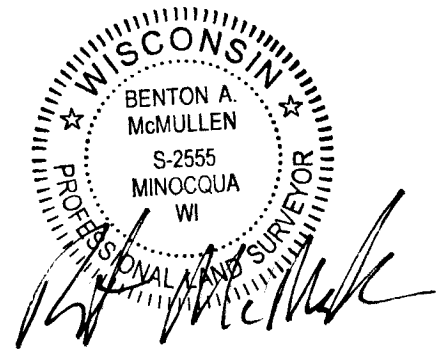

Professional Land Surveyor
No. 2555
Benton A. McMullen
Date: September 6, 2017