

MAP # **A 3330**
 DATE **11/3/17**
 REVISION **MM**
 ONEIDA CO. SURVEYOR'S OFFICE

A 3330

Part of
GOVERNMENT LOT 9
SECTION 7, TOWNSHIP 39 NORTH, RANGE 5 EAST
 Town of Minocqua
 Oneida County, Wisconsin

SURVEYOR'S CERTIFICATE
 I, Benton A. McMullen, Wisconsin Professional Land Surveyor # S-2555, do hereby certify that I have surveyed and mapped the property shown hereon, and that I have complied with the applicable requirement of the Wisconsin Administrative Code Chapter A-E 7, and that this map represents a true and accurate survey of said property to the best of my knowledge and belief.

This survey was performed under the order of: Ron Schinker

- LEGEND**
- - 1.315" Iron Pipe Found
 - ⊙ - 1.660" Iron Pipe Found
 - - 1.900" Iron Pipe Found
 - ⊕ - Calculated Point (not monumented)
 - ▭ - Septic Tank
 - ⊙ - Sewer Vent
 - (...) - Recorded as values

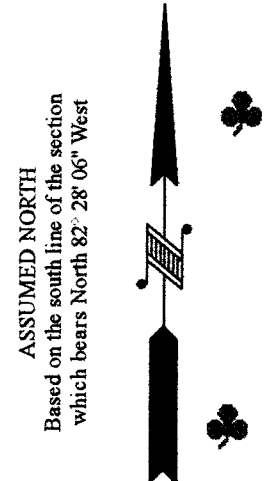
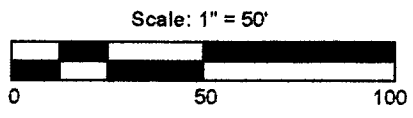

- NOTES**
- 1) IRON PIPE DIAMETERS GIVEN ARE OUTSIDE DIAMETERS.
 - 2) IT IS NOT THE INTENT OF THIS SURVEY MAP TO SHOW ALL EASEMENTS.

DIAMOND SHORE ROAD
 60' Wide per Volume 272 on Page 148
 Location per centerline on a previous preliminary survey by McMullen & Associates, Inc. dated December 12, 2013.

FIELD SURVEY WORK COMPLETED ON
 THE 18th DAY OF October, 2017

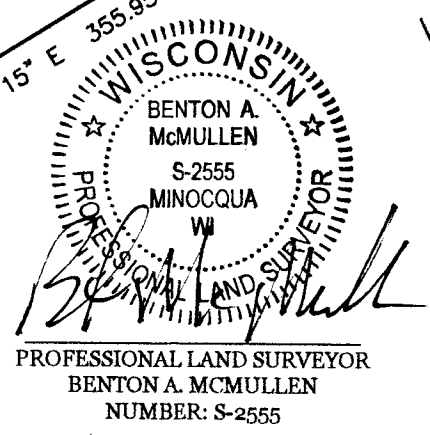

MEANDER CORNER
 Oneida County Aluminum Monument
 Found in Place

O.H.W.M. (Ordinary High Water Mark)
 (for reference only)
 O.H.W.M. IS APPROXIMATE

ANY LAND BELOW THE O.H.W.M. OF A LAKE OR NAVIGABLE STREAM IS SUBJECT TO THE PUBLIC TRUST IN NAVIGABLE WATERS THAT IS ESTABLISHED UNDER ARTICLE IX, SECTION 1 OF THE STATE CONSTITUTION.

EXTERIOR DESCRIPTION

Part of Government Lot 9, Section 7, Township 39 North, Range 5 East, Town of Minocqua, Oneida County, Wisconsin as shown on a survey map by McMullen & Associates, Incorporated of Minocqua, Wisconsin dated the 3rd day of November, 2017 with a job number of 217043 and previously described in document number 484412 as recorded at the Oneida County Register of Deeds office and more particularly described as follows:

Commencing at southwest section corner of said section marked by a brass capped iron pipe; thence North 85°23'09" East (Assumed north based on the south line of said section which bears North 82°28'06" West) for a distance of 2,108.95 feet to a 1.315" iron pipe, said point being the POINT OF BEGINNING.

Thence North 34°05'09" East for a distance of 311.10 feet to a 1.900" iron pipe near the shore of Diamond Lake; thence meandering along said shore South 86°48'06" East for a distance of 100.00 feet to a point and South 58°25'03" East for a distance of 150.00 feet to a 1.315" iron pipe; thence leaving said shore South 58°20'15" West for a distance of 355.95 feet to a 1.315" iron pipe; thence North 82°19'55" West for a distance of 99.90 feet to the point of beginning.

Including all those lands lying between the above described meander line and the water's edge of Diamond Lake.

Said described tract having an area of 59,132 square feet or 1.36 acres, more or less.

Subject to any easements, restrictions, or rights of way of record or of use and subject to the right of way of Diamond Shore Road.

MCMULLEN & ASSOCIATES, INCORPORATED "Your true north surveyors and soil testers" PO BOX 51, MINOCQUA, WISCONSIN 54548 TELEPHONE (715) 356-3011		
"SCHINKER SURVEY"		
DRAFTED BY: Benton A. McMullen	DATE: November 3, 2017	
SCALE: 1" = 50'	JOB NBR: 217043	SHEET 1 OF 1 SHEETS

A 3330

A 3330