

MAP # A3419
 8/29/18
 R.H.
 ONEIDA COUNTY SURVEYORS ASSOCIATION

Forest Lane

(A=265.00')
 A=264.36' R=793.15'

N 79°18'04"E 263.14'
 (N 79°43'36.5"E 263.77')

Oneida County Grid North

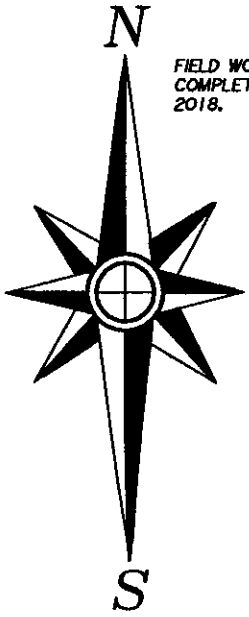

FIELD WORK WAS
 COMPLETED ON MAY 16th,
 2018.

Lot 84
 8968 Forest Lane
 Parcel MI 5161
 Document No. 558593
 86,500±Sq.Ft.
 1.99±Acres

Lot 83

N 16°03'12"W 418.44'
 (N 15°44'00"W 418.30')

septic vent



septic tank

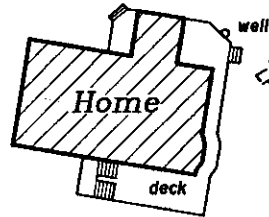

well



S 04°31'00"W 516.54'
 (S 5°15'24"W 516.35')

Lot 85

Lot 84 of Forest Green II Plat
 Located in
Gov't. Lot 2 and the NW1/4-SE1/4
Section 6, T 39 N, R 5 E
 Town of Minocqua
 Oneida County, Wisconsin

Scale: 1" = 50'



-Surveyor's Certificate-

"I HEREBY CERTIFY, THAT I HAVE SURVEYED AND MAPPED THE LANDS SHOWN HEREON AND THAT, TO THE BEST OF MY KNOWLEDGE AND BELIEF, THIS SURVEY AND MAP IS A TRUE AND CORRECT REPRESENTATION THEREOF, AND THAT I HAVE COMPLIED WITH THE APPLICABLE REQUIREMENTS OF CHAPTER A-E 7 OF THE WISCONSIN ADMINISTRATIVE CODE'S MINIMUM STANDARDS FOR PROPERTY SURVEYS."

DATED THIS 18th DAY OF MAY, 2018.

Thomas A. Boettcher
 THOMAS A. BOETTCHER, P.L.S. 1763

Booth
Lake

-Legend-

- ⊙ 2" IRON PIPE FOUND IN PLACE
- 1" IRON PIPE FOUND IN PLACE
- () BEARING & DISTANCE OF RECORD

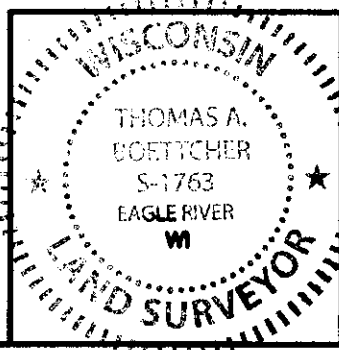

Survey For
Jason & Stephanie Jarstad
 5900 Greenleaf Blvd.
 Racine, WI 53406-4612

SCALE: 1" = 50' DATE: 5/18/2018 DWN. BY: TAB

Drawing No. **E4269** Eagle Landmark Surveying Inc.
 5035 Hwy. 70 West, Eagle River, WI 54521
 P&F (715)479-9610 survey@eaglelandmark.com