

Part of the
 Northeast 1/4 of the Southwest 1/4
 and part of
 Government Lot 3
 SECTION 13, TOWNSHIP 39 NORTH, RANGE 7 EAST
 Town of Woodruff
 Oneida County, Wisconsin

Quarter Corner
 Oneida County Aluminum
 Monument
 Found in place

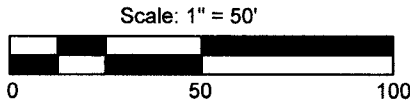

NOTES

- 1) IRON PIPE DIAMETERS GIVEN ARE OUTSIDE DIAMETERS.
- 2) IT IS NOT THE INTENT OF THIS SURVEY MAP TO SHOW ALL EASEMENTS.

33' Wide Easement

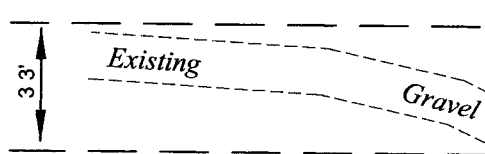

EXTERIOR DESCRIPTION

Part of the Northeast 1/4 of the Southwest 1/4 and part of Government Lot 3, Section 13, Township 39 North, Range 7 East, Town of Woodruff, Oneida County, Wisconsin as shown on a survey map by McMullen & Associates, Incorporated of Minocqua, Wisconsin dated the 15th day of October, 2018 with a job number of 218045 and previously described in document number 627548 as recorded at the Oneida County Register of Deeds office and more particularly described as follows:

Commencing at the quarter corner common to sections 12 and 13 marked by an Oneida County aluminum monument; thence along the north-south 1/4 line South 00°53'15" East (grid north, based on the Oneida County coordinate system referenced to said north-south 1/4 line) for a distance of 3,767.20 feet to a 3/4" iron bar, said point being the POINT OF BEGINNING.

Thence continuing along said 1/4 line South 00°53'15" East for a distance of 287.17 feet to a meander corner near the northerly shore of Gilmore Lake marked by a W.C.D. brass capped iron pipe; thence meandering along said lake North 87°38'49" West for a distance of 104.96 feet to a 2.375" iron pipe; thence leaving said meander line North 09°44'01" West for a distance of 288.64 feet to a 1.050" iron pipe; thence South 89°21'39" East for a distance of 149.23 feet to the point of beginning.

Including all those lands lying between the above described meander line and the water's edge of Gilmore Lake.

Said described tract having an area of 37,753 square feet or 0.87 acres, more or less.

Subject to any easements, restrictions, or rights of way of record or of use.

Together with easements as described in said document number 627548.



PROFESSIONAL LAND SURVEYOR
 BENTON A. MCMULLEN
 NUMBER: S-2555

SURVEYOR'S CERTIFICATE

I, Benton A. McMullen, Wisconsin Professional Land Surveyor # S-2555, do hereby certify that I have surveyed and mapped the property shown hereon, and that I have complied with the applicable requirement of the Wisconsin Administrative Code Chapter A-E 7, and that this map represents a true and accurate survey of said property to the best of my knowledge and belief.

This survey was performed under the order of: Cynthia Petersohn

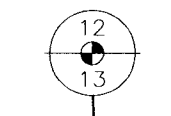

NORTH - SOUTH 1/4 LINE

3767.20'

S 00°53'15" E 4054.37'

(S 01°06' E)

287.17'

Gilmore Lake

S 89°21'39" E 150.08'
 (S 89°49' E 150.0')

149.23'

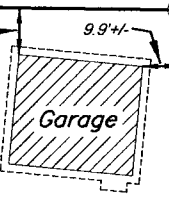

Garage

S 89°21'39" E 0.85'

N 09°44'01" W 288.64'
 (N 10°06' W 288.8')

Approx. Line NE 1/4 - SW 1/4 Gov't Lot 3

CSM No. 3183

N 87°38'49" W 104.96'
 (N 88°03' W 105.0')

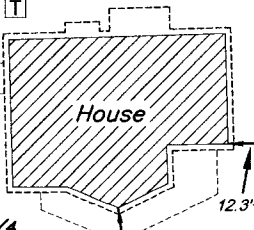

House

Lawn Edge Land Scaping Area

Meander Corner
 W.C.D. Brass Capped Iron Pipe
 Found in place

LEGEND

- - 1.050" Iron Pipe Found
- ⊙ - 2.375" Iron Pipe Found
- ⊖ - 3/4" Iron Bar Set
- ⊕ - Well
- ⊞ - Septic Tank
- ⊗ - Sewer Vent
- ⊞ - Electric Box
- (...) - Recorded as values

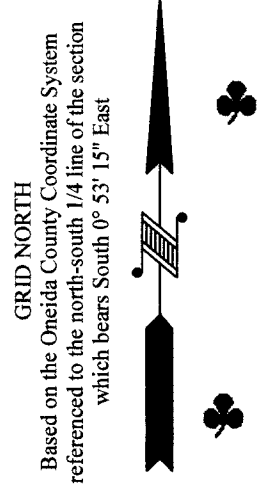

MAP # A 3467 ✓
 DATE FILED 12-31-18
 BY SC
 DESCRIBED BY
 ONEIDA CO. SURVEYOR'S OFFICE

O.H.W.M. (Ordinary High Water Mark)
 (for reference only)
 O.H.W.M. IS APPROXIMATE

ANY LAND BELOW THE O.H.W.M. OF A LAKE OR NAVIGABLE STREAM IS SUBJECT TO THE PUBLIC TRUST IN NAVIGABLE WATERS THAT IS ESTABLISHED UNDER ARTICLE IX, SECTION 1 OF THE STATE CONSTITUTION.

FIELD SURVEY WORK COMPLETED ON
 THE 5th DAY OF October, 2018

MCMULLEN & ASSOCIATES, INCORPORATED
 "Your true north surveyors and soil testers"
 PO BOX 51, MINOCQUA, WISCONSIN 54548
 TELEPHONE (715) 356-3011

"PETERSOHN SURVEY"

DRAFTED BY: Benton A. McMullen	DATE: October 15, 2018
SCALE: 1" = 50'	JOB NBR: 218045
SHEET 1 OF 1 SHEETS	