

REVISED
Part of
GOVERNMENT LOTS 2 & 5
SECTION 11, TOWNSHIP 39 NORTH, RANGE 6 EAST
Town of Minocqua
Oneida County, Wisconsin

MAP # A346B ✓
DATE FILED 12.31.18
BY SC
DESCRIBE ✓
ONEIDA CO. SURVEYOR'S OFFICE

Section Corner
Aluminum Monument
Found in place

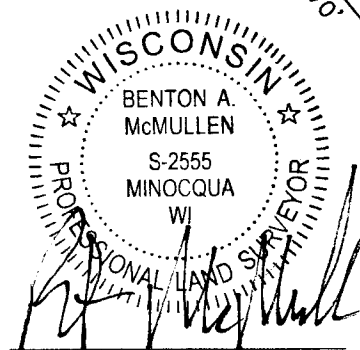

PROFESSIONAL LAND SURVEYOR
BENTON A. McMULLEN
NUMBER: S-2555
Revised: See note on sheet 2

OLD HIGHWAY "70" ROAD

SHOWN AS
"EASEMENT DRIVEWAY"
ON SURVEY MAP B6091

BLACKTOP
DRIVEWAY

- LEGEND**
- - 3/4" Iron Bar Set
 - - 1.660" Iron Pipe Found
 - ⊙ - 1.660" Iron Pipe Set
 - ⊗ - Utility Pole
 - ⊕ - Water Valve
 - ⊖ - Man Hole Cover
 - (...) - Recorded as values
 - ▨ - Existing Structure

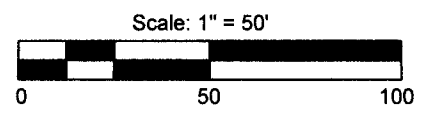

SUBSURFACE
SEWER / WATER
LINES

S 44°35'58" E (N 44°32' W)
109.97' (110')

GOV'T. LOT 2

APPROXIMATE EAST-WEST QUARTER LINE

ABOVE GROUND
UTILITY LINES

O.H.W.M.
(See Sheet 2)

20' WIDE EASEMENT
DESCRIBED IN
VOLUME 260 ON PAGE 270
DOCUMENT No. 197918

N 25°27'00" E
289.39' (289.5')

88.11'

57.58'

N 51°49'27" W
145.00' (145)

S 17°48'37" W (S 18°04' W)
286.35' (304.1')

GOV'T. LOT 5

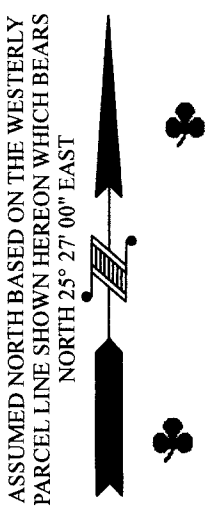

FIELD SURVEY WORK COMPLETED ON
THE 5th DAY OF June, 2015

MINOCQUA
LAKE

MCMULLEN & ASSOCIATES, INCORPORATED
 "Your true north surveyors and soil testers"
 PO BOX 51, MINOCQUA, WISCONSIN 54548
 TELEPHONE (715) 356-3011

"OWEN SURVEY"
 PART OF GOVERNMENT LOTS 2 & 5
 SECTION 11, TOWNSHIP 39 NORTH, RANGE 6 EAST
 Town of Minocqua, Oneida County, Wisconsin

DRAFTED BY: Benton A. McMullen
 DATE: July 27, 2015
 SCALE: 1" = 50'
 JOB NBR: 215022
 SHEET 1 OF 2 SHEETS

A346B

REVISED
Part of
GOVERNMENT LOTS 2 & 5
SECTION 11, TOWNSHIP 39 NORTH, RANGE 6 EAST
Town of Minocqua
Oneida County, Wisconsin

A346B ✓
12-31-18
SC ✓

DESCRIPTION

Part of Government Lots 2 and 5, Section 11, Township 39 North, Range 06 East, Town of Minocqua, Oneida County, Wisconsin as shown on a survey map by McMullen & Associates, Incorporated of Minocqua, Wisconsin dated the 27th day of July, 2015 with a job number of 215022 and more particularly described as follows:

Commencing at the northwest section corner of said section marked by an aluminum monument; thence South 39°10'37" East (Assumed north based on the westerly line of the parcel described herein which bears North 25°27'00" East) for a distance of 3,278.70 feet to a 1.660" iron pipe, said point being the POINT OF BEGINNING.

Thence South 44°35'58" East for a distance of 109.97 feet to a 1.660" iron pipe; thence South 17°48'37" West for a distance of 286.35 feet to a 1.660" iron pipe near the shore of Minocqua Lake; thence meandering along said lake shore North 51°49'27" West for a distance of 145.00 feet to a 1.660" iron pipe; thence leaving said lake shore North 25°27'00" East for a distance of 289.39 feet to the POINT OF BEGINNING.

Together with an easement for ingress and egress which is 25 feet wide as described in Volume 119 on Page 514.

Subject to an easement for sewer and water mains which is 20' wide as described in Volume 260 on Page 270 and shown on said survey map.

Subject to any easements, restrictions, or rights of way of record or of use.

Including all those lands lying between the above described meander line and the water's edge of Minocqua Lake.

*O.H.W.M. (Ordinary High Water Mark)
(for reference only)
O.H.W.M. IS APPROXIMATE*

ANY LAND BELOW THE O.H.W.M. OF A LAKE OR NAVIGABLE STREAM IS SUBJECT TO THE PUBLIC TRUST IN NAVIGABLE WATERS THAT IS ESTABLISHED UNDER ARTICLE IX, SECTION 1 OF THE STATE CONSTITUTION.

NOTES

- 1) IRON PIPE DIAMETERS GIVEN ARE OUTSIDE DIAMETERS.
- 2) IT IS NOT THE INTENT OF THIS SURVEY MAP TO SHOW ALL EASEMENTS.

SURVEYOR'S CERTIFICATE

I, Benton A. McMullen, Wisconsin Professional Land Surveyor # S-2555, do hereby certify that I have surveyed and mapped the property shown hereon, and that I have complied with the applicable requirement of the Wisconsin Administrative Code Chapter A-E 7, and that this map represents a true and accurate survey of said property to the best of my knowledge and belief.

This survey was performed under the order of: LINDA OWEN

REVISED: Job Number 219002 -
November 2, 2018
Field work completed on the 22nd
day of August, 2018.
Remarked the side parcel lines
and set monuments along the west
parcel line.

PROFESSIONAL LAND SURVEYOR
BENTON A. MCMULLEN
NUMBER: S-2555
Revised: see note on sheet 2

**MCMULLEN & ASSOCIATES,
INCORPORATED**
"Your true north surveyors and soil testers"
PO BOX 51, MINOCQUA, WISCONSIN 54548
TELEPHONE (715) 356-3011

"OWEN SURVEY"
PART OF GOVERNMENT LOTS 2 & 5
SECTION 11, TOWNSHIP 39 NORTH, RANGE 6 EAST
Town of Minocqua, Oneida County, Wisconsin

DRAFTED BY: Benton A. McMullen
DATE: July 27, 2015
SCALE: 1" = 50'
JOB NBR: 215022
SHEET 2 OF 2 SHEETS

A346B

A346B