

Part of  
**GOV'T LOT 2 IN SECTION 16**  
 and part of  
**GOV'T LOT 2 IN SECTION 17**  
**All in T36N, R8E,**  
 Town of Crescent, Oneida County, Wisconsin

**LEGEND**

- ⊙ = 0.75" x 24" Rebar Set with 2" Aluminum Cap
- = 1.0" Iron Pipe Found
- = 1.25" Iron Pipe Found
- ⊗ = 1.50" Iron Pipe Found
- = 2.5" Iron Pipe Found
- △ = Computed Position
- ( ) = Recorded Dimension

Monument sizes are outside diameter.  
 Other corner monuments are as noted.



Bearings Oneida Co. grid  
 referenced to the West line  
 of the Gov't Lot 2, Section  
 16, bearing S0°42'51"W.

SCALE: 1" = 100'



**Doc. #745480**

Part of Gov't Lot 2 in Section 16 and part of Gov't Lot 2 in Section 17, all in Township 36 North, Range 8 East, Town of Crescent, Oneida County, Wisconsin, more particularly described as follows:

Commencing at the Quarter Corner between Sections 16 and 17, marked by a capped iron pipe, thence N86°34'47"E, a distance of 37.50 feet to the point of beginning as described in Doc. #745480, marked by an iron pipe, said point is also a point on the meander line of Green Bass Lake.

Thence N88°02'23"E, along said meander line, a distance of 192.99 feet to a rebar; thence S47°27'08"E, along said meander line, a distance of 52.33 feet to an iron pipe; thence S43°41'50"W, along the south line of Doc. #745480, a distance of 231.61 feet to the easterly right of way of Green Bass Road, marked by a rebar; thence along the arc of a curve, concave southwesterly a distance of 151.01 feet along said easterly right of way to a rebar, said arc has a radius of 737.61 feet, a delta of 11°43'49", and a chord that bears N65°13'53"W, a distance of 153.41 feet; thence along the arc, concave northeasterly, a distance of 185.29 feet along said easterly right of way to a rebar, said arc has a radius of 312.70 feet, a delta of 33°57'05", and a chord that bears N54°25'08"W, a distance of 179.85 feet; thence N37°23'47"W, along said easterly right of way of Green Bass Road, a distance of 154.14 feet to the easterly right of way of S. Rifle Road, marked by a rebar; thence N10°43'01"W, along said easterly right of way, a distance of 86.82 feet to a rebar; thence along an arc of a curve, concave easterly, a distance of 100.35 feet along said easterly right of way to the north line of Doc. #745480, marked by a rebar, said arc has a radius of 284.34 feet, a delta of 20°13'19", and a chord that bears N0°36'13"W, a distance of 110.18 feet; thence S80°05'19"E, along said north line of Doc. #745480, a distance of 308.89 feet to the meander line of Green Bass Lake, marked by an iron pipe; thence S3°50'52"W, along said meander line, a distance of 164.56 feet to a rebar; thence S26°45'52"E, along said meander line, a distance of 70.46 feet to the place of beginning.

Including all lands between the above described meander line of Green Bass Lake and the water's edge.

That portion described contains 2.99 acres, more or less.

**SURVEYOR'S CERTIFICATE**

I, Emily K. Pierce, Professional Land Surveyor No. S-2728, hereby certify that I have surveyed the property shown hereon; that this map represents an accurate survey of said property to the best of my knowledge and belief; that I have performed this survey by order of Lamar and Karne Newburn; and that I have complied with the requirements of Wisconsin Administrative Code A-E 7.

STEIGERWALDT LAND SURVEYING, LLC

*Emily K. Pierce*

Professional Land Surveyor No. S-2728  
 Dated May 28, 2019  
 Field work completed on May 24, 2019

MAP #	A3499 ✓
DATE FILED	6-4-2019
BY	SC
DESCRIPTION	
ONEIDA CO. SURVEYOR'S OFFICE	

**STEIGERWALDT LAND SURVEYING, LLC**

856 NORTH 4TH STREET, TOMAHAWK, WI 54487  
 PHONE #: (715) 453-3274 FAX #: (715) 453-8325  
 www.steigerwaldt.com

JOB #: 6191	DWG #: 6191 Newburn	Sheet 1 of 1
-------------	---------------------	--------------

**DETAIL**  
(not to scale)

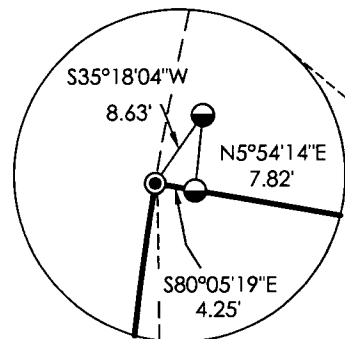

**MEANDER CORNER**

2" Brass Capped  
 Iron Pipe



**QUARTER CORNER**

2" Brass Capped  
 Iron Pipe

