

A3624

**PART OF THE NW 1/4 OF THE SE 1/4 & GOV'T. LOT 4, SEC. 15, T. 38 N., R. 7 E., TOWN OF LAKE TOMAHAWK, ONEIDA COUNTY, WI.**

MAP # A3624 ✓  
DATE 6-29-2020  
BY SC  
ONEIDA CO. SURVEYING OFFICE

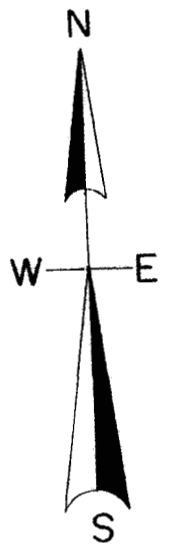

North is referenced to the West line of the Southeast 1/4 being an assumed bearing of N 0° 10' 53" E.

**NORTH TWO LAKES**

C 1/4  
found 2" iron pipe  
(N 88° 55' E 200.0')

**DOC. #717161**  
**±0.761 ACRES**  
**±33,187 SQ. FT.**  
Taken to existing shoreline

**LEGEND**

- subdivisational monument
- found 1.5" iron pipe
- found 1" iron pipe
- found 3/4" iron pipe
- set 1" iron pipe
- △ computed position
- (0.0') bearing & distance of record

**SCALE**  
1" = 50'

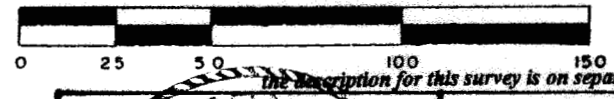

I, Todd Loftus, Professional Land Surveyor, hereby certify, that I have surveyed the property shown hereon. That this map represents an accurate survey of said property to the best of my knowledge & belief. That I have performed this survey by order of Barbara Spinzig and that I have complied with the applicable requirements of the Wisconsin Administrative Code A.E. 7.

DATE June 3, 2020  
SIGNED Todd Loftus

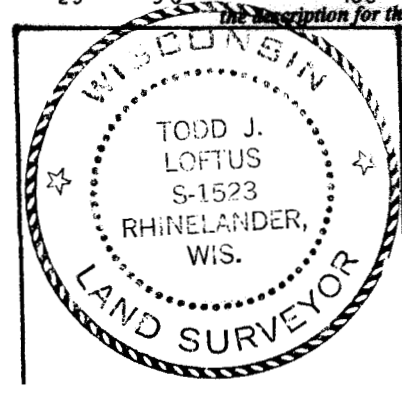

survey for **Barbara D. Spinzig**  
6552 Cardinal LN.  
Lake Tomahawk, WI. 54539  
**LOFTUS SURVEYING**  
860 BALSAM STREET  
RHINELANDER, WI. 54501  
TEL/FAX 715-369-1142  
[hodag28@hotmail.com](mailto:hodag28@hotmail.com)

**2060B7**

A3624

A3624

found capped 2" aluminum monument

N 0° 10' 53" E 2623.26'

495.86'

(S 0° 05' W 495.9')

(N 88° 55' E 200.0')

(S 0° 07' W 34.1')

original shoreline  
(120' more or less)  
N 53° 07' 00" E 9.40'  
(N 53° 07' E 9.4')

original shoreline  
(140' more or less)  
S 52° 54' 32" W 109.80'  
existing shoreline  
S 57° 56' 24" W 106.68'

altered shoreline  
S 38° 48' 14" W 125.00'  
(S 38° 20' W 125.0')

N 16° 24' 42" W 354.80'

344.80'  
(N 16° 30' W 354.8')

S 16° 12' 00" E 349.89'  
(S 16° 15' E 350.4')

N 55° 47' 00" E 100.00'  
(N 55° 47' E 100.00')

N 55° 50' 57" E 69.18'  
(N 55° 47' E 69.3')

N 55° 47' 00" E 382.11'

N 56° 06' 07" E 80.48'  
(N 55° 47' E 86.2.6')

2127.40'

S 1/4 COR.