

**WEST LINE of the
WEST HALF of the
SW 1/4 of the SE 1/4
SECTION 29, T37N, R6E,
Town of Cassian
Oneida County, Wisconsin**

SURVEYOR'S CERTIFICATE

I, John M. Jursa, Professional Land Surveyor No. S-3201, hereby certify that I have surveyed the property shown hereon; that this map represents an accurate survey of said property to the best of my knowledge and belief; that I have performed this survey by order of Pat Elsner; and that I have complied with the requirements of Wisconsin Administrative Code A-E 7.
STEIGERWALDT LAND SURVEYING, LLC

(Signature)
Professional Land Surveyor No. S-3201
Dated this October 21, 2020
Field work completed on July 13, 2020

LINE SURVEY

A line survey between parcels described in Doc. #769200 and #514915, as recorded in the Oneida County Register of Deeds, being the West Line of the SW 1/4 of the SE 1/4, Section 29, Township 37 North, Range 6 East, Town of Cassian, Oneida County, Wisconsin, more particularly described as follows:

Beginning at the South Quarter Corner of Section 29, marked by an Oneida County Monument, thence N0°52'43"W, along the N-S 1/4 Line, a distance of 1335.53 feet to the Center-South Sixteenth Corner, marked by an iron rod, being the point of termination.

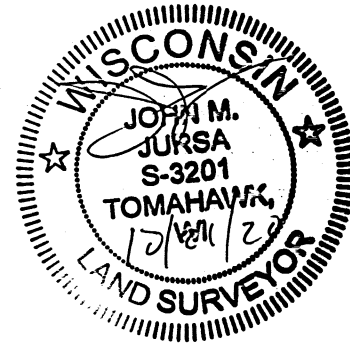

Bearings Oneida Co. grid
referenced to the West line of the
Southeast Quarter, Section 29,
bearing N0°52'43"W.

SCALE: 1" = 200'



LEGEND

○ = Wood Lathe Set

Monument sizes are outside diameter.
Other corner monuments are as noted.

STEIGERWALDT LAND SURVEYING, LLC

856 NORTH 4TH STREET, TOMAHAWK, WI 54487
PHONE #: (715) 453-3274 FAX #: (715) 453-8325
www.steigerwaldt.com

JOB #: 6659

DWG #: 6659 Elsner

Sheet 1 of 1

**NORTH QUARTER
CORNER**
Found 2" Aluminum
Pipe with cap



N0° 52' 43"W
2616.34'

**CENTER OF
SECTION**
Computed Position



**WEST QUARTER
CORNER**
Found 1.5" Iron Pipe

N89° 42' 41"E
2643.60'

N89° 42' 41"E
2557.54'

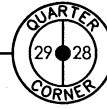

**EAST QUARTER
CORNER**
Found 2" Aluminum
Pipe with cap

2670.89'
1335.36'

**CENTER-SOUTH
SIXTEENTH CORNER**
Found 0.75" Rebar

676.69'

**SE 1/4 of the SW 1/4
Doc. #514915**

**W 1/2 of the
SW 1/4 of the SE 1/4
Doc. #769200**

N0° 52' 43"W
64.51' 1335.53'

79.47'

44.45'

72.52'

56.85'

53.03'

159.98'

128.03'

**SOUTH QUARTER
CORNER**
Found 3.25" Oneida
County Aluminum
Monument



MAP #	A3703 ✓
DATE	1/12/2021
BY	JJP
DEED	
ONEIDA CO. SURVEYOR'S OFFICE	