

A3715

BEARING BASIS OF RECORD

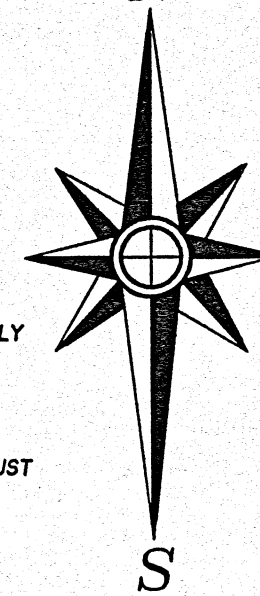

Being
Lot 8 of the Forestwood Acres Plat
located in the
NE 1/4 of the SW 1/4
Section 6, T 39 N, R 7 E
Town of Woodruff, Oneida County, WI.

MAP # A3715 ✓
DATE FILED 1/22/2021
BY HP
DESCRIBED
ONEIDA CO. SURVEYOR'S OFFICE

BEARINGS ARE BASED ON THE WESTERLY RIGHT-OF-WAY LINE OF FORESTWOOD LANE WHICH BEARS S 1°33'00"W AS BEING OF RECORD.

FIELD WORK WAS COMPLETED ON AUGUST 26TH, 2020.

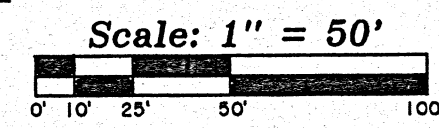

-Surveyor's Certificate-

"I HEREBY CERTIFY, THAT I HAVE SURVEYED AND MAPPED THE LANDS SHOWN HEREON AND THAT, TO THE BEST OF MY KNOWLEDGE AND BELIEF, THIS SURVEY AND MAP IS A TRUE AND CORRECT REPRESENTATION THEREOF, AND THAT I HAVE COMPLIED WITH THE APPLICABLE REQUIREMENTS OF CHAPTER A-E 7 OF THE WISCONSIN ADMINISTRATIVE CODE'S MINIMUM STANDARDS FOR PROPERTY SURVEYS." DATED THIS 12th DAY OF JANUARY, 2021.

Thomas A. Boettcher
THOMAS A. BOETTCHER, P.L.S. No. 1763.

-Legend-

- 3/4" DIA. IRON ROD FOUND IN PLACE
- 1" DIA. IRON PIPE SET THIS SURVEY
- () BEARING & DISTANCE OF RECORD

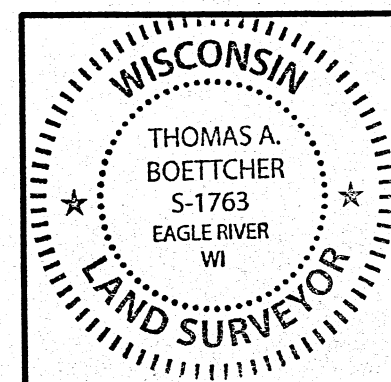

Survey For
Jeff & Sandra Supinski
8993 Forestwood Lane
Woodruff, Wisconsin 54568

SCALE: 1" = 50' DATE: 1-12-2021 DWN. BY: K.W.S

Drawing No. **E4570** Eagle Landmark Surveying Inc.
5035 Hwy. 70 West, Eagle River, WI 54521
P&F (715)479-9610 survey@eaglelandmark.com

(N 0°57'5"E 160.00')
N 00°56'50"E 160.02'

Septic vent pipe

-8-
8993 Forestwood Lane
Parcel WR-1638
53,028 SQ.FT.
1.22 ACRES

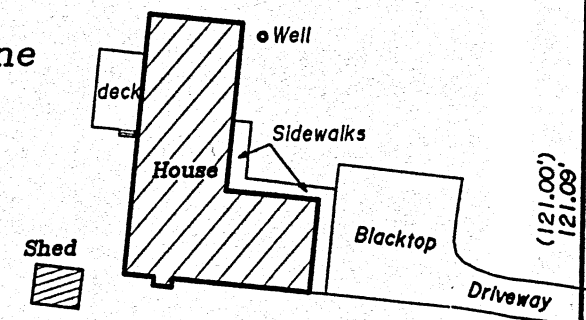

N 82°38'50"W 378.73'
(N 82°34.3'W 379.02')

Neighbor's shed is 0.20' over the lot line.
Eave of neighbor's shed is over the lot line.

(121.00')
121.09'

S 01°33'00"W 241.18'
(S 1°33.0'W 241.00')

(120.00')
120.09'

Forestwood
6' 6'
(Private Road)
(Outlot 1)

-23-

A3715

A3715