

A3718

A3718

Sugar Camp
Lake

Being a part of
Gov't. Lot 5 of Section 12
and also part of the
NW 1/4 of the NE 1/4 of Section 13
Town of Sugar Camp, Oneida County, WI.

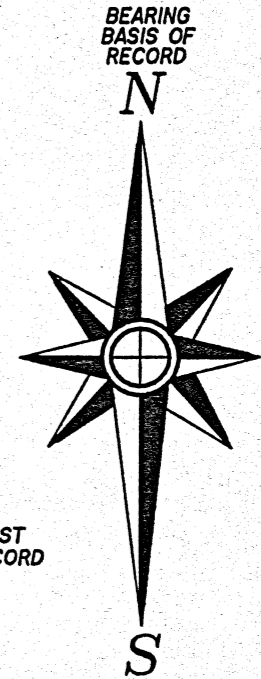

Scale: 1" = 60'
0' 10' 25' 50' 100'

BEARINGS ARE BASED ON THE WEST
LINE OF THIS PARCEL WITH A RECORD
BEARING OF N 0°32'00"W.

FIELD WORK WAS COMPLETED ON
NOVEMBER 12th, 2020.

SU-148-4
Doc. No. 646534

3792 Cty. "A"
Parcel SU-148-1
97,980±Sq.Ft.
2.25±Acres

SU-148-5
Vol. 961 P. 302

MAP # **A3718** ✓
DATE FILED **1/22/2021**
BY **HP**
ONEIDA CO. SURVEYOR'S OFFICE

-Legend-

- ⊕ 1-1/4" DIA. IRON PIPE FOUND IN PLACE
- 1" DIA. IRON PIPE FOUND IN PLACE
- ⊙ SURVEY SPIKE SET THIS SURVEY
- △ COMPUTED POSITION
- () BEARING & DISTANCE OF RECORD

Section
Corner

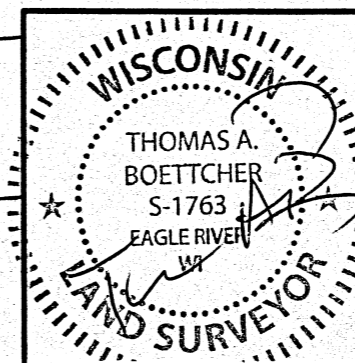

Site Plan For
Jon & Kathleen Brandt
644 S. Jackson Street
Green Bay, Wisconsin 54301

SCALE: 1" = 60' DATE: 1/7/2021 DWN. BY: K.W.S

Drawing No. **E4600** Eagle Landmark Surveying Inc.
5035 Hwy. 70 West, Eagle River, WI 54521
P&F (715)479-9610 survey@eaglelandmark.com

A3718

A3718