

A3722

A3722

# Lot 1 of Certified Survey Map # 698, being part of Gov't Lot 3, Section 25, Township 37 North, Range 9 East, Town of Pine Lake, Oneida County, Wisconsin

Bearings referenced to the South line of Gov't. Lot 3  
Previously recorded as S 89°31'35" W

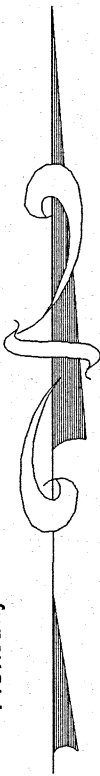

(150.00)  
150.09'  
N 00°23'20" W  
(N 0°28'25" W)

Doc. #800527

(N 89°31'35" E, 344.47')  
(N 89°33'33" E, 344.71')

212.19'

122.40'

10.12'

## Lot 1 1.16 acres 50393 sq ft including Town road R/W

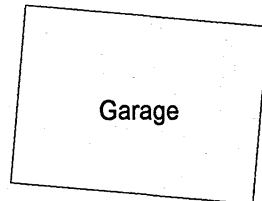
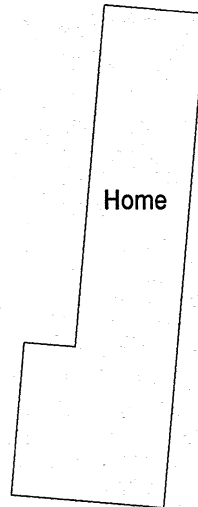

Lakeshore Dr. (Moens Lake Dr.)

66'

(S 8°23'57" W, 85.82')  
(S 8°14'25" W, 86.35')  
(S 08°23'57" W, 86.55')  
(S 3°42'14" E, 64.65')  
(S 03°16'48" E, 64.55')

Doc. #800527

W 1/4 Corner  
Section 25  
Found Brass Cap Mon.

(417.37')  
417.40'

Gov't Lot 3

257.67'

(67.25')  
67.24'

425.57'

S 89°31'35" W

S 89°31'35" W, 334.78' (335.00')

S 89°31'35" W

Gov't Lot 4

MC on Moen Lk.  
Found 1.5" Iron Pipe

Lot 1  
CSM #2560

SCALE  
1" = 30'

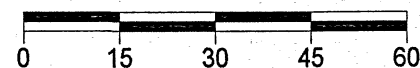

### LEGEND

- Found 1" Iron Pipe
- ⊙ Found 3/4" Iron Rod
- ⊕ Found 2" IP
- △ Calculated Position
- ⊙ Found PLS Corner Monument as described
- ( ) Previously recorded as

MAP # **A3722**

DATE FILED **2/11/21**

BY **HP**

DESCRIBED

ONEIDA CO. SURVEYOR'S OFFICE

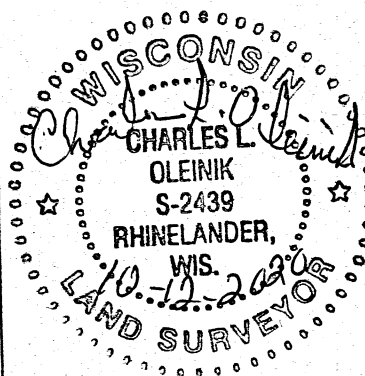

I, Charles L. Oleinik, Professional Land Surveyor in the State of Wisconsin, hereby certify: that I have surveyed and mapped the parcel shown hereon; that said survey and map are correct to the best of my knowledge and belief; that I have complied with the applicable requirements of Chapter A-E 7 of Wisconsin Administrative Code in completion thereof.

*Charles L. Oleinik*

**10-12-2020**

Charles L. Oleinik, PLS

Date

NORTH COAST SURVEYING  
1715 MELODY LANE  
RHINELANDER, WI 54501  
715-490-0892  
NORTHCOASTSURVEYING.COM

Boundary Survey for:

**Kathy Handt**

Drawing #	Date	Drafted by
2032	10/12/2020	CLO

A3722

A3722