

Oneida County Grid

Legend:  
 ○ 1" dia. iron pipe set  
 ⊗ 1" dia. iron pipe found  
 ( ) Bearing or distance of record

Scale 1" = 50'

SCALE:	1" = 50'
JOB #:	2022048
DRAWN BY:	JWD
DATE:	03/09/2022

SHEET 1 OF 1

CLIENT: Maines and Associates

Part of the South line of Lot 3  
 of the County Plat of Kobart Kove  
 Government Lot 4  
 Section 8, T 39 N, R 5 E  
 Town of Minocqua  
 Oneida County, Wisconsin

MAP # A3921  
 DATE FILED 03-04-2022  
 BY MF  
 DESCRIPTION FILED  
 ONEIDA CO. SURVEYOR'S OFFICE

Arbor Vitae, WI 54668  
 Phone 715.356.9485  
 Eagle River, WI 54521  
 Phone 715.479.2570  
 mainesandassociates.com



**Notes:**

- The purpose of this survey is to monument the south line of Lot 3 east of Kobart Road in accordance with the location shown on the recorded plat of Kobart Kove prepared by Maines and Associates. Monuments were found along this line that were inconsistent with the location shown on the plat. It appears these monuments were either moved or set in error.
- Fieldwork was completed on March 3, 2022.

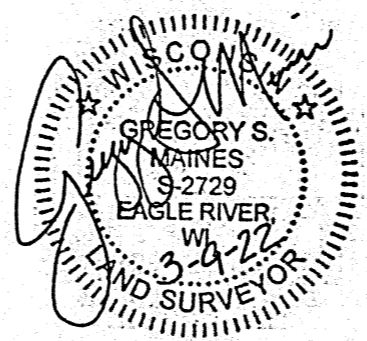

**Surveyors Certificate**

I hereby certify that I have surveyed the property line shown hereon; that this map represents an accurate survey of said property line to the best of my knowledge and belief; and that I have complied with the applicable requirements of the Wisconsin Administrative Code Section A-E 7.