

Lot 11
of the recorded plat of
SAND LAKE SUBDIVISION
being part of
GOV'T. LOT 6
SECTION 5, T37N, R7E

Town of Cassian
Oneida County, Wisconsin

Bearings Oneida County Grid,
based on GPS survey data,
referenced to the north line
of Lot 11 of Sand Lake Subdivision,
bearing N 89°38'37"E.

SURVEYOR'S CERTIFICATE

I, James D. Rein, Professional Land Surveyor No. S-1234, hereby certify that I have surveyed the property shown hereon; that this map represents an accurate survey of said property to the best of my knowledge and belief; that I have performed this survey by order of John Fischer; and that I have complied with the requirements of Wisconsin Administrative Code A-E 7.

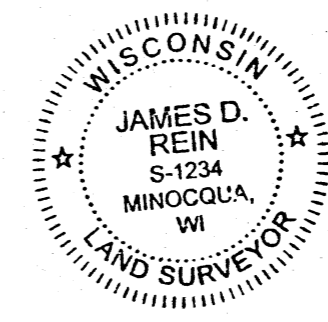

WILDERNESS SURVEYING, INC.

James D. Rein
Professional Land Surveyor No. S-1234
Dated this 5th day of August, 2022

Field survey was completed on August 3, 2022.

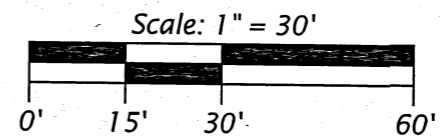

LEGEND

- = 2.0" dia. iron pipe found in place
 - () = previously recorded bearing and distance
- Monument sizes are outside diameter dimensions.

MAP #	A 3938 ✓
DATE FILED	9-30-22
BY	CH
DESCRIPTION	FILED
ONEIDA CO. SURVEYOR'S OFFICE	

WILDERNESS SURVEYING, INC.
Post Office Box 1111 - 8793 Earls Court
Minocqua, Wisconsin 54548
Tel. (715) 356-5100
www.wildernesssurveying.com

Map No.: 22 - 96
File No.: 12 - 5 - 377
Drafted by: S. Wruk Silva