

Section 20 21  
Corner 29 28

MAP # A3958  
DATE FILED 10-17-2022  
BY CH  
DESCRIPTION FILED  
ONEIDA CO. SURVEYOR'S OFFICE

Being a part of  
**Gov't. Lot 4**  
**Section 28, T 38 N, R 11 E**  
Town of Three lakes, Oneida County, Wisconsin

Scale: 1" = 60'  
0' 10' 25' 50' 100'

BEARINGS ARE BASED ON THE SOUTH  
R/W LINE OF PINWOOD ROAD WHICH  
BEARS N 82°53'43"E AS BEING OF  
RECORD FROM PREVIOUS DEEDS & SURVEYS.  
FIELD WORK WAS COMPLETED ON AUGUST  
2nd, 2022.

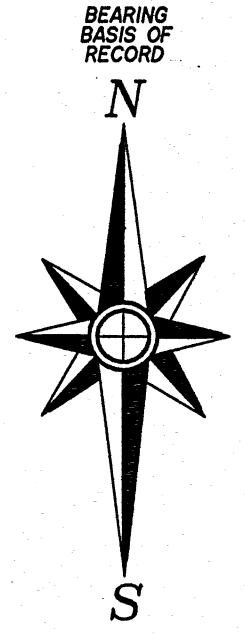

Richmond Road  
Line  
50'  
366.86'  
(366.90')

Pinewood Road  
9'

"Morley & Aiossa"  
TL-737-15  
1205 Pinewood Road  
69,290± SQ.FT.  
1.59± ACRES

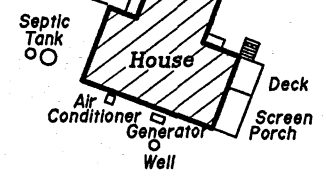

Section 20 21  
Richmond Road  
S 1°38'00"W 1658.84'  
S 01°38'18"W 1699.03'  
N 00°26'46"E 85.01'  
(9.03')  
9.13'  
N 0°23'08"E 84.98'  
1292.17'  
(1291.94')

(N 82°53'43"E 463.15')  
(N 82°53'43"E 463.25')  
454.13'  
(454.12')

(S 7°14'41"E) 26.26'  
(26.26')  
(N 84°58'02"E 85.0')  
(N 84°02'50"E 84.72')

(S 77°21'22"E 152.32')  
(S 76°52'01"E 152.62')

S 85°28'25"W 516.81'  
(S 85°28'17"W 516.77')

(N 54°36'22"W 146.76')  
(N 54°33'40"W 146.68')

(S 02°25'51"E 50.55')  
(50.55')

Big  
Lake

-Legend-

- ONEIDA COUNTY ALUMINUM CAPPED MONUMENT FOUND IN PLACE
- ⊕ 1-1/2" IRON PIPE FOUND IN PLACE
- 1" IRON PIPE FOUND IN PLACE
- △ COMPUTED ANGLE POINT
- ( ) BEARING & DISTANCE OF RECORD

-Surveyor's Certificate-

"I HEREBY CERTIFY, THAT I HAVE SURVEYED AND MAPPED THE LANDS SHOWN HEREON AND THAT, TO THE BEST OF MY KNOWLEDGE AND BELIEF, THIS SURVEY AND MAP IS A TRUE AND CORRECT REPRESENTATION THEREOF, AND THAT I HAVE COMPLIED WITH THE APPLICABLE REQUIREMENTS OF CHAPTER A-E 7 OF THE WISCONSIN ADMINISTRATIVE CODE'S MINIMUM STANDARDS FOR PROPERTY SURVEYS." DATED THIS 3rd DAY OF AUGUST, 2022.

*Kip W. Soder*  
KIP W. SODER, P.L.S. No. 1731

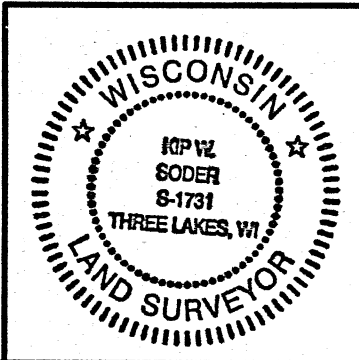

Survey For:  
**Francis Morley**  
**April Aiossa**  
700 S. Knight Avenue  
Park Ridge, IL. 60068

SCALE: 1" = 60' DATE: 8-3-2022 DWN. BY: K.W.S

Drawing No. **E4793** Eagle Landmark Surveying Inc.  
5035 Hwy. 70 West, Eagle River, WI 54521  
P&F (715)479-9610 survey@eaglelandmark.com