

Part of the SE 1/4 of the NE 1/4, Section 33, Township 36 North, Range 8 East, Town Of Crescent, Oneida County, Wisconsin

NE/NE

SE/NE

**Lot 1
34.95 acres
1522575 sq ft**

Bearings grid, Referenced to the Oneida County Coordinate System

NE Corner
Section 33
found survey nail
fitting ties

West 1/4 corner
Section 33
found Alum. Mon.

old wire
fence

1/16
Corner

East 1/4 corner
Section 33
Found 1 1/2"
Iron Pipe

MAP # **A3969**
DATE FILED **10-20-2022**
BY **CH**
DESCRIPTION FILED
ONEIDA CO. SURVEYOR'S OFFICE

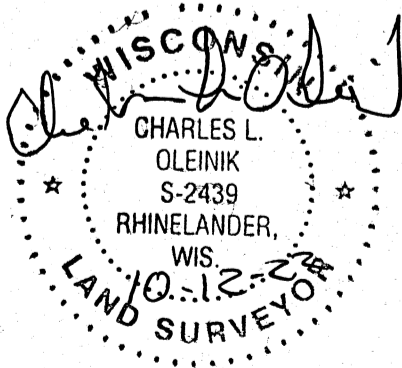

LEGEND

- Set 1" X 24" Iron Pipe Weighing min. 1.13 lb./lin.ft.
- 1" Iron Pipe previously set
- × Found angle iron
- ⊕ Found 1 1/2" Iron Pipe
- ⊙ Survey nail previously set
- △ Calculated Position
- Found PLS Corner Monument as described

SCALE

1" = 200'

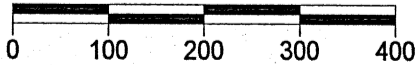

I, Charles L. Oleinik, Professional Land Surveyor in the State of Wisconsin, hereby certify: that I have surveyed and mapped the parcel shown hereon; that said survey and map are correct to the best of my knowledge and belief; that I have complied with the applicable requirements of Chapter A-E 7 of Wisconsin Administrative Code in completion thereof.

Charles L. Oleinik **10-12-22**
Charles L. Oleinik, PLS Date

NORTH COAST SURVEYING
1715 MELODY LANE
RHINELANDER, WI 54501
715-490-0892
NORTHCOASTSURVEYING.COM

Boundary Survey for:
**Jerry and Donna
Baker**

Drawing # 2242 Date 10/12/2022 Drafted by CLO

A3969

A3969

A3969

A3969