

MAP # **A3988**
 DATE FILED **12-12-2022**
 BY **CH**
 DESCRIPTION FILED
 ONEIDA CO. SURVEYOR'S OFFICE

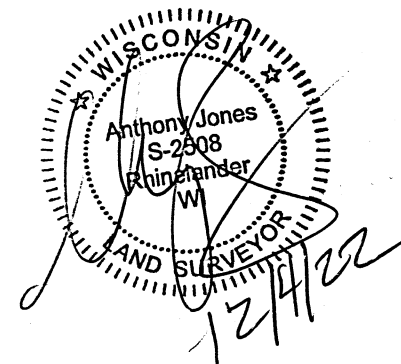

I, ANTHONY R. JONES, WISCONSIN PROFESSIONAL LAND SURVEYOR No. S-2508, DO HEREBY CERTIFY THAT I HAVE MADE THIS SURVEY UNDER THE DIRECTION OF DALE GERDES, OWNER, THAT THIS MAP, IN MY OPINION, IS A TRUE AND CORRECT REPRESENTATION OF THAT SURVEY AND THAT I HAVE COMPLIED WITH THE PROVISIONS OF CHAPTER AE-7 OF THE WISCONSIN ADMINISTRATIVE CODE, THE ONEIDA COUNTY SUBDIVISION ORDINANCES AND THE TOWN OF NEWBOLD SUBDIVISION ORDINANCES.

NW CORNER, 26-37-08
 SET 3 1/4" SURVEY SPIKE
 PER PUBLISHED ONEIDA
 COUNTY COORDINATES
 AND EXISTING WITNESSES

NW 1/16
 (BY OTHERS)

DOC. No.
784772

DOC. No.
486209

FOUND 1 1/4"
 IRON PIPE
 N 04°08'54" E 0.60'

FOUND PK NAIL
 (N 1/16 BY
 OTHERS)

12' WIDE
 GRAVEL ROAD

N 86°39'08" E 704.81'
 (N 81°45'12" E 704.81')

27.50'
 (27.40')

GERDES TO RAPPLEY
5.90 ACRES

THIS PARCEL IS TO BE COMBINED WITH THOSE
 LANDS TO THE NORTH, DESCRIBED IN DOC. No.
 486209 AND MAY NOT BE RE-SUBDIVIDED OR
 SOLD WITHOUT THE APPROVAL OF THE
 ONEIDA COUNTY ZONING DEPARTMENT

DOC. No.
800113

WEST 1/4 TO NW CORNER
 N 03°43'09" E 2776.96'
 (N 01°10'30" W 2776.52')
 (N 3°59'11" E 2777.06')

DOC. No.
784661

N 03°43'23" E 366.61'
 (N 1°10'30" E 366.61')

EAST LINE - SW/NW
 WEST LINE - SE/NW
 S 04°08'54" W 699.76'
 (S 0°44'59" E 699.80')

670.01'
 (N 81°57'33' E 670.00')

POINT OF
 BEGINNING
 N 86°51'29" E 1371.75'

701.74'

FOUND 1" IRON PIPE
 WITH YELLOW
 WILDERNESS
 SURVEYING CAP

LEGEND

- SET 1 1/4" X 18 INCH IRON PIPE
- FOUND 1" IRON PIPE
- ⊙ FOUND 1 1/4" IRON PIPE
- ⊗ FOUND 2 1/2" IRON PIPE
- △ CALCULATED LOCATION
- (XXX) RECORDED DIMENSION



NORTH BASED ON THE ONEIDA
 COUNTY COORDINATE SYSTEM
 AND THE WEST LINE OF THE
 NORTHWEST 1/4, MEASURED AS:
 S 03°43'09" E

GERDES-REMAINDER
 DOC No. 433166
 10.02 ACRES

CW 1/16
 (BY OTHERS)

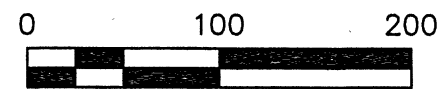

A.R. JONES
 LAND SURVEYING, LLC
 2788 SCHWARZ RD.
 RHINELANDER, WI 54501
 715.894.7231
 arjsurvey@charter.net

WEST 1/4 CORNER, 26-37-08
 SET 3 1/4" SURVEY SPIKE
 PER PUBLISHED ONEIDA
 COUNTY COORDINATES
 AND EXISTING WITNESSES

1332.28' (1332.30')
 S 86°51'23" W 1369.24'
 (S 81°57'33" W 1369.26')
 (N 87°07'07" E 1369.30')

Exempt from Planning and Zoning Review.
 Signature *[Signature]* Date **12/7/2022**

DESCRIPTION PROVIDED ON A SEPARATE SHEET

DRAWN BY: ARJ	DATE: 12/4/2022	DALE AND HELEN GERDES 1996 LARSEN DR. RHINELANDER, WI 54501 SITE PIN: NE-256-3
FIELD WORK COMPLETED ON:	DATE: 12/4/2022	
SCALE: 1"=100'	SHEET: 1/1	PROJECT NUMBER: 2022-127

PART OF THE SOUTHWEST 1/4 OF THE
 NORTHWEST 1/4 OF SECTION 26,
 TOWNSHIP 37 NORTH, RANGE 8 EAST,
 TOWN OF NEWBOLD, ONEIDA COUNTY,
 WISCONSIN