

**PART OF THE SW 1/4 OF THE NW 1/4, SEC. 27,
T. 36 N., R. 9 E., TOWN OF PELICAN,
ONEIDA COUNTY, WI.**

MAP # **A4007**
DATE FILED **2-16-2023**
BY **CH**
DESCRIPTION FILED
ONEIDA CO. SURVEYOR'S OFFICE

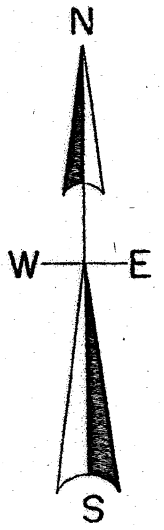

North is referenced to the West line
of the NW 1/4, being an assumed
bearing of N 0° 23' 34" E.

**REMAINDER
23.565 ACRES**

Parcel -A- is to be attached to lands to the South
as described in Document #795415 and not to be
sold as a separate entity.

**PARCEL -A-
0.375 ACRES
16,350 SQ. FT.**



DOCUMENT # 795415

16.04 ACRES

Exempt from Planning and Zoning Review.
[Signature] 2/14/2023
Signature Date

21 22
28 27
SEC. COR.
capped iron pipe
66'
FOREST DRIVE
N 0° 23' 34" E 2702.68'
S 0° 35' 45" W 526.39'
W 1/4 COR.
railroad spike
33.00'

S 66° 27' 36" E 284.09'
N 0° 35' 45" E 125.00'

262.00'

S 87° 28' 38" W 662.48'

400.48'

(S 87° 28' 38" W 665.91')

1/16 LINE

(N 0° 18' 43" E 526.25')

C-W 1/16
1.5" iron pipe

E-W 1/4 LINE

(N 87° 28' 38" E 1364.01')

(1331.01')

LEGEND

- ⊙ subdivisinal monument of record
- found 5/8" iron rod
- set 1" iron pipe
- △ computed position
- (0.00') bearing & distance of record
measured outside diameter

SCALE

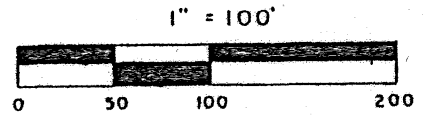

I, Todd Loftus, Professional Land Surveyor, hereby certify,
that I have surveyed the property shown hereon. That this
map represents an accurate survey of said property to the
best of my knowledge & belief. That I have performed this
survey by order of Gladys Fritz
and that I have complied with the applicable requirements
of the Wisconsin Administrative Code A.E.7.

DATE Feb. 2, 2023

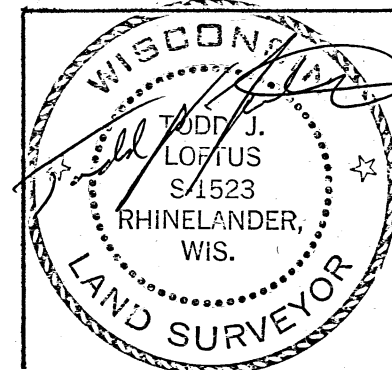

survey for Gladys Fritz
2470 Bergman Road
Rhinelander, WI. 54501

LOFTUS SURVEYING
5437 RIVERVIEW DRIVE
RHINELANDER, WI. 54501
TEL/FAX 715-369-1142
hodag28@hotmail.com

3071B7