

- ⊖ 1 3/4" dia. iron pipe found
- △ Computed position
- ⊖ 3/4" dia. iron pipe found
- ⊗ 1" dia. iron pipe found
- 1-1/4" dia. iron pipe found
- () Bearing or distance of record

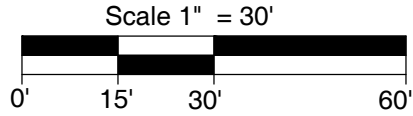

Record Legal Description:

Lot Three (3) of the FIRST ADDITION TO GLENCOE SUBDIVISION, Woodruff Township, Oneida County, Wisconsin, according to the recorded Plat thereof.

ALSO Outlots Four (4) and Five (5) of the Certified Survey Map prepared by Foltz & Associates, Inc., surveyor of part of Government Lot 2 of Section 33, Township 39 North, Range 7 East of the Fourth Principal Meridian, Woodruff Township, Oneida County, Wisconsin, recorded October 20, 1995 in Volume 7 of Survey Maps on page 1780.

MAP #	A4016	✓
DATE FILED:	4-25-2023	
BY:	CH	
DESCRIPTION FILED:		
ONEIDA CO. SURVEYOR'S OFFICE		

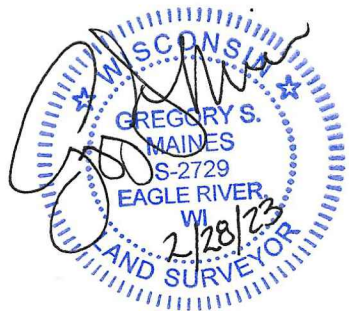

Surveyors Certificate

I hereby certify that I have surveyed the property shown hereon; that this map represents an accurate survey of said property to the best of my knowledge and belief; and that I have complied with the applicable requirements of the Wisconsin Administrative Code Section A-E 7.

Notes:

- This survey was done without the benefit of a title commitment, there may or may not be easements of record that benefit or burden the subject property.
- Fieldwork was completed on September 23, 2021.

2530 Highway 70 West
Eagle River, WI 54521
Phone 715.479.2570

1573 Highway 51 North
Arbor Vitae, WI 54568
Phone 715.356.9485
mainesandassociates.com

Lot 3 of the First Addition To Glencoe Subdivision
and Part of Vacated Road in Doc. No 829147 all Being part of
Government Lot 2
Section 33, T 39 N, R 7 E
Town of Woodruff
Oneida County, Wisconsin

CLIENT:

Wes & Kelley
Huggett

SCALE:	1" = 30'
JOB #:	2021171
DRAWN BY:	CJH
DATE:	02/28/2023
SHEET 1 OF 1	