

PLAT OF SURVEY

LOT TWO, ONEIDA COUNTY CERTIFIED SURVEY MAP
No. 2899, LOCATED IN THE NW 1/4-SW 1/4, SECTION 13,
TOWNSHIP 36 NORTH, RANGE 7 EAST, TOWN OF
WOODBORO, ONEIDA COUNTY, WISCONSIN

SURVEYOR'S CERTIFICATE

I, ANTHONY R. JONES, WISCONSIN PROFESSIONAL LAND
SURVEYOR No. S-2508, DO HEREBY CERTIFY THAT I HAVE
MADE THIS SURVEY UNDER THE DIRECTION OF JOSHUA
JOHNSON, OWNER, THAT THIS MAP, IN MY OPINION, IS A
TRUE AND CORRECT REPRESENTATION OF THAT SURVEY
AND THAT I HAVE COMPLIED WITH THE PROVISIONS OF
CHAPTER AE-7 OF THE WISCONSIN ADMINISTRATIVE CODE.

SURVEYOR'S NOTES:

- THIS SURVEY WAS DONE WITH SNOW ON THE GROUND. THERE MAY BE ENCROACHMENTS AFFECTING THIS PARCEL THAT WERE NOT EVIDENT, DUE TO THE SNOW COVER.
- THIS SURVEY WAS DONE WITHOUT A TITLE POLICY. THERE MAY BE BURDENS OR BENEFITS THAT AFFECT THIS PARCEL THAT ARE NOT SHOWN HERE.
- ONEIDA COUNTY CERTIFIED SURVEY MAP (CSM) No. 2899 SHOWS THAT THIS PARCEL IS AFFECTED BY A 1200 FOOT LAND FILL SETBACK. USE THE CSM TO RE-ESTABLISH THAT SETBACK LINE, IF NECESSARY.
- THE WETLANDS, AS REPRESENTED HERE, ARE APPROXIMATE. IF A WETLAND DELINEATION IS REQUIRED FOR BUILDING SETBACKS OR OTHER PURPOSES, PLEASE CONTACT THE APPROPRIATE AGENCY. ONLY THE NORTHERN EDGE OF THE WETLANDS WERE LOCATED, AS THAT IS WERE THE BUILDING SITE WILL BE. THE SOUTHERN EDGE HAS BEEN SCALED FROM THE ONEIDA COUNTY GIS AND IS ONLY SHOWN FOR REFERENCE. NO FILLING OF THE WETLANDS UNLESS PROPER PERMITS ARE OBTAINED.
- WOOD LATH WAS SET ON THE NORTH, EAST AND WEST LOT LINES, AT THE REQUEST OF THE OWNER.

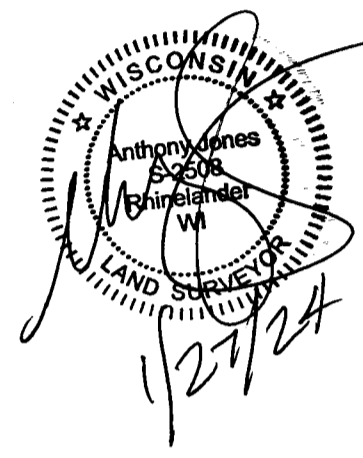

LUBER LANE

S 86°40'54" E 197.20'
(S 86°40'54" E 197.21')

LOT 2

C.S.M. No. 2899
DOC. No. 842348
110,075 SQ. FT.
(incl. wetlands)

N 01°28'51" E 549.96'
(S 01°26'06" W 549.73')

S 00°47'47" W 549.47'
(S 00°45'26" W 549.43')

-LOT 1-
C.S.M. 2899

-LOT 1-
C.S.M. 2546

N 86°53'20" W 203.74'
(S 86°50'18" W 203.70')

N 88°35'38" W 16.97'
(S 86°50'18" W 16.32')

N 86°44'09" W 186.96'
(S 86°50'18" W 187.38')

-LOT 7-
C.S.M. 2554

-LOT 8-
C.S.M. 2546

NORTH BASED ON THE NORTH
LINE OF LOT 1, C.S.M. No 2899,
RECORDED AS: S 86°40'54" E

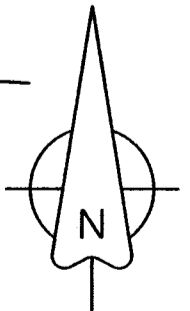
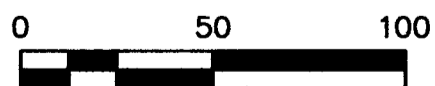

MAP # **A4155**
 DATE FILED **2-7-2024**
 BY **CH**
 DESCRIPTION FILED
 ONEIDA CO. SURVEYOR'S OFFICE

LEGEND

- FOUND 3/4" IRON ROD
- × SET WOOD LATH, ON LINE
- (XXX) RECORD DIMENSIONS

DRAWN BY: ARJ	DATE: 1/27/2024	JOSH JOHNSON 7541 LUBER LANE RHINELANDER, WI 54501 PIN: WB-188-14	A.R. JONES LAND SURVEYING, LLC 2788 SCHWARZ RD. RHINELANDER, WI 54501 715.894.7231 arjsurvey@charter.net
FIELD WORK COMPLETED ON:	DATE: 1/27/2024	PROJECT NUMBER: 2024-002	
SCALE: 1"=50'	SHEET: 1/1		